

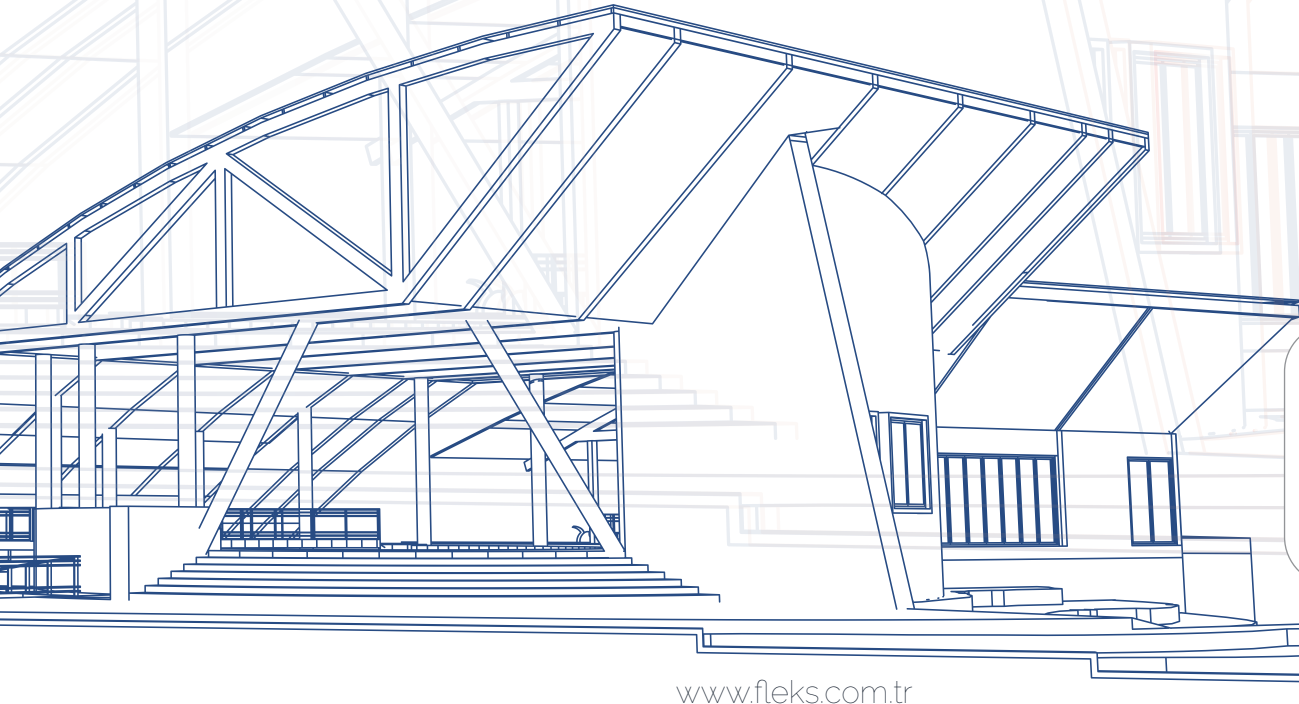

**KABLO KORUMA VE TAŞIMA SİSTEMLERİ**  
CABLE PROTECTION AND MANAGEMENT SYSTEMS

**2024**  
**ÜRÜN KATALOĞU**  
PRODUCT CATALOGUE



Online Katalog



[www.fleks.com.tr](http://www.fleks.com.tr)



## HAKKIMIZDA

Fleks şirketi ticari faaliyetine 2019 yılında başlamış olsa da, ardında sektörde oldukça uzun yıllardan beri yer almakta olan, deneyimli bir yönetim kadrosu barındırmaktadır. Fleks Elektrik, İzoleli-İzolesiz Çelik Spiral,Ağır Hizmet Tipi Çelik Spiral ile başlayarak kablo muhafaza alanında elektrik tesisat borularını üretmek üzere kurulmuştur. Bu üç ana ürün kaleminin dışında elektrik tesisat malzemesi üretim faaliyetlerimiz aksesuarlara kadar uzanarak artan ürün çeşitliliği ile İstanbul,Esenyurt'ta konuşlandırılmış fabrikamızda devam etmektedir.

Türkiye'de birçok üstyapı ve altyapı projelerine ürün tedarik etmekte, yurt dışındaki (Balkanlar, Orta Doğu,Afrika ülkeleri) birçok müşterimize taleplerine uygun özelliklerde ürünleri ihraç etmekteyiz.

Misyonumuz kaliteli standartlarda ürün üretmek, ürün çeşitliliğimizi arttırmak, müşterilerimize kaliteli ürün,hizmet ve doğru terminler sunmak, hepsi birer aile üyesi gibi olan çalışanlarımızın beceri ve yeteneklerine katkılı olup,uzmanlık seviyelerini arttırmak böylece hem iç hem dış müşteri memnuniyetini sağlamak, karşılıklı güven ve işbirliği içerisinde büyümemizi sürdürmektir.

Vizyonumuz üretim imkanlarımızı ve kapasitemizi daha da arttırmak, iç ve dış piyasa gereksinimlerinin takibinde daha da büyüyerek dünyaya açılmaktır. Vizyonumuzu her geçen gün biraz daha genişletmek için var gücümüzle ve var olan imkanlarımızla çalışmaktayız.

## ABOUT US

Although Fleks company started its commercial activities in 2019, it has an experienced management team that has been in the industry for many years. Fleks Elektrik was established to produce electrical installation pipes in the field of cable protection, starting with Insulated-Non-Insulated Steel Spiral and Heavy Duty Liquid Tight Steel Spiral. Apart from these three main product items, our electrical installation material production activities continue in our factory which is located in Istanbul, Esenyurt, with an increasing product variety, extending to accessories.

We supply products to many superstructure and infrastructure projects in Turkey and export products with features that meet their demands to many of our customers abroad (Balkans, Middle East and African countries).

Our mission is to produce products in accordance with quality standards, increase our product diversity, provide quality products, services and accurate deadlines to our business partners, contribute to the skills and abilities of our employees, all of whom are like family members, and increase their level of expertise, thus ensuring both internal and external customer satisfaction, continue to grow in mutual trust and cooperation.

Our vision is to further increase our production opportunities and capacity, to expand further in pursuit of domestic and foreign market requirements and globalise. We are working with all our strength and available resources to expand our vision a little more every day.



# INDEX



GALVANISED STEEL FLEXIBLE CONDUITS	01
PVC INSULATED GALVANISED STEEL FLEXIBLE CONDUITS	02
STAINLESS STEEL FLEXIBLE CONDUITS	03
LSZH / LSOH COATED FLEXIBLE STEEL CONDUITS	04
LSOH COATED LIQUID TIGHT CONDUITS & PVC COATED LIQUID TIGHT CONDUITS	05
GALVANISED STEEL CORE, GALVANIZED STEEL OVER BRAID & GALVANISED STEEL CORE, STAINLESS STEEL OVERBRAID	06
GALVANISED STEEL CORE, PVC COATED, GALVANISED STEEL OVERBRAID	07
GALVANISED STEEL CORE, PVC COATED, LIQUID TIGHT, GALVANISED STEEL OVERBRAID	07
CONNECTORS	08 - 10
<b>STANDARD TYPE METAL CABLE GLANDS</b>	11
<b>EX UNARMoured CABLE GLANDS</b>	13 - 14
<b>POLYAMIDE CABLE GLANDS</b>	15 - 16
<b>EMT GALVANIZED THREADLESS STEEL CONDUIT &amp; ACCESSORIES</b>	17 - 23
<b>CABLE LUNGS</b>	24 - 25
<b>BUSBARS</b>	26
<b>CLAMPS &amp; CABLE TIES</b>	28 - 32
<b>ABS AND POLYCARBONATE BOXES, S.M. &amp; F.M. FUSE BOXES</b>	33
ABS ENCLOSURES	34
JUNCTION BOXES	35 - 36
SEALED BOXES	37
MENHOLES	38
DISTRIBUTION BOARDS (FUSE BOXES)	39
DISTRIBUTION BOARDS IP65 ACQUA SERIES(MADE IN SPAIN)	40 - 41
INDUSTRIAL SOCKET BOXES	42
DECORATIVE VENTILATORS	43
<b>POLYESTER DISTRIBUTION BOARDS</b>	44
<b>CABLE TRUNKINGS</b>	46
PVC CABLE TRUNKINGS	47
PVC CABLE TRUNKING WITH ADHESIVE TAPE	48
SLOTTED TYPE(DUCT) CABLE TRUNKINGS	49
OVERFLOOR PVC CABLE TRUNKINGS	50
<b>PLASTIC CONDUITS &amp; ACCESSORIES</b>	51
RIGID PVC CONDUITS & ACCESSORIES	52 - 56
CORRUGATED POLYAMIDE PLASTIC CONDUITS AND FITTINGS	57 - 63
PLASTIC SPIRAL PIPES	64
PLASTIC SPIRAL PIPES WITH GUIDE WIRE	65
POLYETHYLENE & HALOGEN FREE COIL PIPES & ACCESSORIES	66 - 67
<b>CABLE REELS</b>	68
PLASTIC CABLE REELS	69
METAL CABLE REELS	70
MINI CABLE REELS	71
<b>RUBBER PLUGS &amp; SOCKETS</b>	72 - 73



# ÇELİK SİRAL BORULAR VE RAKORLARI

FLEXIBLE STEEL CONDUITS & FITTINGS



IP65



IK10



HALOGEN  
FREE

[www.fleks.com.tr](http://www.fleks.com.tr)

## ÇELİK SPİRAL & KILAVUZ TELLİ ÇELİK SPİRAL (GALVANİZLİ)



**GALVANISED STEEL FLEXIBLE CONDUIT**



**GALVANISED STEEL FLEXIBLE CONDUIT WIRED**

KOD CODE	ÖLÇÜ NOM. SIZE	İNÇ UST. SIZE	İÇ ÇAP ID (MM)	DIŞ ÇAP OD (MM)	PAKET PACKED (MT)
F01.1009	9	1/4"	9	12,5	50
F01.1011	11	3/8"	11	15	50
F01.1014	14	-	14	18	50
F01.1016	16	1/2"	16	20	50
F01.1018	18	-	18	22	50
F01.1021	21	3/4"	21	25	50
F01.1026	26	1"	26	30	25
F01.1029	29	-	29	34	25
F01.1032	32	-	32	37	25
F01.1035	35	1 1/4"	35	40	25
F01.1037	37	-	37	41	25
F01.1040	40	1 1/2"	40	45	25
F01.1042	42	-	42	47	25
F01.1045	45	-	45	51	25
F01.1050	50	2"	50	55	25
F01.1063	63	2 1/2"	63	67	15
F01.1075	75	3"	75	81	15
F01.1100	100	4"	102	110	15

KOD CODE	ÖLÇÜ NOM. SIZE	İNÇ UST. SIZE	İÇ ÇAP ID (MM)	DIŞ ÇAP OD (MM)	PAKET PACKED (MT)
F01.2009	9	1/4"	9	12,5	50
F01.2011	11	3/8"	11	15	50
F01.2014	14	-	14	18	50
F01.2016	16	1/2"	16	20	50
F01.2018	18	-	18	22	50
F01.2021	21	3/4"	21	25	50
F01.2026	26	1"	26	30	25
F01.2029	29	-	29	34	25
F01.2032	32	-	32	37	25
F01.2035	35	1 1/4"	35	40	25
F01.2037	37	-	37	41	25
F01.2040	40	1 1/2"	40	45	25
F01.2042	42	-	42	47	25
F01.2045	45	-	45	51	25
F01.2050	50	2"	50	55	25
F01.2063	63	2 1/2"	63	67	15
F01.2075	75	3"	75	81	15
F01.2100	100	4"	102	110	15

**SICAKLIK ARALIĞI**  
TEMPERATURE RANGE

-50°C~+300°C

**IP DERECELENDİRME**  
IP RATING

IP 40

**ESNEKLİK**  
FLEXIBILITY

Yüksek - High

**SERTİFİKA**  
CERTIFICATE

CE

**ÖZELLİKLER**  
FEATURES

- High flexibility
- Square-interlock at light weight
- Considerably small bending radius
- Smooth interior surface for easy cable installation

**PROFİL**  
PROFILE



**PVC İZOLELİ ÇELİK SPİRAL & KILAVUZ TELLİ PVC İZOLELİ ÇELİK SPİRAL (GALVANİZLİ)**



**PVC INSULATED GALVANISED STEEL FLEXIBLE CONDUIT**

KOD CODE	ÖLÇÜ NOM. SIZE	İÇ US T. SIZE	İÇ ÇAP ID (MM)	DIŞ ÇAP OD (MM)	PAKET PACKED (MT)
F02.1009	9	1/4"	9	12,5	50
F02.1011	11	3/8"	11	15	50
F02.1014	14	-	14	18	50
F02.1016	16	1/2"	16	20	50
F02.1018	18	-	18	22	50
F02.1021	21	3/4"	21	25	50
F02.1026	26	1"	26	30	25
F02.1029	29	-	29	34	25
F02.1032	32	-	32	37	25
F02.1035	35	1 1/4"	35	40	25
F02.1037	37	-	37	41	25
F02.1040	40	1 1/2"	40	45	25
F02.1042	42	-	42	47	25
F02.1045	45	-	45	51	25
F02.1050	50	2"	50	55	25
F02.1063	63	2 1/2"	63	67	15
F02.1075	75	3"	75	81	15
F02.1100	100	4"	102	110	15



**PVC INSULATED GALVANISED STEEL FLEXIBLE CONDUIT WIRED**

KOD CODE	ÖLÇÜ NOM. SIZE	İÇ US T. SIZE	İÇ ÇAP ID (MM)	DIŞ ÇAP OD (MM)	PAKET PACKED (MT)
F02.2009	9	1/4"	9	12,5	50
F02.2011	11	3/8"	11	15	50
F02.2014	14	-	14	18	50
F02.2016	16	1/2"	16	20	50
F02.2018	18	-	18	22	50
F02.2021	21	3/4"	21	25	50
F02.2026	26	1"	26	30	25
F02.2029	29	-	29	34	25
F02.2032	32	-	32	37	25
F02.2035	35	1 1/4"	35	40	25
F02.2037	37	-	37	41	25
F02.2040	40	1 1/2"	40	45	25
F02.2042	42	-	42	47	25
F02.2045	45	-	45	51	25
F02.2050	50	2"	50	55	25
F02.2063	63	2 1/2"	63	67	15
F02.2075	75	3"	75	81	15
F02.2100	100	4"	102	110	15

**SICAKLIK ARALIĞI**  
TEMPERATURE RANGE

-25°C~+90°C

**IP DERECELENDİRME**  
IP RATING

IP 54 - IP 65

**ESNEKLİK**  
FLEXIBILITY

Yüksek - High

**SERTİFİKA**  
CERTIFICATE

CE

**ÖZELLİKLER**  
FEATURES

- Excellent flexibility at light weight
- Low flame and smoke
- Electric installation systems in all narrow application areas, places with insufficient air-conditioning or high security needed places.
- Smooth interior surface for easy cable installation

**RENKLER**  
COLORS



**PROFİL**  
PROFILE



## PASLANMAZ ÇELİK SİRİRAL (304 & 316 KALİTE)



**STAINLESS STEEL FLEXIBLE CONDUIT  
304**



**STAINLESS STEEL FLEXIBLE CONDUIT  
316 L**

KOD CODE	ÖLÇÜ NOM. SIZE	İNÇ UST. SIZE	İÇ ÇAP ID (MM)	DIŞ ÇAP OD (MM)	PAKET PACKED (MT)
FO3.1009	9	-	10,0	14,0	50
FO3.1011	11	1/4"	11,0	15,0	50
FO3.1014	14	3/8"	14,0	17,0	50
FO3.1016	16	1/2"	15,5	19,5	50
FO3.1018	18	-	18,0	22,0	50
FO3.1021	21	3/4"	20,5	24,5	50
FO3.1026	26	1"	25,5	31,0	25
FO3.1029	29	-	28,0	34,0	25
FO3.1032	32	-	32,0	38,0	25
FO3.1035	35	1 1/4"	34,5	40,0	25
FO3.1037	37	-	37,7	44,5	25
FO3.1040	40	1 1/2"	39,5	45,5	25
FO3.1042	42	-	42,0	46,0	25
FO3.1045	45	-	45,0	51,5	25
FO3.1050	50	2"	50,0	55,0	25
FO3.1063	63	2 1/2"	63,0	67,0	10
FO3.1075	75	3"	75,0	81,0	10
FO3.1100	100	4"	102,0	110,0	10

KOD CODE	ÖLÇÜ NOM. SIZE	İNÇ UST. SIZE	İÇ ÇAP ID (MM)	DIŞ ÇAP OD (MM)	PAKET PACKED (MT)
F03.2009	9	-	10,0	14,0	50
F03.2011	11	1/4"	11,0	15,0	50
F03.2014	14	3/8"	14,0	18,0	50
F03.2016	16	1/2"	15,5	19,5	50
F03.2018	18	-	18,0	22,0	50
F03.2021	21	3/4"	20,5	24,5	50
F03.2026	26	1"	25,5	31,0	25
F03.2029	29	-	28,0	34,0	25
F03.2032	32	-	32,0	38,0	25
F03.2035	35	1 1/4"	34,5	40,0	25
F03.2037	37	-	37,7	44,5	25
F03.2040	40	1 1/2"	39,5	45,5	25
F03.2042	42	-	42,0	46,0	25
F03.2045	45	-	45,0	51,5	25
F03.2050	50	2"	50,0	55,0	25
F03.2063	63	2 1/2"	63,0	67,0	10
F03.2075	75	3"	75,0	81,0	10
F03.2100	100	4"	102,0	110,0	10

**SICAKLIK ARALIĞI**  
TEMPERATURE RANGE

-100°C~+600°C

**IP DERECELENDİRME**  
IP RATING

IP 40

**ESNEKLİK**  
FLEXIBILITY

Yüksek - High

**SERTİFİKA**  
CERTIFICATE

CE

**ÖZELLİKLER**  
FEATURES

- Best grade material
- Halogen, sulphur and phosphorus free
- Abrasion resistant
- Benzine, solvent and acid Resistant
- Non flammable
- Self extinguishing
- High mechanical strength
- UV resistance

**PROFİL**  
PROFILE





## HALOGEN FREE İZOLELİ ÇELİK SİRAL



### LSZH / LSOH COATED FLEXIBLE STEEL CONDUIT

KOD CODE	ÖLÇÜ NOM. SIZE	İÇ UST. SIZE	İÇ ÇAP ID (MM)	DIŞ ÇAP OD (MM)	PAKET PACKED (MT)
F04.1009	9	1/4"	9	12,5	50
F04.1011	11	3/8"	11	15	50
F04.1014	14	-	14	18	50
F04.1016	16	1/2"	16	20	50
F04.1018	18	-	18	22	50
F04.1021	21	3/4"	21	25	50
F04.1026	26	1"	26	30	25
F04.1029	29	-	29	34	25
F04.1032	32	-	32	37	25
F04.1035	35	1 1/4"	35	40	25
F04.1037	37	-	37	41	25
F04.1040	40	1 1/2"	40	45	25
F04.1042	42	-	42	47	25
F04.1045	45	-	45	51	25
F04.1050	50	2"	50	55	25
F04.1063	63	2 1/2"	63	67	15
F04.1075	75	3"	75	81	15
F04.1100	100	4"	102	110	15

**SICAKLIK ARALIĞI**  
TEMPERATURE RANGE

-40°C~+100°C

**IP DERECELENDİRME**  
IP RATING

IP 54 - IP 66

**ESNEKLİK**  
FLEXIBILITY

Yüksek - High

**SERTİFİKA**  
CERTIFICATE

CE

**YANGIN GECİKTİRİCİ**  
FIRE RETARDANT

Kendi kendine sönmeye  
Self-Extinguishing

**UV DAYANIMI**  
UV RESISTANCE

Siparişe - Upon Request

#### ÖZELLİKLER FEATURES

- Best grade material
- Waterproof
- Halogen, sulphur and phosphorus free
- Abrasion resistant
- Benzine, solvent and acid resistant
- High mechanical strength
- UV resistance (black colour)
- Low smoke zero halogen

**RENKLER**  
COLOURS



**PROFİL**  
PROFILE



## AĞIR HİZMET GALVANİZ ÇELİK SPİRAL (HALOJEN FREE & PVC KAPLI)



### LSOH COATED LIQUID TIGHT CONDUIT



### PVC COATED LIQUID TIGHT CONDUIT

KOD CODE	ÖLÇÜ NOM. SIZE	İNÇ UST. SIZE	İÇ ÇAP ID (MM)	DIŞ ÇAP OD (MM)	PAKET PACKED (MT)
F05.1011	11	1/4"	10,1	14,4	30
F05.1014	14	3/8"	12,6	17,8	30
F05.1016	16	1/2"	16,0	21,1	30
F05.1021	21	3/4"	21,0	26,5	30
F05.1026	26	1"	26,5	33,0	30
F05.1035	35	1 1/4"	35,1	41,8	15
F05.1040	40	1 1/2"	40,3	47,8	15
F05.1050	50	2"	51,5	59,8	15
F05.1063	63	2 1/2"	63,0	71,0	7,5
F05.1075	75	3"	77,0	86,0	7,5
F05.1100	100	4"	102,0	112,0	7,5

KOD CODE	ÖLÇÜ NOM. SIZE	İNÇ UST. SIZE	İÇ ÇAP ID (MM)	DIŞ ÇAP OD (MM)	PAKET PACKED (MT)
F05.2011	11	1/4"	10,1	14,4	30
F05.2014	14	3/8"	12,6	17,8	30
F05.2016	16	1/2"	16,0	21,1	30
F05.2021	21	3/4"	21,0	26,5	30
F05.2026	26	1"	26,5	33,0	30
F05.2035	35	1 1/4"	35,1	41,8	15
F05.2040	40	1 1/2"	40,3	47,8	15
F05.2050	50	2"	51,5	59,8	15
F05.2063	63	2 1/2"	63,0	71,0	7,5
F05.2075	75	3"	77,0	86,0	7,5
F05.2100	100	4"	102,0	112,0	7,5

**SICAKLIK ARALIĞI**  
TEMPERATURE RANGE

-40°C - +100°C

**IP DERECELENDİRME**  
IP RATING

IP 66-IP67-IP68-IP69

**ESNEKLİK**  
FLEXIBILITY

Yüksek - High

**SERTİFİKA**  
CERTIFICATE

CE

**YANGIN GECİKTİRİCİ**  
FIRE RETARDANT

Kendi kendine sönmeye  
Self-Extinguishing

**UV DAYANIMI**  
UV RESISTANCE

Siparişle - Upon request

**SICAKLIK ARALIĞI**  
TEMPERATURE RANGE

-20°C - +105°C

**IP DERECELENDİRME**  
IP RATING

IP 66-IP67-IP68

**ESNEKLİK**  
FLEXIBILITY

Yüksek - High

**SERTİFİKA**  
CERTIFICATE

CE

**YANGIN GECİKTİRİCİ**  
FIRE RETARDANT

Kendi kendine sönmeye  
Self-Extinguishing

**UV DAYANIMI**  
UV RESISTANCE

Siparişle - Upon request

### ÖZELLİKLER - FEATURES

- Best grade material ■ Waterproof
- Halogen, sulphur and phosphorus free ■ Abrasion resistant
- Benzine, solvent and acid resistant ■ Self extinguishing
- High mechanical strength ■ UV resistance (black colour)
- Smooth surface

### ÖZELLİKLER - FEATURES

- Best grade material ■ Waterproof ■ Abrasion resistant
- Benzine, solvent and acid resistant
- Self extinguishing ■ High mechanical strength
- UV resistance (black colour) ■ Smooth surface

**PROFİL**  
PROFILE



**PROFİL**  
PROFILE



## ÖRGÜLÜ ÇELİK SPİRAL GALVANİZ & PASLANMAZ ÇELİK TELLİ



**GALVANISED STEEL CORE,  
GALVANIZED STEEL OVER BRAID**



**GALVANISED STEEL CORE,  
STAINLESS STEEL OVERBRAID**

KOD CODE	ÖLÇÜ NOM. SIZE	İNÇ UST. SIZE	İÇ ÇAP ID (MM)	DIŞ ÇAP OD (MM)	PAKET PACKED (MT)
F06.1010	10	1/4"	10.0	14.0	30
F06.1013	13	3/8"	13.0	17.0	30
F06.1016	16	1/2"	16.0	21.0	30
F06.1021	21	3/4"	21.0	26.0	30
F06.1026	26	1"	26.0	32.0	30
F06.1035	35	1 1/4"	35.0	41.0	15
F06.1040	40	1 1/2"	40.0	47.0	15
F06.1052	52	2"	52.0	59.0	15

KOD CODE	ÖLÇÜ NOM. SIZE	İNÇ UST. SIZE	İÇ ÇAP ID (MM)	DIŞ ÇAP OD (MM)	PAKET PACKED (MT)
F06.2010	10	1/4"	10.0	14.0	30
F06.2013	13	3/8"	13.0	17.0	30
F06.2016	16	1/2"	16.0	21.0	30
F06.2021	21	3/4"	21.0	26.0	30
F06.2026	26	1"	26.0	32.0	30
F06.2035	35	1 1/4"	35.0	41.0	15
F06.2040	40	1 1/2"	40.0	47.0	15
F06.2052	52	2"	52.0	59.0	15

**SICAKLIK ARALIĞI**  
TEMPERATURE RANGE

-100°C~+300°C

**IP DERECELENDİRME**  
IP RATING

IP 40

**ESNEKLİK**  
FLEXIBILITY

Yüksek - High

**SERTİFİKA**  
CERTIFICATE

CE

**EMI TARAMASI**  
EMI SCREENING

Çok Yüksek - Very High

**SICAKLIK ARALIĞI**  
TEMPERATURE RANGE

-100°C~+300°C

**IP DERECELENDİRME**  
IP RATING

IP 40

**ESNEKLİK**  
FLEXIBILITY

Yüksek - High

**SERTİFİKA**  
CERTIFICATE

CE

**EMI TARAMASI**  
EMI SCREENING

Çok Yüksek - Very High

### ÖZELLİKLER - FEATURES

- Best grade material ■ Halgon, sulphur and phosphorus free
- Abrasion resistant ■ Benzine, solvent and acid resistant
- Self extinguishing ■ High mechanical strength
- UV resistance ■ Non flammable

### ÖZELLİKLER - FEATURES

- Best grade material ■ Halgon, sulphur and phosphorus free
- Abrasion resistant ■ Benzine, solvent and acid resistant
- Self extinguishing ■ High mechanical strength
- UV resistance ■ Non flammable

**PROFİL**  
PROFILE



**PROFİL**  
PROFILE



**ÜZERİ GALVANİZ TEL ÖRGÜLÜ PVC KAPLI & AĞIR HİZ. GALVANİZ ÇELİK SPİRAL**



**GALVANISED STEEL CORE, PVC COATED, GALVANISED STEEL OVERBRAID**

KOD CODE	ÖLÇÜ NOM. SIZE	İNÇ UST. SIZE	İÇ ÇAP ID (MM)	DIŞ ÇAP OD (MM)	PAKET PACKED (MT)
F071010	10	1/4"	10.0	14.0	30
F071013	13	3/8"	13.0	17.0	30
F071016	16	1/2"	16.0	21.0	30
F071021	21	3/4"	21.0	26.0	30
F071026	26	1"	26.0	32.0	30
F071035	35	1 1/4"	35.0	41.0	15
F071040	40	1 1/2"	40.0	47.0	15
F071051	51	2"	51.0	59.0	15



**GALVANISED STEEL CORE, PVC COATED, LIQUID TIGHT, GALVANISED STEEL OVERBRAID**

KOD CODE	ÖLÇÜ NOM. SIZE	İNÇ UST. SIZE	İÇ ÇAP ID (MM)	DIŞ ÇAP OD (MM)	PAKET PACKED (MT)
F072010	10	1/4"	10,5	18	30
F072012	12	3/8"	12,7	20	30
F072016	16	1/2"	16,3	23,4	30
F072021	21	3/4"	21,3	28,5	30
F072027	27	1"	27	35,3	30
F072035	35	1 1/4"	35,5	44	15
F072040	40	1 1/2"	40,5	50,2	15
F072051	51	2"	51,0	65	15

**SICAKLIK ARALIĞI**  
TEMPERATURE RANGE

-15°C~+70°C

**IP DERECELENDİRME**  
IP RATING

IP 54

**ESNEKLİK**  
FLEXIBILITY

Orta - Medium

**SERTİFİKA**  
CERTIFICATE

CE

**EMI TARAMASI**  
EMI SCREENING

Çok Yüksek - Very High

**SICAKLIK ARALIĞI**  
TEMPERATURE RANGE

-20°C~+100°C

**IP DERECELENDİRME**  
IP RATING

IP 66

**ESNEKLİK**  
FLEXIBILITY

Orta - Medium

**SERTİFİKA**  
CERTIFICATE

CE

**EMI TARAMASI**  
EMI SCREENING

Çok Yüksek - Very High

**ÖZELLİKLER - FEATURES**

- Best grade material ■ Halgon, sulphur and phosphorus free
- Abrasion resistant ■ Benzine, solvent and acid resistant
- Self extinguishing ■ High mechanical strength
- UV resistance ■ Emi screening

**ÖZELLİKLER - FEATURES**

- High impact strength
- Self extinguishing
- High UV Resistance (Black)
- High abrasion resistance

**PROFİL**  
PROFILE



**PROFİL**  
PROFILE



**YÜSÜKLÜ TİP SİRAL RAKORLARI SABİT & DÖNER DİŞ -ERKEK**



**STRAIGHT THREAD METAL CONNECTOR  
MALE TYPE**



**SWIVEL THREAD METAL CONNECTOR  
MALE TYPE**

**ÖZELLİKLER  
FEATURES**

- DAHİLİ TİP-FOR INDOOR USE ■ SABİTYA DA DÖNER DİŞ VERSİYONLARI-STRAIGHT OR SWIVEL BODY VERSIONS.
- NİKEL KAPLAMALI PİRİNÇTEN ÜRETİLMİŞ GÖVDE VE YÜKSÜK RING AND BODY MADE OF BRASS WITH NICKEL PLATED
- O RING: NPT (NİTRİL KAUCUK) ■ İSTEK ÜZERİNE, BU TİP RAKORLARIN BORU (DİŞİ) TİP ÖZELLİKLİ İMALATI DAYIYILABİLİR. - CAN ALSO BE PRODUCED WITH A REQUIRED CONDUIT FEMALE THREAD TYPE

KOD CODE	NPT TİP ÖLÇÜ NPT THREAD SIZE	METRİK TİP ÖLÇÜ METRIC SIZE	PG TİP ÖLÇÜ PG SIZE	UYGUN SİRAL ÖLÇÜ SUITABLE FLEX CONDUIT SIZE
F08.1007	-	M12x1,5	Pg7	10
F08.1009	1/4"	M16x1,5	Pg9	12
F08.1011	3/8"	M16x1,5	Pg11	16
F08.1016	1/2"	M20x1,5	Pg16	20
F08.1021	3/4"	M25x1,5	Pg21	25
F08.1029	1"	M32x1,5	Pg29	32
F08.1036	1 1/4"	M40x1,5	Pg36	40
F08.1042	1 1/2"	M50x1,5	Pg42	50
F08.1048	2"	M63x1,5	Pg48	63

KOD CODE	NPT TİP ÖLÇÜ NPT THREAD SIZE	METRİK TİP ÖLÇÜ METRIC SIZE	PG TİP ÖLÇÜ PG SIZE	UYGUN SİRAL ÖLÇÜ SUITABLE FLEX CONDUIT SIZE
F08.2007	-	M12x1,5	Pg7	10
F08.2009	1/4"	M16x1,5	Pg9	12
F08.2011	3/8"	M16x1,5	Pg11	16
F08.2016	1/2"	M20x1,5	Pg16	20
F08.2021	3/4"	M25x1,5	Pg21	25
F08.2029	1"	M32x1,5	Pg29	32
F08.2036	1 1/4"	M40x1,5	Pg36	40
F08.2042	1 1/2"	M50x1,5	Pg42	50
F08.2048	2"	M63x1,5	Pg48	63

**SICAKLIK ARALIĞI  
TEMPERATURE RANGE**

-30°C~+100°C

**IP DERECELENDİRME  
IP RATING**

IP 54

**MALZEME  
MATERIAL**

Nikel kaplama, pirinç  
Brass with nickel plated

**SERTİFİKA  
CERTIFICATE**

CE

**SICAKLIK ARALIĞI  
TEMPERATURE RANGE**

-30°C~+100°C

**IP DERECELENDİRME  
IP RATING**

IP 54

**MALZEME  
MATERIAL**

Nikel kaplama, pirinç  
Brass with nickel plated

**SERTİFİKA  
CERTIFICATE**

CE

**PARÇALARINA  
AYRIŞTIRILMIŞ  
GÖRÜNÜM  
EXPLODED VIEW**

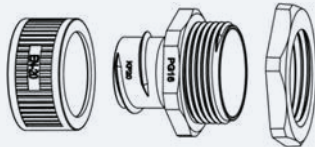

**PARÇALARINA  
AYRIŞTIRILMIŞ  
GÖRÜNÜM  
EXPLODED VIEW**

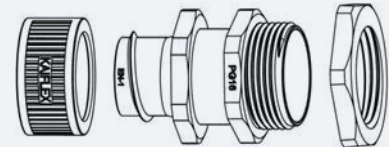

**SIVAMALI TİP AĞIR HİZMET SİRİRAL RAKORLARI-SABİT & DÖNER DİŞ- ERKEK**



**STRAIGHT THREAD L.T. METAL  
CONNECTOR / MALE TYPE**



**SWIVEL THREAD L.T. METAL  
CONNECTOR / MALE TYPE**

**ÖZELLİKLER  
FEATURES**

- HARİCİ TİP-FOR OUTDOOR USE STRAIGHT OR SWIVEL BODY VERSIONS-STRAIGHT OR SWIVEL BODY VERSIONS.
- NİKEL KAPLAMALI PİRİNÇTEN ÜRETİLMİŞ GÖVDE VE KAPAK  
CAP NUT AND BODY MADE OF BRASS WITH NICKEL PLATED. O RING: NPT (NİTRİL KAUCUK)
- KAPAK CONTASI-CLAMPING INSERT:PA6 - CONTA-SEALING RING:TPV
- RING:POLİETİLEN-POLYETHYLENE ■ FERRULE:ALUMİNİUM/GALNANİSİD

KOD CODE	NPT TİP ÖLÇÜ NPT THREAD SIZE	METRİK TİP ÖLÇÜ METRIC SIZE	PG TİP ÖLÇÜ PG SIZE	UYGUN SİRİRAL ÖLÇÜ SUITABLE FLEX CONDUIT SIZE
F091007	-	M12x1,5	Pg7	10
F091009	1/4"	M16x1,5	Pg9	12
F091011	3/8"	M16x1,5	Pg11	16
F091016	1/2"	M20x1,5	Pg16	20
F091021	3/4"	M25x1,5	Pg21	25
F091029	1"	M32x1,5	Pg29	32
F091036	1 1/4"	M40x1,5	Pg36	40
F091042	1 1/2"	M50x1,5	Pg42	50
F091048	2"	M63x1,5	Pg48	63

KOD CODE	NPT TİP ÖLÇÜ NPT THREAD SIZE	METRİK TİP ÖLÇÜ METRIC SIZE	PG TİP ÖLÇÜ PG SIZE	UYGUN SİRİRAL ÖLÇÜ SUITABLE FLEX CONDUIT SIZE
F09.2007	-	M12x1,5	Pg7	10
F09.2009	1/4"	M16x1,5	Pg9	12
F09.2011	3/8"	M16x1,5	Pg11	16
F09.2016	1/2"	M20x1,5	Pg16	20
F09.2021	3/4"	M25x1,5	Pg21	25
F09.2029	1"	M32x1,5	Pg29	32
F09.2036	1 1/4"	M40x1,5	Pg36	40
F09.2042	1 1/2"	M50x1,5	Pg42	50
F09.2048	2"	M63x1,5	Pg48	63

**SICAKLIK ARALIĞI  
TEMPERATURE RANGE**

-45°C~+105°C

**IP DERECELENDİRME  
IP RATING**

IP 67

**MALZEME  
MATERIAL**

Nikel kaplama, pirinç  
Brass with nickel plated

**SERTİFİKA  
CERTIFICATE**

CE

**PROFİL  
PROFILE**

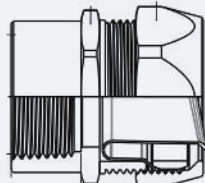

**SICAKLIK ARALIĞI  
TEMPERATURE RANGE**

-45°C~+105°C

**IP DERECELENDİRME  
IP RATING**

IP 67

**MALZEME  
MATERIAL**

Nikel kaplama, pirinç  
Brass with nickel plated

**SERTİFİKA  
CERTIFICATE**

CE

**PROFİL  
PROFILE**

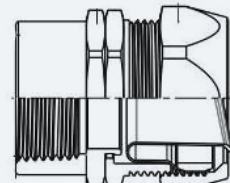

## SİLOK (MELEZ) TİP KABLO TUTUCU AĞIR HİZMET SİRAL RAKORU



<b>SICAKLIK ARALIĞI</b> TEMPERATURE RANGE	-30°C~+100°C
<b>IP DERECELENDİRME</b> IP RATING	IP 67
<b>MALZEME</b> MATERIAL	Nikel kaplama, pirinç Brass with nickel plated
<b>SERTİFİKA</b> CERTIFICATE	CE

### L.T. METAL SİLOK TYPE CONNECTOR WITH CABLE HOLDER

#### ÖZELLİKLER FEATURES

- SABİT YA DA DÖNER DIŞ VERSİYONLARI ■ NİKEL KAPLAMALI PİRİNÇTEN ÜRETİLMİŞ GÖVDE VE KAPAK NPT (NİTRİL KAUCUK)
- KAPAK CONTASI:PA6 ■ RING:POLİETİLEN ■ SIVAMA:ALUMİNİUM/GALNANİSE ■ SİRAL BORUYA TAKILABİLDİĞİ GİBİ, İÇİNDEKİ CONTASI SAYESİNDE KABLO RAKORU GÖREVİ DE YAPMAKTADIR. ■ İSTEĞE GÖRE ÖZEL BOYLARDA VE DİŞLERDE YAPILABİLİR.
- STRAIGHT OR SWIVEL BODY VERSIONS. ■ CAP NUT AND BODY MADE OF BRASS WITH NICKEL PLATED.
- O RING: NPT ■ CLAMPING INSERT:PA6 ■ SEALING RING:TPV ■ RING:POLYETHYLENE ■ FERRULE:ALUMİNİUM/GALNANİSE
- CAN BE USED AS A FMC CONNECTOR OR AS A CABLE CONNECTOR THANKS TO ITS INTERNAL SEAL.
- SPECIAL SIZES AND THREAD SIZES CAN BE MANUFACTURED IF REQUESTED.

#### NPT Diş Tipi - NPT Thread Type

KOD CODE	NPT TİP ÖLÇÜ NPT THREAD SIZE	UYGUN SİRAL ÖLÇÜ SUITABLE FLEX. CONDUIT SIZE	SIKMA ARALIĞI CLAMPING RANGE	DELİK ÇAPI HOLE DIA.
FI01010	1/4"	10	4÷8	15,8
FI01011	3/8"	13	5÷10	19,2
FI01012	1/2"	16	6÷12	23,4
FI01013	3/4"	21	13÷18	28,7
FI01014	1"	26	18÷25	35,5
FI01015	1 1/4"	35	22÷32	44,2
FI01016	1 1/2"	40	30÷38	50,0
FI01017	2"	52	34÷44	62,5
FI01018	2 1/2"	63	48÷61	75,1
FI01019	3"	75	56÷72	88,8

#### GAS Diş Tipi - GAS Thread Type

KOD CODE	GAS TİP ÖLÇÜSÜ GAS TYPE SIZE	UYGUN SİRAL ÖLÇÜ SUITABLE FLEX. CONDUIT SIZE	SIKMA ARALIĞI CLAMPING RANGE	DELİK ÇAPI HOLE DIA.
FI01020	1/4"	10	4÷8	15,2
FI01021	3/8"	13	5÷10	18,7
FI01022	1/2"	16	6÷12	23,0
FI01023	3/4"	21	13÷18	28,4
FI01024	1"	26	18÷25	35,3
FI01025	1 1/4"	35	22÷32	43,9
FI01026	1 1/2"	40	30÷38	49,8
FI01027	2"	52	34÷44	61,6
FI01028	2 1/2"	63	48÷61	77,2
FI01029	3"	75	56÷72	90,0

#### Metrik Diş Tipi - Metric Thread Type

KOD CODE	METRİK TİP ÖLÇÜ METRIC SIZE	UYGUN SİRAL ÖLÇÜ SUITABLE FLEX. CONDUIT SIZE	SIKMA ARALIĞI CLAMPING RANGE	DELİK ÇAPI HOLE DIA.
FI01030	M12	10	4÷8	14,2
FI01031	M16	13	5÷10	18,2
FI01032	M20	16	6÷12	22,2
FI01033	M25	21	13÷18	27,2
FI01034	M32	26	18÷25	34,2
FI01035	M40	35	22÷32	42,2
FI01036	M50	40	30÷38	52,2
FI01037	M63	52	34÷44	65,2
FI01038	M72	63	48÷61	74,2

#### PG Diş Tipi - Pg Thread Type

KOD CODE	PG TİP ÖLÇÜ PG SIZE	UYGUN SİRAL ÖLÇÜ SUITABLE FLEX. CONDUIT SIZE	SIKMA ARALIĞI CLAMPING RANGE	DELİK ÇAPI HOLE DIA.
FI01040	Pg9	10	4÷8	17,2
FI01041	Pg11	13	5÷10	20,6
FI01042	Pg13,5	16	6÷12	22,4
FI01043	Pg16	16	6÷12	24,5
FI01044	Pg21	21	13÷18	30,3
FI01045	Pg29	26	18÷25	39,0
FI01046	Pg36	35	22÷32	49,0
FI01047	Pg42	40	30÷38	56,0
FI01048	Pg48	52	34÷44	61,3

## STANDART TİP KABLO RAKORLARI-METRİK



### STANDARD TYPE METAL CABLE GLANDS-BRASS-METRIC

#### ÖZELLİKLER FEATURES

- NİKEL KAPLAMALI PİRİNÇTEN ÜRETİLMİŞ GÖVDE VE KAPAK
- O-RING: NBR ■ KAPAK CONTASI:PA6 V2 ■ CONTA:TPV
- CAP NUT AND BODY MADE OF BRASS WITH NICKEL PLATED.
- O-RING: NBR ■ CLAMPING INSERT:PA6 V2 ■ SEALING RING:TPV

#### Metrik Diş Tipi - Metric Thread Type

KOD CODE	METRİK TİP ÖLÇÜ METRIC TYPE SIZE	A MM	B MM	W1 MM	W2 MM	KABLO ÇAPI CABLE DIA. MM
F11.1001	M12x1,5	6	22	14	14	3 -6,5
F11.1002	M16x1,5	7	23	18	17	4 -8
F11.1003	M20x1,5	8	26,5	22	22	4 -10
F11.1004	M20x1,5	8	26,5	22	22	6 -12
F11.1005	M25x1,5	8	28	27	24	10 -14
F11.1006	M32x1,5	9	31,5	34	30	13 -18
F11.1007	M40x1,5	9	38	43	40	18 -25
F11.1008	M50x1,5	9	43	55	50	22 -32
F11.1009	M63x1,5	14	48	68	64	33-44

#### Uzun Metrik Diş Tipi - Long Metric Thread Type

KOD CODE	METRİK TİP ÖLÇÜ METRIC TYPE SIZE	A MM	B MM	W1 MM	W2 MM	KABLO ÇAPI CABLE DIA. MM
F11.2001	M12x1,5	12	22	14	14	3 -6,5
F11.2002	M16x1,5	12	23	18	17	4 -8
F11.2003	M20x1,5	12	26,5	22	22	4 -10
F11.2004	M20x1,5	12	26,5	22	22	6 -12
F11.2005	M25x1,5	12	28	27	24	10 -14
F11.2006	M32x1,5	14	31,5	34	30	13 -18
F11.2007	M40x1,5	14	38	43	40	18 -25
F11.2008	M50x1,5	14	43	55	50	22 -32
F11.2009	M63x1,5	18	48	68	64	33-44

#### SICAKLIK ARALIĞI TEMPERATURE RANGE

-40°C~+105°C

#### IP DERECELENDİRME IP RATING

IP 68

#### MALZEME MATERIAL

Nikel kaplı pirinç ve PolyamidPA6 V2 Kapak Contası  
Brass with nickel plated, and Polyamide PA6 V2 Clamping insert.

#### SERTİFİKA CERTIFICATE

CE

#### SICAKLIK ARALIĞI TEMPERATURE RANGE

-40°C~+105°C

#### IP DERECELENDİRME IP RATING

IP 68

#### MALZEME MATERIAL

Nikel kaplı pirinç ve Polyamid PA6V2 Kapak Contası  
Brass with nickel plated, and Polyamide PA6V2 Clamping insert.

#### SERTİFİKA CERTIFICATE

CE

#### PROFİL PROFILE

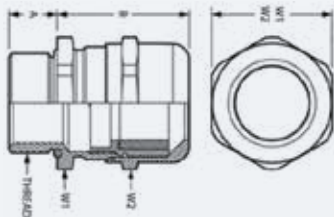

#### PROFİL PROFILE

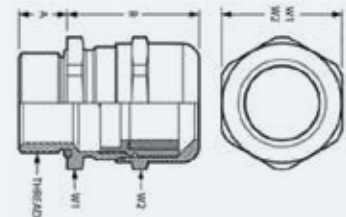



**STANDART TİP KABLO RAKORLARI-PG**

**STANDARD TYPE METAL CABLE GLANDS-BRASS-PG**
**ÖZELLİKLER**  
 FEATURES

- NİKEL KAPLAMALI PİRİNÇTEN ÜRETİLMİŞ GÖVDE VE KAPAK
- O-RING: NBR ■ KAPAK CONTASI:PA6 V2 ■ CONTA:TPV
- CAP NUT AND BODY MADE OF BRASS WITH NICKEL PLATED.
- O-RING: NBR ■ CLAMPING INSERT:PA6 V2 ■ SEALING RING:TPV

**PG Diş Tipi - Pg Thread Type**

KOD CODE	DIŞ THREAD	A MM	B MM	BURKMA WRENCH	KABLO ÇAPI CABLE DIA.
				23 MM	MM
F12.3001	PG7	6	22	14	3 -6,5
F12.3002	PG9	6	23	17	4 -8
F12.3003	PG11	6	24,5	20	5 -10
F12.3004	PG13,5	6,5	26,5	22	4 -10
F12.3005	PG13,5	6,5	26,5	22	6 -12
F12.3006	PG16	6,5	28	24	10 -14
F12.3007	PG21	7	31,5	30	13 -18
F12.3008	PG29	8	38	40	18 -25
F12.3009	PG36	10	43	50	22 -32
F12.3010	PG42	12	47	57	30 -38
F12.3011	PG48	14	48	64	34 -44

**PG Uzun Metrik Diş Tipi - Long Pg Thread Type**

KOD CODE	DIŞ THREAD	A MM	B MM	BURKMA WRENCH	KABLO ÇAPI CABLE DIA.
				23 MM	MM
F12.4001	PG7	10	22	14	3 -6,5
F12.4002	PG9	10	23	17	4 -8
F12.4003	PG11	10	24,5	20	5 -10
F12.4004	PG13,5	10	26,5	22	4 -10
F12.4005	PG13,5	10	26,5	22	6 -12
F12.4006	PG16	10	28	24	10 -14
F12.4007	PG21	12	31,5	30	13 -18
F12.4008	PG29	12	38	40	18 -25
F12.4009	PG36	14	43	50	22 -32
F12.4010	PG42	18	47	57	30 -38
F12.4011	PG48	18	48	64	34 -44

**SICAKLIK ARALIĞI**  
 TEMPERATURE RANGE

-40°C~+105°C

**IP DERECELENDİRME**  
 IP RATING

IP 68

**MALZEME**  
 MATERIAL

 Nikel kaplı pirinç ve PolyamidPA6 V2 Sıkma eki.  
 Nickel plated brass, and Polyamid PA6 V2 Clamping insert.

**SERTİFİKA**  
 CERTIFICATE

CE

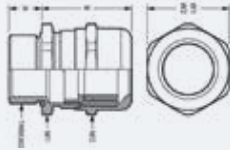
**PROFİL**  
 PROFILE

**SICAKLIK ARALIĞI**  
 TEMPERATURE RANGE

-40°C~+105°C

**IP DERECELENDİRME**  
 IP RATING

IP 68

**MALZEME**  
 MATERIAL

 Nikel kaplı pirinç ve Polyamid PA6 V2 Sıkma eki.  
 Nickel plated brass, and Polyamid PA6 V2 Clamping insert.

**SERTİFİKA**  
 CERTIFICATE

CE

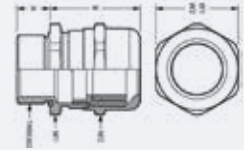
**PROFİL**  
 PROFILE

## TEK SIKMALI ZIRHSIZ EX PROOF KABLO RAKORLARI



### ÖZELLİKLER FEATURES

Type	: UAG (Un-ar) Unarmoured gland
Protection code	: I M2 Ex db I Mb / I M2 Ex eb I Mb II 2G Ex db IIC Gb / II 2G Ex eb II Gb II 2D Ex tb IIIC Db
Certificate	: IEP 14 ATEX 0217X ATEX, ROHS, CE
Material	: MS58 Brass with or without nickel plated Stainless steel AISI303 / 316L / Aluminium
Standards	: EN 60079-0:2012, 60079-7:2007, 60079-1:2007 60079-31:2009
Protection class	: IP68
Temperature	: -30 °C +120 °C NBR : -40 °C +100 °C NEOPRENE : -60 °C +180 °C SILICONE : -30 °C +100 °C TPE/V
Application area	: ZONE1, ZONE2, ZONE21, ZONE22, Gas Group IIA, IIB, IIC
Cable type	: Unarmoured

### UNARMOURED CABLE GLANDS

#### OPSİYONEL AKSESUAR

PVC Kılıf, Kilitleme Somunu, Topraklama Pulu, Sızdırmazlık Contası

#### OPTIONAL ACCESSORIES

PVC Shroud, Lock Nut, Earth Tag, IP Washer Gasket

KOD CODE	STANDARD AG	AG	GL	SIKMA ARALIĞI CLAMPING RANGE		B	C
				MIN. (MM)	(MM)		
<b>Exd</b>							
FLXD-12-X	M12x1,5	1/4"	15	3-6,5	14	14	
FLXD-16-X	M16x1,5	3/8"	15	4-8	18	17	
FLXD-20S-X	M20x1,5	1/2"	15	4-10	22	22	
FLXD-20-X	M20x1,5	1/2"	15	6-12	22	22	
FLXD-25S-X	M25x1,5	3/4"	15	10-14	27	24	
FLXD-25-X	M25x1,5	3/4"	15	13-18	30	30	
FLXD-25L-X	M25x1,5	3/4"	15	9-17	30	30	
FLXD-32-X	M32x1,5	1"	15	13-18	34	30	
FLXD-40-X	M40x1,5	1 1/4"	15	18-25	43	40	
FLXD-50-X	M50x1,5	1 1/2"	15	22-32	55	50	
FLXD-63S-X	M63x1,5	2"	15	33-44	70	64	
FLXD-63-X	M63x1,5	2"	15	45-50	70	75	
FLXD-75S-X	M75x1,5	2 1/2"	20	45-55	85	75	
FLXD-75-X	M75x1,5	2 1/2"	20	50-63	90	90	
FLXD-80-X	M80x2,0	3"	20	50-63	90	90	
FLXD-90-X	M90x2,0	3"	20	60-70	100	100	

### Exe

FLXE-12-X	M12x1,5	1/4"	6	3-6,5	14	14
FLXE-16-X	M16x1,5	3/8"	7	4-8	18	17
FLXE-20-X	M20x1,5	1/2"	8	6-12	22	22
FLXE-25S-X	M25x1,5	3/4"	8	10-14	27	24
FLXE-25-X	M25x1,5	3/4"	8	13-18	30	30
FLXE-32-X	M32x1,5	1"	9	13-18	34	30
FLXE-40-X	M40x1,5	1 1/4"	9	18-25	43	40
FLXE-50-X	M50x1,5	1 1/2"	9	22-32	55	50
FLXE-63S-X	M63x1,5	2"	14	33-44	68	64

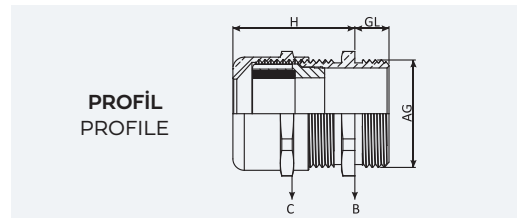

**TEK SIKMALI ZIRHSIZ EX PROOF KABLO RAKORLARI**



**ÖZELLİKLER FEATURES**

Type	: UG (Un-ar) Armoured gland
Protection code	: I M2 Ex db I Mb / I M2 Ex eb I Mb II 2G Ex db III C Gb / II 2G Ex eb II Gb II 2D Ex tb III C Db
Certificate	: IEP 14 ATEX 0217X ATEX, ROHS, CE, PT, TUV
Material	: MS58 Brass with or without nickel plated Stainless steel AISI303 / 316L / Aluminium
Standards	: EN 60079-0:2012, 60079-7:2007, 60079-1:2007 60079-31:2009
Protection class	: IP66 / 68
Temperature	: -30 °C +120 °C NBR : -40 °C +100 °C NEOPRENE : -60 °C +180 °C SILICONE : -30 °C +100 °C TPE/V
Application area	: ZONE1, ZONE2, ZONE21, ZONE22, Gas Group IIA, IIB, IIC
Cable type	: Unarmoured

**UNARMOURED CABLE GLANDS**

OPSIYONELAKSESUAR

PVC Kılıf, Kilitleme Somunu, Topraklama Pulu, Sızdırmazlık Contası

OPTIONAL ACCESSORIES

PVC Shroud, Lock Nut, Earth Tag, IP Washer Gasket

KOD CODE	STANDARD AG	AG NPT	B		GL MIN. (MM)	C (MM)	B (MM)
			MIN	MAX			
FLXD-16-XX	M16x1,5	1/2"	6,1	11,6	15	20	20
FLXD-20S-XX	M20sx1,5	1/2"	6,1	13,2	15	24	24
FLXD-20-XX	M20x1,5	1/2"	9,5	15,9	15	24	24
FLXD-25-XX	M25x1,5	3/4"	12,5	20,5	15	30	30
FLXD-32-XX	M32x1,5	1"	18,2	26,2	15	38	38
FLXD-40-XX	M40x1,5	1 1/4"	23,7	33,9	15	45	45
FLXD-50-XX	M50x1,5	1 1/2"	27,9	40,4	15	55	55
FLXD-63S-XX	M63sx1,5	2"	40,4	51	15	70	70
FLXD-63-XX	M63x1,5	2 1/2"	47,2	55,9	15	70	70
FLXD-75S-XX	M75sx1,5	2 1/2"	52,8	59	15	80	80
FLXD-75-XX	M75x1,5	3"	59,1	67,9	15	90	90

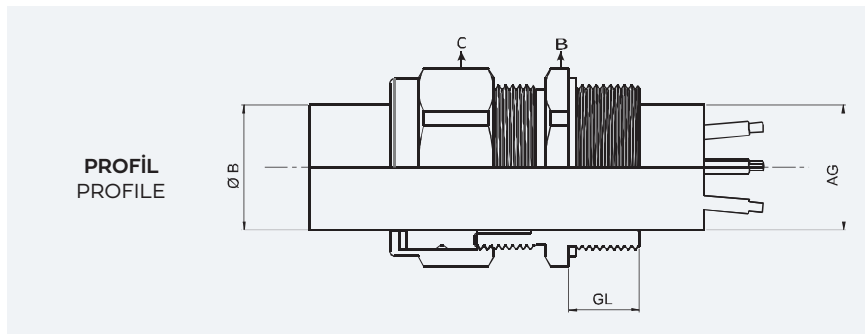

## SÜPER ETANJ POLYAMİD KABLO RAKORLARI-METRİK



**SICAKLIK ARALIĞI**  
TEMPERATURE RANGE

-20°C~+100°C

**IP DERECELENDİRME**  
IP RATING

IP 68

**MALZEME**  
MATERIAL

Polyamid PA6V2  
Polyamide PA6V2

**SERTİFİKA**  
CERTIFICATE

CE

**PROFİL - PROFILE**

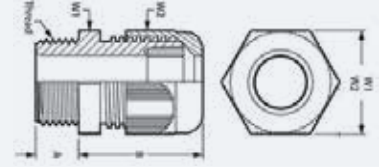

SUPER WATERPROOF POLYAMIDE CABLE GLANDS - METRIC TYPE

### ÖZELLİKLER - FEATURES

Kapak (Cap Nut) : Polyamid PA6 V2 - Conta (Sealing Ring) : TPV  
Gövde (Gland) : Polyamid PA6 V2 - Halojen içermez - Halogen free  
9005 (Siyah-Black), RAL 1007 (Gri Grey), RAL 7035 (Açık Gri - Light Grey)

### Metrik Diş Tipi - Metric Thread Type

KOD - Gri CODE - Grey	KOD - Gri CODE - Grey	KOD - Siyah CODE - Black	DIŞ THREAD	A MM	B MM	W1 MM	KABLO ÇAPI CABLE DIAMETER
RAL 7001 (Gri-Grey)	RAL 7035 (Açık Gri- Light Grey)	9005 (Siyah-Black)					MIN - MAX
Fİ3.1001	Fİ3.2001	Fİ3.3001	M 12 X1.5	8	24	15	3-6,5
Fİ3.1002	Fİ3.2002	Fİ3.3002	M 16 X1.5	8	28	19	4-8
Fİ3.1003	Fİ3.2003	Fİ3.3003	M 16 X1.5	10	29	22	5-10
Fİ3.1004	Fİ3.2004	Fİ3.3004	M 20 X1.5	10	29	24	4-10
Fİ3.1005	Fİ3.2005	Fİ3.3005	M 20 X1.5	10	29	24	6-12
Fİ3.1006	Fİ3.2006	Fİ3.3006	M 25 X1.5	10	33	27	10-14
Fİ3.1007	Fİ3.2007	Fİ3.3007	M 25 X1.5	10	38	33	13-18
Fİ3.1008	Fİ3.2008	Fİ3.3008	M 32 X1.5	10	41	42	18-25
Fİ3.1009	Fİ3.2009	Fİ3.3009	M 40 X1.5	10	51	53	22-32
Fİ3.1010	Fİ3.2010	Fİ3.3010	M 50 X1.5	18	53	60	30-38
Fİ3.1011	Fİ3.2011	Fİ3.3011	M 63 X1.5	18	55	70	33-44

### Uzun Metrik Diş Tipi - Long Metric Thread Type

KOD - Gri CODE - Grey	KOD - Gri CODE - Grey	KOD - Siyah CODE - Black	DIŞ THREAD	A MM	B MM	W1 MM	KABLO ÇAPI CABLE DIAMETER
RAL 7001 (Gri-Grey)	RAL 7035 (Açık Gri- Light Grey)	9005 (Siyah-Black)					MIN - MAX
Fİ3.4001	Fİ3.5001	Fİ3.6001	M 12 X1.5	8	24	15	3-6,5
Fİ3.4002	Fİ3.5002	Fİ3.6002	M 16 X1.5	8	28	19	4-8
Fİ3.4003	Fİ3.5003	Fİ3.6003	M 16 X1.5	10	29	22	5-10
Fİ3.4004	Fİ3.5004	Fİ3.6004	M 20 X1.5	10	29	24	4-10
Fİ3.4005	Fİ3.5005	Fİ3.6005	M 20 X1.5	10	29	24	6-12
Fİ3.4006	Fİ3.5006	Fİ3.6006	M 25 X1.5	10	33	27	10-14
Fİ3.4007	Fİ3.5007	Fİ3.6007	M 25 X1.5	10	38	33	13-18
Fİ3.4008	Fİ3.5008	Fİ3.6008	M 32 X1.5	10	41	42	18-25
Fİ3.4009	Fİ3.5009	Fİ3.6009	M 40 X1.5	10	51	53	22-32

## SÜPER ETANJ POLYAMİD KABLO RAKORLARI-PG



**SICAKLIK ARALIĞI**  
TEMPERATURE RANGE

-20°C~+100°C

**IP DERECELENDİRME**  
IP RATING

IP 68

**MALZEME**  
MATERIAL

Polyamid PA6V2  
Polyamide PA6V2

**SERTİFİKA**  
CERTIFICATE

CE

**PROFİL - PROFILE**

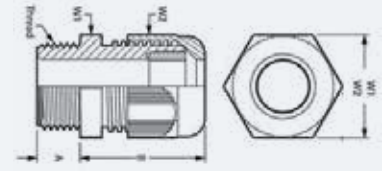

SUPER WATERPROOF POLYAMIDE CABLE GLANDS METRIC TYPE

### ÖZELLİKLER - FEATURES

Kapak (Cap Nut) :Polyamid PA6 V2 - Conta (Sealing Ring) :TPV  
Gövde(Gland Body) :Polyamid PA6 V2 - Halojen İçermez- Halogen Free  
RAL 9005(Siyah-Black),RAL 7001(Gri-Grey), RAL 7035 (Açık Gri-Light Grey)

### PG Diş Tipi - PG Thread Type

KOD - Gri CODE - Grey	KOD - Gri CODE - Grey	KOD - Siyah CODE - Black	DİŞ THREAD	GL MM	H MM	BURKMA WRENCH	KABLO ÇAPI CABLE DIAMETER
RAL 7001 (Gri-Grey)	RAL 7035 (Açık Gri- Light Grey)	9005 (Siyah-Black)				MM	MIN - MAX
FL4.7001	FL4.8001	FL4.9001	PG7	8	24	15	3-6,5
FL4.7002	FL4.8002	FL4.9002	PG9	8	28	19	4-8
FL4.7003	FL4.8003	FL4.9003	PG11	8	29	22	5-10
FL4.7004	FL4.8004	FL4.9004	PG13,5	9	29	24	4-10
FL4.7005	FL4.8005	FL4.9005	PG13,5	9	29	24	6-12
FL4.7006	FL4.8006	FL4.9006	PG16	9	33	27	10-14
FL4.7007	FL4.8007	FL4.9007	PG21	11	38	33	13-18
FL4.7008	FL4.8008	FL4.9008	PG29	11	41	42	18-25
FL4.7009	FL4.8009	FL4.9009	PG36	13	51	53	22-32
FL4.7010	FL4.8010	FL4.9010	PG42	13	53	60	30-38
FL4.7011	FL4.8011	FL4.9011	PG48	14	55	65	33-44

### Uzun Diş PG Tipi - Long Thread PG Type

KOD - Gri CODE - Grey	KOD - Gri CODE - Grey	KOD - Siyah CODE - Black	DİŞ THREAD	GL MM	H MM	BURKMA WRENCH	KABLO ÇAPI CABLE DIAMETER
RAL 7001 (Gri-Grey)	RAL 7035 (Açık Gri- Light Grey)	9005 (Siyah-Black)				MM	MIN - MAX
FL4.1001	FL4.1101	FL4.1201	PG7	15	24	15	3-6,5
FL4.1002	FL4.1102	FL4.1202	PG9	15	28	19	4-8
FL4.1003	FL4.1103	FL4.1203	PG11	11	29	22	5-10
FL4.1004	FL4.1104	FL4.1204	PG11	15	29	22	5-10
FL4.1005	FL4.1105	FL4.1205	PG13,5	15	29	24	4-10
FL4.1006	FL4.1106	FL4.1206	PG13,5	15	33	24	6-12
FL4.1007	FL4.1107	FL4.1207	PG16	15	33	27	10-14
FL4.1008	FL4.1108	FL4.1208	PG21	15	38	33	13-18



- ANSI C80.3, GOST-R ve EAC sertifikalıdır.
- Çapaksız elektrik tesisat borularıdır.
- Standart imalat uzunlukları 3.00 mt'dir.
- Pre-galvaniz kaplama ve bükülebilir özelliklidir.
- UL belgelisi, sıcak daldırma galvaniz kaplamalıdır.
- Belirtilen fiziksel bilgiler  $\pm$  %5 tolerans dahilindedir.
- Özellikle sosyal tesislerde, iş merkezlerinde, atölyelerde ve gökdelenlerde dahili ortamlarda kullanılır.

KOD CODE	EBAT SIZE	İÇ ÇAP - DIŞ ÇAP ID / OD MM	BAĞ-BOY ADEDİ QUANTITY PER BUNDLE (PCS)
FLX-1/2'	1/2"	15,80 x 17,93	10
FLX-3/4'	3/4"	20,93 x 23,42	10
FLX-1'	1"	26,64 x 29,54	10
FLX-1/4'	1 1/4"	35,05 x 38,35	5
FLX-1/2'	1 1/2"	40,89 x 44,2	5
FLX-2'	2"	52,50 x 55,8	3

## EMT AKSESUARLARI - EMT ACCESSORIES

### VİDALI BORU MUFU SCREW TYPE COUPLING



- UL, GOST-R ve EAC sertifikalıdır.
- Zamak (çinko döküm) orjinlidir.
- EMT boruların vidalı birleşiminde kullanılır.

### 90° EMT DİRSEK THREADLESS ELBOW



- GOST-R ve EAC sertifikalıdır.
- Pre-galvaniz kaplamalıdır.
- Elektro galvaniz ve sıcak daldırma kaplamalı tipleri de mevcuttur.
- EMT boruların 90° dönüşünde kullanılır

### VİDALI SİRİRAL RAKORU SCREW TYPE ENDING CONNECTOR



- UL, GOST-R ve EAC sertifikalıdır.
- Zamak (çinko döküm) orjinlidir.
- EMT boruların kutuya, buata, tavaya sabitlenmeleri için kullanılır.

KOD CODE	EBAT SIZE	PAKET PACKAGE
FLX-511	1/2"	50
FLX-512	3/4"	50
FLX-513	1"	25
FLX-514	1 1/4"	10
FLX-515	1 1/2"	10
FLX-516	2"	5

KOD CODE	EBAT SIZE	PAKET PACKAGE
FLX-21-81	1/2"	50
FLX-22-82	3/4"	50
FLX-23-83	1"	25
FLX-24-84	1 1/4"	10
FLX-25-85	1 1/2"	10
FLX-26-86	2"	5

KOD CODE	EBAT SIZE	PAKET PACKAGE
FLX-501	1/2"	50
FLX-502	3/4"	50
FLX-503	1"	25
FLX-504	1 1/4"	10
FLX-505	1 1/2"	10
FLX-506	2"	5

**ALÜMİNYUM DÖKÜM DIŞLİ KONDÜLETLER - RIGID ALUMINUM CAST IRON CONDUIT BODIES (THREADED TYPE)**
**IMC KONDÜLET LB  
CONDULETTYPE "LB"**

**IMC KONDÜLET LL  
CONDULETTYPE "LL"**

**IMC KONDÜLET LR  
CONDULETTYPE "LR"**

KOD CODE	EBAT SIZE	PAKET PACKAGE
-------------	--------------	------------------

FLX-LB1	1/2"	50
FLX-LB2	3/4"	50
FLX-LB3	1"	25
FLX-LB4	1 1/4"	10
FLX-LB5	1 1/2"	10
FLX-LB6	2"	5

KOD CODE	EBAT SIZE	PAKET PACKAGE
-------------	--------------	------------------

FLX-LL1	1/2"	50
FLX-LL2	3/4"	50
FLX-LL3	1"	25
FLX-LL4	1 1/4"	10
FLX-LL5	1 1/2"	10
FLX-LL6	2"	5

KOD CODE	EBAT SIZE	PAKET PACKAGE
-------------	--------------	------------------

FLX-LR1	1/2"	50
FLX-LR2	3/4"	50
FLX-LR3	1"	25
FLX-LR4	1 1/4"	10
FLX-LR5	1 1/2"	10
FLX-LR6	2"	5

**IMC KONDÜLET C  
CONDULETTYPE "C"**

**IMC KONDÜLET T  
CONDULETTYPE "T"**

KOD CODE	EBAT SIZE	PAKET PACKAGE
-------------	--------------	------------------

FLX-C1	1/2"	50
FLX-C2	3/4"	50
FLX-C3	1"	25
FLX-C4	1 1/4"	10
FLX-C5	1 1/2"	10
FLX-C6	2"	5

KOD CODE	EBAT SIZE	PAKET PACKAGE
-------------	--------------	------------------

FLX-T1	1/2"	50
FLX-T2	3/4"	50
FLX-T3	1"	25
FLX-T4	1 1/4"	10
FLX-T5	1 1/2"	10
FLX-T6	2"	5

**VİDALI KAPAKLI DİRSEK**  
90 °CAPPED CORNER PULL CORNER  
ELBOW (SCREW TYPE)



KOD CODE	EBAT SIZE	PAKET PACKAGE
FLX-341	1/2"	50
FLX-341	3/4"	50
FLX-351	1/2"	25
FLX-352	3/4"	10
FLX-353	1"	10
FLX-354	1 1/4"	5

**EMT TEK DELİKLİ KROŞE**  
STRAPS ONE HOLE



KOD CODE	EBAT SIZE	PAKET PACKAGE
FLX-531	1/2"	50
FLX-532	3/4"	50
FLX-533	1"	25
FLX-534	1 1/4"	10
FLX-535	1 1/2"	10
FLX-536	2"	5

**EMT ÇİFT DELİKLİ KROŞE**  
STRAPS TWO HOLES



KOD CODE	EBAT SIZE	PAKET PACKAGE
FLX-521	1/2"	50
FLX-522	3/4"	50
FLX-523	1"	25
FLX-524	1 1/4"	10
FLX-525	1 1/2"	10
FLX-526	2"	5

**BORU TAŞIMA KELEPÇESİ**  
CONDUIT HANGERS



KOD CODE	EBAT SIZE	PAKET PACKAGE
FLX-6011	1/2"	50
FLX-6012	3/4"	50
FLX-6013	1"	25
FLX-6014	1 1/4"	10
FLX-6015	1 1/2"	10
FLX-6016	2"	5

**TIRNAKLI BORU KELEPÇESİ**  
STRUT CLAMPS



KOD CODE	EBAT SIZE	PAKET PACKAGE
FLX-2101	1/2"	50
FLX-2102	3/4"	50
FLX-2103	1"	25
FLX-2104	1 1/4"	10
FLX-2105	1 1/2"	10
FLX-2106	2"	5

**SIKMALI TİP EK MUF**  
COMPRESSION TYPE COUPLING



KOD CODE	EBAT SIZE	PAKET PACKAGE
FLX-611	1/2"	50
FLX-612	3/4"	50
FLX-613	1"	25
FLX-614	1 1/4"	10
FLX-615	1 1/2"	10
FLX-616	2"	5

**SIKMALI TİP RAKOR**  
EMT & FLEXIBLE STEEL COND. CONN.  
ADAPTOR COMP. TYPE



KOD CODE	EBAT SIZE	PAKET PACKAGE
FLX-601	1/2"	50
FLX-602	3/4"	50
FLX-603	1"	25
FLX-604	1 1/4"	10
FLX-605	1 1/2"	10
FLX-606	2"	5

**KISAT ELEMANI & 90° DİRSEK**  
SHORT T CONNECTOR & ELBOW



KOD CODE	EBAT SIZE	PAKET PACKAGE
FLX-81	1/2"	50
FLX-91	1/2"	25

**VİDALI EMT-FLEX BAĞLANTI RAKORU**  
EMT FLEXIBLE STEEL CONDUIT  
CONNECTOR ADAPTER SCREW TYPE



KOD CODE	EBAT SIZE	PAKET PACKAGE
FLX-180	1/2"	50
FLX-181	3/4"	50
FLX-182	1"	25



**EMT KARE BUAT**  
**SQUARE JUNCTION BOX**

**102 X 102 X 38**

KOD CODE	EBAT SIZE	PAKET PACKAGE
-------------	--------------	------------------

FLX-52151	1/2'	50
FLX-52152	3/4'	50
FLX-52153	1/2'-3/4'	25
FLX-52C1	D.Kapak	10
FLX-52C6	Delikli	5

**EMT KARE DERİN BUAT**  
**SQUARE JUNCTION BOX**

**102 X 102 X 54**

KOD CODE	EBAT SIZE	PAKET PACKAGE
-------------	--------------	------------------

FLX-52171	1/2'	50
FLX-52172	3/4'	50
FLX-52173	1/2'-3/4'	25
FLX-52174	1'	10
FLX-52C1	D.Kapak	5
FLX-52C6	Delikli	

**SEKİZGEN KARE BUAT**  
**OCTAGONAL JUNCTION BOX**

**102 X 102 X 38**

KOD CODE	EBAT SIZE	PAKET PACKAGE
-------------	--------------	------------------

FLX-54151	1/2'	50
FLX-54152	3/4'	50
FLX-54153	1/2'-3/4'	25
FLX-54C1	D.Kapak	10
FLX-54C6	Delikli	5

**SEKİZGEN KARE BUAT**  
**OCTAGONAL JUNCTION BOX**

**102 X 102 X 54**

KOD CODE	EBAT SIZE	PAKET PACKAGE
-------------	--------------	------------------

FLX-54171	1/2'	50
FLX-54172	3/4'	50
FLX-54173	1/2'-3/4'	25
FLX-54C1	D.Kapak	10
FLX-54C6	Delikli	5

**EMT KARE BUAT DERİN**  
**SQUARE JUNCTION BOX**

**120 X 120 X 54**

KOD CODE	EBAT SIZE	PAKET PACKAGE
-------------	--------------	------------------

FLX-72171	1/2'-3/4'	50
FLX-72174	1'-3/4'	50
FLX-72C6	D.Kapak	10

**DİKDÖRTGEN BUAT**  
**RECTONGULAR BOX**

**102 X 54 X 48**

KOD CODE	EBAT SIZE	PAKET PACKAGE
-------------	--------------	------------------

FLX-58361	1/2'	50
FLX-58362	3/4'	50
FLX-58C1	D.Kapak	10

**BS KASA**  
**BS SWITCH BOX**

KOD CODE	EBAT SIZE	PAKET PACKAGE
-------------	--------------	------------------

FLX-33D1	TEKLİ	50
FLX-136D2	ÇİFTLİ	50

**C KANAL**

FLX-P40	40*40	50
FLX-P20	40*20	50

**ÇELİK SOMUN GALVANİZ KAPLI**  
**STEEL LOCKNUTS**

KOD CODE	EBAT SIZE	PAKET PACKAGE
-------------	--------------	------------------

FLX-301S	1/2'	50
FLX-302S	3/4'	50
FLX-303S	1'	25
FLX-304S	1 1/4'	10
FLX-305S	1 1/2'	10
FLX-306S	2'	5

**BORU BÜKME APARATI**  
**BENDER**

KOD CODE	EBAT SIZE	PAKET PACKAGE
-------------	--------------	------------------

FLX-840H	1/2'	50
FLX-841H	3/4'	50
FLX-842H	1'	25
FLX-843H	1 1/4'	10

PLASTİK ENTÜL  
PVC END CUP



KOD CODE	EBAT SIZE	PAKET PACKAGE
-------------	--------------	------------------

FLX-ENTUL1	1/2"	50
FLX-ENTUL2	3/4"	50
FLX-ENTUL3	1"	25
FLX-ENTUL4	1 1/4"	10
FLX-ENTUL5	1 1/2"	10
FLX-ENTUL6	2"	5

PLASTİK BUSHING  
PVC BUSHINGS



KOD CODE	EBAT SIZE	PAKET PACKAGE
-------------	--------------	------------------

FLX-281P	1/2"	50
FLX-282P	3/4"	50
FLX-283P	1"	25
FLX-284P	1 1/4"	10
FLX-285P	1 1/2"	10
FLX-286P	2"	5

METAL BUSHING  
METALLIC BUSHINGS



KOD CODE	EBAT SIZE	PAKET PACKAGE
-------------	--------------	------------------

FLX-281	1/2"	50
FLX-282	3/4"	50
FLX-283	1"	25
FLX-284	1 1/4"	10
FLX-285	1 1/2"	10
FLX-286	2"	5

GAZDİŞ LIQUIT TIGHT RAKOR  
LIQUID TIGHT CONNECTOR



KOD CODE	EBAT SIZE	PAKET PACKAGE
-------------	--------------	------------------

FLX-471	1/2"	50
FLX-472	3/4"	50
FLX-473	1"	25
FLX-474	1 1/4"	10
FLX-475	1 1/2"	10
FLX-476	2"	5

DPN-SPİRAL RAKORU DIŞLİ BORU TİPİ  
LIQUID TIGHT CONNECTOR



KOD CODE	EBAT SIZE	PAKET PACKAGE
-------------	--------------	------------------

FLX-380	1/2"	50
FLX-381	3/4"	50
FLX-382	1"	25
FLX-383	1 1/4"	10
FLX-384	1 1/2"	10
FLX-385	2"	5

DGJ-SPİRAL RAKORU VİDALI BORU TİPİ  
LIQUID TIGHT CONNECTOR



KOD CODE	EBAT SIZE	PAKET PACKAGE
-------------	--------------	------------------

FLX-390	1/2"	50
FLX-391	3/4"	50
FLX-392	1"	25
FLX-393	1 1/4"	10
FLX-394	1 1/2"	10
FLX-395	2"	5

METAL ENTÜL  
FERRULE



KOD CODE	EBAT SIZE	PAKET PACKAGE
-------------	--------------	------------------

FLX-472A	1/2"	50
FLX-473A	3/4"	50
FLX-474A	1"	25
FLX-475A	1 1/4"	10
FLX-476A	1 1/2"	10
FLX-477A	2"	5

TOPRAKLAMALI İZOLELİ METAL BUSHING (DÖKÜM)  
GROUNDING- INSULATED METAL BUSHING (CAST IRON)



KOD CODE	EBAT SIZE	PAKET PACKAGE
-------------	--------------	------------------

FLX-321	1/2"	50
FLX-322	3/4"	50
FLX-323	1"	25
FLX-324	1 1/4"	10
FLX-325	1 1/2"	10
FLX-326	2"	5

RONDELA  
REDUSING WASHER



KOD CODE	EBAT SIZE	PAKET PACKAGE
-------------	--------------	------------------

FLX-900	3/4-1/2"	50
FLX-901	1-1/2"	50
FLX-922	1-3/4"	25

**Ç. SİRİRAL RAKORU VİDALI**  
**EMT&FLEXIBLE STEEL CONDUIT**  
**CONNECTOR ADAPTER SCREW TYPE**

KOD CODE	EBAT SIZE	PAKET PACKAGE
-------------	--------------	------------------

FLX-151	1/2'	50
FLX-152	3/4'	50
FLX-153	1'	25
FLX-154	1 1/4'	10
FLX-155	1 1/2'	10
FLX-156	2'	5

**90 Ç. SİRİRAL RAKORU VİDALI**  
**90° STRAIGHT SQUEEZE**

KOD CODE	EBAT SIZE	PAKET PACKAGE
-------------	--------------	------------------

FLX-101	1/2'	50
FLX-102	3/4'	50
FLX-103	1'	25
FLX-104	1 1/4'	10
FLX-105	1 1/2'	10
FLX-106	2'	5

**SİRİRAL-SİRİRAL EK MUFU**  
**FLEX COUPLINGS**

KOD CODE	EBAT SIZE	PAKET PACKAGE
-------------	--------------	------------------

FLX-461	1/2'	50
FLX-462	3/4'	50
FLX-451	1/2'	10
FLX-453	3/4'	5

**90° HARİCİ TİP SİRİRAL BORU RAKORU**  
**90° LIQUID TIGHT CONNECTOR**

KOD CODE	EBAT SIZE	PAKET PACKAGE
-------------	--------------	------------------

FLX-491	1/2'	50
FLX-492	3/4'	50
FLX-493	1'	25
FLX-494	1 1/4'	10
FLX-495	1 1/2'	10
FLX-496	2'	5

**IMC BORU**  
**INTERMEDIATE METAL CONDUIT**

KOD CODE	EBAT SIZE	PAKET PACKAGE
-------------	--------------	------------------

FLX-IMC 1/2	1/2'	10
FLX-IMC 3/4	3/4'	10
FLX-IMC 1/2	1'	5
FLX-IMC 1 1/4	1 1/4'	5
FLX-IMC 1 1/2	1 1/2'	5
FLX-IMC 2	2'	3

**RSC BORU**  
**RIGID STEEL CONDUIT**

KOD CODE	EBAT SIZE	PAKET PACKAGE
-------------	--------------	------------------

FLX-RSC 1/2	1/2'	10
FLX-RSC 3/4	3/4'	10
FLX-RSC 1/2	1'	5
FLX-RSC 1 1/4	1 1/4'	5
FLX-RSC 1 1/2	1 1/2'	5
FLX-RSC 2	2'	3

**ÇELİK MANŞON**  
**COUPLING**

KOD CODE	EBAT SIZE	PAKET PACKAGE
-------------	--------------	------------------

FLX-51	1/2'	50
FLX-52	3/4'	50
FLX-53	1'	25
FLX-54	1 1/4'	10
FLX-55	1 1/2'	10
FLX-56	2'	5

**IMC-RSC 90° DİRSEK**  
**IMC-RSC 90° ELBOW**

KOD CODE	EBAT SIZE	BAĞ-BOY ADEDİ QUANTITY PER BUNDLE (PCS)
-------------	--------------	---

FLX-61	1/2'	10
FLX-62	3/4'	10
FLX-63	1'	10
FLX-64	1 1/4'	5
FLX-65	1 1/2'	5
FLX-66	2'	3

**IMC-RSC TEK DELİKLİ KROŞE**  
**STRAPS ONE HOLE/IMC RSC**

KOD CODE	EBAT SIZE	PAKET PACKAGE
-------------	--------------	------------------

FLX-551	1/2'	50
FLX-552	3/4'	50
FLX-553	1'	25
FLX-554	1 1/4'	10
FLX-555	1 1/2'	10
FLX-556	2'	5

IMC-RSC ÇİFT DELİKLİ KROŞE  
STRAPS TWO HOLES IMC/RSC



KOD CODE	EBAT SIZE	PAKET PACKAGE
-------------	--------------	------------------

FLX-561	1/2'	50
FLX-562	3/4'	50
FLX-563	1'	25
FLX-564	1 1/4'	10
FLX-565	1 1/2'	10
FLX-566	2'	5

HARİCİ BUAT TEKLİ  
ONE GANG WEATHERPROOF BOXES



KOD CODE	EBAT SIZE	PAKET PACKAGE
-------------	--------------	------------------

FLX-SB50-3	1/2'	50
FLX-SB75-3	3/4'	50
FLX-SB75-4	3/4'	25
FLX-SB50-5	1/2'	10
FLX-SB75-5	3/4'	10
FLX-BC-A	A.Kapak	5

HARİCİ BUAT ÇİFTLİ  
TWO GANG WEATHERPROOF BOXES



KOD CODE	EBAT SIZE	PAKET PACKAGE
-------------	--------------	------------------

FLX-GB50-3	1/2'	50
FLX-GB75-3	3/4'	50
FLX-GB50-5	1/2'	25
FLX-GB75-5	3/4'	10
FLX-B100-5	1'	10
FLX-BC-A	A.Kapak	5

3 PARÇALI MUF (DİŞLİ BUAT HUB)  
3 PIECES COUPLINGS



KOD CODE	EBAT SIZE	PAKET PACKAGE
-------------	--------------	------------------

FLX-B1	1/2'	50
FLX-B2	3/4'	50
FLX-B3	1'	25
FLX-B4	1 1/4'	10
FLX-B5	1 1/2'	10
FLX-B6	2'	5

3 PARÇALI MUF  
3 PIECES COUPLING



KOD CODE	EBAT SIZE	PAKET PACKAGE
-------------	--------------	------------------

FLX-851	1/2'	50
FLX-852	3/4'	50
FLX-853	1'	25
FLX-854	1 1/4'	10
FLX-855	1 1/2'	10
FLX-856	2'	5

HARİCİ YUVARLAK BUAT  
4" ROUND EXTENSION & RINGS BOX



KOD CODE	EBAT SIZE	PAKET PACKAGE
-------------	--------------	------------------

FLX-50-5	1/2'	50
FLX-75-5	3/4'	50
FLX-C1	Kapak	5

REDÜKSİYON - REDUCING BUSHINGS



KOD CODE	EBAT SIZE	PAKET PACKAGE
-------------	--------------	------------------

FLX-2	3/4-1/2	50
FLX-3	1-1/2	50
FLX-4	1-3/4	25
FLX-5	1 1/4-1/2	10
FLX-6	1 1/4-3/4	10
FLX-7	1 1/4-1	5

KOD CODE	EBAT SIZE	PAKET PACKAGE
-------------	--------------	------------------

FLX-8	1 1/2-1/2	50
FLX-9	1 1/2-3/4	50
FLX-10	1 1/2-1	25
FLX-11	1 1/2-1 1/4	10
FLX-12	2-1/2	10
FLX-13	2-3/4	5

KOD CODE	EBAT SIZE	PAKET PACKAGE
-------------	--------------	------------------

FLX-14	2-1'	50
FLX-15	2-1 1/4	50
FLX-16	2-1 1/2	25

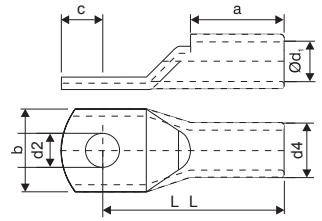

## STANDART TİP BAKIR KABLO PABUÇLARI - COPPER CABLE LUNGS STANDARD TYPE

KOD CODE	b	d2	L	c	L+c	a	d1	d4	KUTU ADET BOX PIECE
FLX-6 S	8,5	M5	20,0	6,0	26,0	10,5	4,0	5,5	1000
FLX-10 S	9,0	M5	22,5	6,5	29,0	12,0	5,0	6,5	800
FLX-10 S	12,5	M6	22,5	6,5	29,0	12,0	5,0	6,5	800
FLX-10 S	14,0	M8	22,5	6,5	29,0	12,0	5,0	6,5	800
FLX-16 S	11,0	M6	26,5	7,5	34,0	15,0	5,5	7,5	500
FLX-16 S	13,5	M8	26,5	7,5	34,0	15,0	5,5	7,5	500
FLX-16 S	14,5	M10	26,5	7,5	40,0	15,0	5,5	7,5	500
FLX-25 S	13,5	M6	30,5	8,5	39,5	17,0	7,0	9,5	350
FLX-25 S	13,5	M8	30,5	8,5	39,5	17,0	7,0	9,5	350
FLX-25 S	15,5	M10	30,5	8,5	39,5	17,0	7,0	9,5	350
FLX-35 S	16,0	M6	36,0	9,5	45,5	19,0	8,5	11,0	200
FLX-35 S	16,0	M8	36,0	9,5	45,5	19,0	8,5	11,0	200
FLX-35 S	17,0	M10	36,0	9,5	45,5	19,0	8,5	11,0	200
FLX-35 S	18,0	M12	36,0	9,5	45,5	19,0	8,5	11,0	200
FLX-50 S	18,5	M8	40,0	11,5	51,5	20,5	10,0	11,0	150
FLX-50 S	18,5	M10	40,0	11,5	51,5	20,5	10,0	13,0	150
FLX-50 S	19,0	M12	40,0	11,5	51,5	20,5	10,0	13,0	150
FLX-50 S	20,5	M14	40,0	11,5	51,5	20,5	10,0	13,0	150
FLX-70 S	21,0	M10	44,0	12,0	56,0	24,5	11,5	14,5	100
FLX-70 S	21,0	M12	44,0	12,0	56,0	24,5	11,5	14,5	100
FLX-70 S	23,0	M14	44,0	12,0	56,0	24,5	11,5	14,5	100
FLX-95 S	24,0	M10	50,5	12,5	63,0	27,5	13,5	16,5	75
FLX-95 S	24,0	M12	50,5	12,5	63,0	27,5	13,5	16,5	75
FLX-95 S	24,0	M14	50,5	12,5	63,0	27,5	13,5	16,5	75
FLX-95 S	24,0	M16	50,5	12,5	63,0	27,5	13,5	16,5	75
FLX-120 S	26,5	M10	55,0	14,0	69,0	30,0	15,5	19,0	50
FLX-120 S	26,5	M12	55,0	14,0	69,0	30,0	15,5	19,0	50
FLX-120 S	26,5	M14	55,0	14,0	69,0	30,0	15,5	19,0	50
FLX-120 S	26,5	M16	55,5	14,0	69,0	30,0	15,5	19,0	50
FLX-150 S	30,5	M12	61,5	16,0	77,5	33,0	16,5	21,0	40
FLX-150 S	30,5	M14	61,5	16,0	77,5	33,0	16,5	21,0	40
FLX-150 S	30,5	M16	61,5	16,0	77,5	33,0	16,5	21,0	40
FLX-185 S	33,5	M10	68,0	16,5	84,5	37,5	18,5	23,0	30
FLX-185 S	33,5	M12	68,0	16,5	84,5	37,5	18,5	23,0	30
FLX-185 S	33,5	M14	68,0	16,5	84,5	37,5	18,5	23,0	30
FLX-185 S	33,5	M16	68,0	16,5	84,5	37,5	18,5	23,0	30
FLX-240 S	38,0	M10	76,0	17,0	93,0	41,5	21,0	26,0	25
FLX-240 S	38,0	M12	76,0	17,0	93,0	41,5	21,0	26,0	25
FLX-240 S	38,0	M14	76,0	17,0	93,0	41,5	21,0	26,0	25
FLX-240 S	38,0	M16	76,0	17,0	93,0	41,5	21,0	26,0	25
FLX-300 S	41,0	M16	79,0	18,0	98,0	44,0	23,5	28,5	20
FLX-400 S	48,0	M16	89,0	25,0	110,0	50,0	27,0	33,0	15

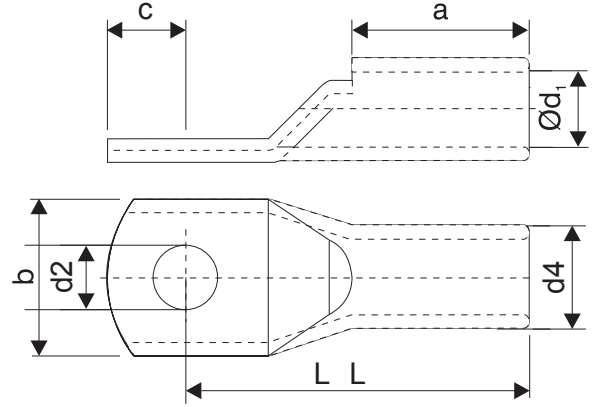

**EKONOMİK TİP BAKIR KABLO PABUÇLARI - COPPER CABLE LUNGS ECO TYPE**

KOD CODE	b	d2	L	c	L+c	a	d1	d4	KUTU ADET BOX PIECE
FLX-16 E	10,5	M 6	24,0	7,5	31,5	12,5	5,7	7,2	500
FLX-16 E	10,5	M 8	24,0	7,5	31,5	12,5	5,7	7,2	500
FLX-25 E	13,0	M 8	31,0	8,5	39,5	17,5	7,0	9,0	350
FLX-35 E	15,5	M 8	34,0	9,5	43,5	17,5	8,5	10,5	200
FLX-50 E	18,0	M 10	40,5	11,0	51,5	21,0	10,0	12,0	150
FLX-70 E	20,5	M 10	44,0	12,0	56,0	24,0	11,5	14,0	100
FLX-95 E	23,5	M 12	48,5	12,5	61,0	25,5	13,5	16,0	75
FLX-120 E	26,5	M 12	55,0	14,0	69,0	30,0	15,5	18,0	50
FLX-150 E	29,5	M 12	61,5	16,5	77,5	37,0	16,5	20,0	40
FLX-185 E	32,5	M 16	67,5	16,5	84,5	41,0	18,5	22,0	30
FLX-240 E	37,0	M 16	76,5	16,5	93,0	45,0	21,5	25,0	25

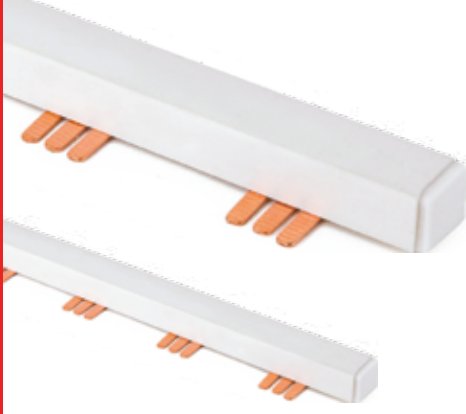
**TRİFAZE BARALAR - 3 PHASE W AUTOMAT BUSBARS**

KOD - CODE	ÜRÜN - PRODUCT	PAKET - PACKAGE (PCS)
F15.1001	53 cm 1 mm 63 A	25
F15.1002	106 cm 1 mm 63 A	25
F15.1003	53 cm 1 mm 80 A	25
F15.1004	106 cm 1 mm 80 A	25
F15.1005	53 cm 1,5 mm 125 A	25
F15.1006	106 cm 1,5 mm 125 A	25

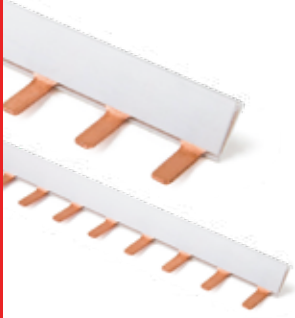
**MONOFAZE BARALAR - 1 PHASE W AUTOMAT BUSBARS**

KOD - CODE	ÜRÜN - PRODUCT	PAKET - PACKAGE (PCS)
F15.2001	53 cm 1 mm 63 A	50
F15.2002	106 cm 1 mm 63 A	50
F15.2003	53 cm 1,5 mm 80 A	50
F15.2004	106 cm 1,5 mm 80 A	50

**TOPRAKLAMA BARALARI - NEUTRAL GROUNDED BUSBAR**

KOD - CODE	ÜRÜN - PRODUCT	PAKET - PACKAGE (PCS)
F15.3001	1,5 mm 31 Vida Topraklama Barası	40
F15.3002	1,5 mm 61 Vida Topraklama Barası	40
F15.3003	2 mm 31 Vida Topraklama Barası	40
F15.3004	2 mm 61 Vida Topraklama Barası	40

**W OTOMAT RAYI - MOUNTING DIN RAILS**

KOD - CODE	EBAT SIZE MM	PAKET PACKAGE PCS
F15.4001	1 MT	200
F15.4002	2 MT	200



# KELEPÇELER VE KABLO BAĞLARI

CLAMPS & CABLE TIES





**DOĞALGAZ BORU KELEPÇELERİ - RUBBER PIPE CLAMP WITH NUT CONNECTOR**

KOD - CODE	EBAT SIZE MM	KUTU ADET - BOX
FLX5W1-015019-01EP01	3/8"	270
FLX6W1-021026-01EP00	1/2"	250
FLX6W1-026030-01EP00	3/4"	200
FLX6W1-033037-01EP00	1"	150
FLX6W1-040046-01EP00	1 1/4"	120
FLX6W1-048053-01EP00	1 1/2"	90
FLX6W1-060066-01EP00	2"	70
FLX6W1-075084-02EP00	2 1/2"	80
FLX2W1-083093-02EP01	3"	75
FLX6W1-109119-02EP00	4"	50
FLX6W1-122135-02EP00	4 1/2"	35
FLX2W1-133143-02EP01	5"	35
FLX2W1-159169-02EP01	6"	25
FLX6W1-207218-02EP00	8"	25

**STANDART TRİFONLU DOĞALGAZ KELEPÇESİ**  
 RUBBER PIPE CLAMPS WITH STANDARD TRIPHON

KOD - CODE	EBAT SIZE MM	KUTU ADET BOX
FLX2W1-015019-07EP01	3/8"	200
FLX6W1-021026-07EP00	1/2"	170
FLX6W1-026030-07EP00	3/4"	150
FLX6W1-033037-07EP00	1"	120
FLX6W1-040046-07EP00	1 1/4"	90
FLX6W1-048053-07EP00	1 1/2"	80
FLX6W1-060066-07EP00	2"	60
FLX6W1-075084-07EP00	2 1/2"	80

**UZUN TRİFONLU DOĞALGAZ KELEPÇESİ**  
 RUBBER PIPE CLAMPS WITH LONG TRIPHON

KOD - CODE	EBAT SIZE MM	KUTU ADET BOX
FLX2W1-015019-08EP01	3/8"	170
FLX6W1-021026-08EP00	1/2"	150
FLX6W1-026030-08EP00	3/4"	120
FLX6W1-033037-08EP00	1"	100
FLX6W1-040046-08EP00	1 1/4"	80
FLX6W1-048053-08EP00	1 1/2"	70
FLX6W1-060066-08EP00	2"	50
FLX6W1-075084-08EP00	2 1/2"	70
FLX6W1-087096-08EP00	3"	50
FLX6W1-109119-08EP00	4"	50



S/STEEL RUBBER LINED PIPE CLAMPS

MALZEME MATERIAL	12	15	20	25
	MM	MM	MM	MM
BAĞLANTI KELEPÇESİ	Ø6-Ø10	Ø6-Ø10	Ø6-Ø10	
BAĞLANTI KELEPÇESİ	Ø11-Ø20	Ø11-Ø20	Ø11-Ø20	Ø11-Ø20
BAĞLANTI KELEPÇESİ	Ø21-Ø30	Ø21-Ø30	Ø21-Ø30	Ø21-Ø30
BAĞLANTI KELEPÇESİ	Ø31-Ø40	Ø31-Ø40	Ø31-Ø40	Ø31-Ø40
BAĞLANTI KELEPÇESİ	Ø41-Ø50	Ø41-Ø50	Ø41-Ø50	Ø41-Ø50
BAĞLANTI KELEPÇESİ	Ø51-Ø60	Ø51-Ø60	Ø51-Ø60	Ø51-Ø60
BAĞLANTI KELEPÇESİ	Ø61-Ø70	Ø61-Ø70	Ø61-Ø70	Ø61-Ø70
BAĞLANTI KELEPÇESİ	Ø71-Ø80	Ø71-Ø80	Ø71-Ø80	Ø71-Ø80
BAĞLANTI KELEPÇESİ	Ø81-Ø90	Ø81-Ø90	Ø81-Ø90	Ø81-Ø90
BAĞLANTI KELEPÇESİ	Ø91-Ø100	Ø91-Ø100	Ø91-Ø100	Ø91-Ø100
BAĞLANTI KELEPÇESİ	Ø101-Ø110	Ø101-Ø110	Ø101-Ø110	Ø101-Ø110
BAĞLANTI KELEPÇESİ	Ø111-Ø120	Ø111-Ø120	Ø111-Ø120	Ø111-Ø120
BAĞLANTI KELEPÇESİ	Ø121-Ø130	Ø121-Ø130	Ø121-Ø130	Ø121-Ø130

ÇAP - DIAMETER (MM)

Miktar: Min. 500 Adet

MALZEME : DIN 3016 (W1)

LASTİK : EPDM



# AĞIR HİZMET KELEPÇELERİ

HEAVY DUTY HOSE CLAMPS



KOD CODE	EBAT DIAMETER	BANT GENİŞLİĞİ BAND WIDTH	KUTU ADET PCS INSIDE BOX
	MM	MM	
FLX018W1-017019-01	17-19	18	200
FLX018W1-019021-01	19-21	18	200
FLX018W1-021023-01	21-23	18	200
FLX018W1-023025-01	23-25	18	200
FLX018W1-025027-01	25-27	18	200
FLX018W1-027029-01	27-29	18	200
FLX020W1-029031-01	29-31	20	100
FLX020W1-031034-01	31-34	20	100
FLX020W1-034037-01	34-37	20	100
FLX020W1-037040-01	37-40	20	100
FLX020W1-040043-01	40-43	20	100
FLX020W1-043047-01	43-47	20	100
FLX020W1-047051-01	47-51	20	50
FLX020W1-051055-01	51-55	20	50
FLX020W1-055059-01	55-59	20	50
FLX020W1-056061-01	56-61	20	50
FLX020W1-059063-01	59-63	20	50
FLX020W1-063068-01	63-68	20	50
FLX025W1-068073-01	68-73	25	50
FLX025W1-073079-01	73-79	25	50
FLX025W1-079085-01	79-85	25	50
FLX025W1-085091-01	85-91	25	50
FLX025W1-091097-01	91-97	25	50
FLX025W1-097104-01	97-104	25	50
FLX025W1-104112-01	104-112	25	50
FLX025W1-112121-01	112-121	25	50
FLX025W1-121130-01	121-130	25	50
FLX030W1-130140-01	130-140	30	25
FLX030W1-140150-01	140-150	30	25
FLX030W1-150162-01	150-162	30	25
FLX030W1-162174-01	162-174	30	25
FLX030W1-174187-01	174-187	30	25
FLX030W1-187200-01	187-200	30	25
FLX030W1-200213-01	200-213	30	25
FLX030W1-213226-01	213-226	30	25
FLX030W1-226239-01	226-239	30	25
FLX030W1-239252-01	239-252	30	25

**304 KALİTE**



**TEKNİK ÖZELLİKLER**

<b>Malzeme</b>	:	304 Paslanmaz Çelik
<b>Su Emilimi</b>	:	Yok
<b>Alev Yürümeme</b>	:	UL94V-2
<b>UV Dayanıklılığı</b>	:	Mükemmel
<b>Kimyasal Dayanıklılık</b>	:	Mükemmel
<b>Çalışma Sıcaklığı</b>	:	-80°C + 538°C

KOD CODE	EBAT SIZE	MALZEME MATERIAL	SIKMA ÇAPI TIGHTENING DIAMETER	AÇILMA MUAVEMETİ TENSILE STRENGTH	POŞET MİKTARI PCS/NYLON BAG	KOLİ MİKTARI PCS/CARTON
LxW						
FLX-150-46-W4	150x4.6	SS304	33	55	100	8.000
FLX-200-46-W4	200x4.6	SS304	50	55	100	6.000
FLX-250-46-W4	250x4.6	SS304	67	55	100	5.000
FLX-300-46-W4	300x4.6	SS304	75	55	100	5.000
FLX-370-46-W4	370x4.6	SS304	102	55	100	4.000
FLX-450-46-W4	450x4.6	SS304	130	55	100	3.000
FLX-520-46-W4	520x4.6	SS304	152	55	100	3.000
FLX-680-46-W4	680x4.6	SS304	203	55	100	2.000
FLX-840-46-W4	840x4.6	SS304	254	55	100	1.000
FLX-200-79-W4	200x79	SS304	50	120	100	5.000
FLX-300-79-W4	300x79	SS304	75	120	100	4.000
FLX-370-79-W4	370x79	SS304	102	120	100	3.000
FLX-450-79-W4	450x79	SS304	130	120	100	3.000
FLX-520-79-W4	520x79	SS304	152	120	100	2.000
FLX-680-79-W4	680x79	SS304	203	120	100	2.000
FLX-840-79-W4	840x79	SS304	254	120	100	1.000
FLX-1000-79-W4	1000x79	SS304	305	120	100	1.000

**316 KALİTE**



**TEKNİK ÖZELLİKLER**

<b>Malzeme</b>	:	316 Paslanmaz Çelik
<b>Su Emilimi</b>	:	Yok
<b>Alev Yürümeme</b>	:	UL94V-2
<b>UV Dayanıklılığı</b>	:	Mükemmel
<b>Kimyasal Dayanıklılık</b>	:	Mükemmel
<b>Çalışma Sıcaklığı</b>	:	-80°C + 538°C

KOD CODE	EBAT SIZE	MALZEME MATERIAL	SIKMA ÇAPI TIGHTENING DIAMETER	AÇILMA MUAVEMETİ TENSILE STRENGTH	POŞET MİKTARI PCS/NYLON BAG	KOLİ MİKTARI PCS/CARTON
LxW						
FLX-150-46-W5	150x4.6	SS316	33	55	100	8.000
FLX-200-46-W5	200x4.6	SS316	50	55	100	6.000
FLX-250-46-W5	250x4.6	SS316	67	55	100	5.000
FLX-300-46-W5	300x4.6	SS316	75	55	100	5.000
FLX-370-46-W5	370x4.6	SS316	102	55	100	4.000
FLX-450-46-W4	450x4.6	SS304	130	55	100	3.000
FLX-520-46-W5	520x4.6	SS316	152	55	100	3.000
FLX-680-46-W5	680x4.6	SS316	203	55	100	2.000
FLX-840-46-W5	840x4.6	SS316	254	55	100	1.000
FLX-200-79-W5	200x79	SS316	50	120	100	5.000
FLX-300-79-W5	300x79	SS316	75	120	100	4.000
FLX-370-79-W5	370x79	SS316	102	120	100	3.000
FLX-450-79-W4	450x79	SS304	130	120	100	3.000
FLX-520-79-W5	520x79	SS316	152	120	100	2.000
FLX-680-79-W5	680x79	SS316	203	120	100	2.000
FLX-840-79-W5	840x79	SS316	254	120	100	1.000
FLX-1000-79-W	1000x79	SS316	305	120	100	1.000



Fleks standart kablo bağları plastikler içerisinde en dayanıklısı olarak bilinen Polyamide 6.6 malzemeden üretilmektedir. Yarı kristal yapısı sayesinde yüksek mukavemete ve sertliğe sahiptir. Bu yapısal özellikleri sayesinde Fleks standart kablo bağları çok yüksek eğilme ve çekme dayanımına, düşük sürtünme katsayısına sahip olması sebebiyle yük altında çalışmaya en uygun malzemedir.

Siyah renkli Fleks kablo bağları içerisindeki karbon siyah katkı ile dış alan uygulamalarında UV dayanımı sağlayarak güneş ışınlarına karşı mükemmel koruma sağlamaktadır.

#### Sertifikalar

Reach, Rohs, Halogen free,

- Yalnızca doğada geri dönüştürülebilir yüksek kalitede plastik
- Geniş malzeme, boy ve renk çeşitliliği
- Düşük uygulama kuvveti ile yüksek kopma dayanımı
- Uygulanan alanı daha sıkı kavramaya yarayan tırtıklı iç yüzey
- Uygulama kolaylığı sağlayan kenar yüzey eğimi
- Manuel olarak veya aparat ile kolay uygulama

#### Teknik Özellikler

- Ham madde: Polyamide 6.6
- Nem Emilimi: %2.7 (%50 bağıl nem)
- Çalışma sıcaklığı: -40°C +85°C
- Uygulama sıcaklığı: -10°C +60°C
- Yanma derecesi: UL 94 class V2
- Halojensiz: Evet

#### Uygulama Alanları

- Elektrik Endüstrisi
- Endüstriyel kablolama
- Otomotiv
- Enerji sektörü
- Yapı ve inşaat sektörü



Fleks standard cable ties are produced from Polyamide 6.6 material, which is known as the most durable of plastics. It has high strength and hardness thanks to its semi-crystalline structure. These structural features make Fleks standard cable ties the most suitable material to use under loads due to their very high bending and tensile strength and low friction coefficient.

Black-colored Fleks cable ties provide excellent protection against sunlight with UV resistance in outdoor applications with the carbon black additive inside

#### Certifications

Reach, Rohs, Halogen free,

- Only high quality plastic that can be recycled in nature is used
- Wide variety of materials, sizes and colors
- High tensile strength with low application force
- Serrated inner surface to grip the application area more tightly
- Edge surface slope for easy application
- Easy application manually or with apparatus

#### Technical Specifications

- Raw material: Polyamide 6.6
- Moisture Absorption: 2.7% (50% relative humidity)
- Working temperature: -40 °C + 85 °C
- Application temperature: -10 °C + 60 °C
- Combustion degree: UL 94 class V2
- Halogen free: Yes

#### Application Areas

- Electricity Industry
- Industrial cabling
- Automotive
- Energy sector
- Building and construction sector

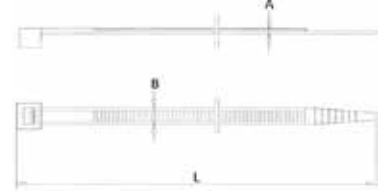

## STANDART KABLO BAĞLARI - STANDARD CABLE TIES

### ÖLÇÜ - SIZE

KOD CODE	UZUNLUK LENGTH (L)	GENİŞLİK LENGTH (B)	BANT KALINLIĞI STRIP THICKNESS (A)	RENK COLOUR	MAX DAYANIM GÜCÜ MAX TENSILE STRENGTH		POŞET İÇİ ADEDİ QUANTITY IN A NYLON BAG	KARTON İÇİ ADEDİ QUANTITY IN A CARTON BOX	
					SIKMA ÇAPINI TIGHTENING DIAMETER	MAX Ø MM			KG / F
FLX-100-25-W/B	100	2.5	1.0			22	8	100	26.000
FLX-150-25-W/B	150	2.5	1.0	B	S	35	8	100	20.000
FLX-200-25-W/B	200	2.5	1.0			50	8	100	18.000
FLX-100-36-W/B	100	3.5	1.2	E	İ	22	18	100	12.000
FLX-140-36-W/B	140	3.5	1.2			31	18	100	12.000
FLX-200-36-W/B	200	3.5	1.2	Y	Y	50	18	100	10.000
FLX-250-36-W/B	250	3.5	1.2			65	18	100	8.000
FLX-280-36-W/B	280	3.5	1.2	A	A	74	18	100	8.000
FLX-300-36-W/B	300	3.5	1.2			79	18	100	8.000
FLX-370-36-W/B	370	3.5	1.2	Z	H	98	18	100	6.000
FLX-200-48-W/B	200	4.5	1.3			50	22	100	7.000
FLX-250-48-W/B	250	4.5	1.3			65	22	100	6.000
FLX-300-48-W/B	300	4.5	1.3			80	22	100	5.000
FLX-370-48-W/B	370	4.5	1.3	-	-	98	22	100	4.000
FLX-430-48-W/B	430	4.5	1.3			120	22	100	3.000
FLX-200-76-W/B	200	7.5	1.5			50	55	100	4.000
FLX-300-76-W/B	300	7.5	1.5			75	55	100	3.000
FLX-370-76-W/B	370	7.5	1.5	W	B	98	55	100	2.500
FLX-450-76-W/B	450	7.5	1.5			120	55	100	2.000
FLX-550-76-W/B	550	7.5	1.5	H	L	155	55	100	1.500
FLX-750-76-W/B	750	7.5	1.5	I	A	220	55	100	1.200
FLX-600-90-W/B	600	9.0	1.6			165	80	100	1.200
FLX-710-90-W/B	710	9.0	1.6			205	80	100	1.200
FLX-760-90-W/B	760	9.0	1.6			220	80	100	1.200
FLX-900-90-W/B	900	9.0	1.6	E	K	260	80	100	1.200
FLX-1200-90-W/B	1200	9.0	1.6			370	80	100	1.000



## ABS VE POLİKARBON KUTULAR SIVA ÜSTÜ VE SIVA ALTI SİĞORTA KUTULARI

ABS AND POLYCARBONATE BOXES  
SURFACE MOUNTED AND FLUSH MOUNTED FUSE BOXES



IP65



IK10



HALOGEN  
FREE

[www.fleks.com.tr](http://www.fleks.com.tr)

**ABS OPAK KAPAKLI PANO - ABS ENCLOSURE OPAQUE**

KOD - CODE	EBAT - SIZE MM	AĞIRLIK - WEIGHT Kg	HACİM - VOLUME M <sup>3</sup>	KUTU - PACKAGE (PCS)
F191001	200x300x130 mm	1,25	0,084	1
F191002	250x350x150 mm	1,78	0,014	1
F191003	300x400x170 mm	2,45	0,021	1
F191004	300x400x220 mm	2,80	0,027	1
F191005	350x500x190 mm	3,40	0,034	1
F191006	400x500x180 mm	3,75	0,037	1
F191007	400x500x240 mm	4,35	0,049	1
F191008	400x600x200 mm	4,75	0,049	1
F191009	500x700x250 mm	7,70	0,088	1
F191010	600x800x260 mm	12,50	0,125	1
F191011	500x600x220 mm	6,75	0,067	1

**ABS ŞEFFAF KAPAKLI PANO - ABS ENCLOSURE TRANSPARENT**

KOD - CODE	EBAT - SIZE MM	AĞIRLIK - WEIGHT Kg	HACİM - VOLUME M <sup>3</sup>	KUTU - PACKAGE (PCS)
F192001	200x300x130 mm	1,30	0,084	1
F192002	250x350x150 mm	1,82	0,014	1
F192003	300x400x170 mm	2,55	0,021	1
F192004	300x400x220 mm	2,90	0,027	1
F192005	350x500x190 mm	3,50	0,034	1
F192006	400x500x180 mm	3,85	0,037	1
F192007	400x500x240 mm	4,46	0,049	1
F192008	400x600x200 mm	5,00	0,049	1
F192009	500x700x250 mm	8,10	0,88	1
F192010	600x800x260 mm	12,35	0,125	1
F192011	500x600x220 mm	6,85	0,067	1



**ÖZELLİKLER - FEATURES**

ABS Junction Boxes  
Material: ABS (Ral 7035 Grey)  
Heating Strength : -40 °C / +80 °C  
Unbreakable  
650C glow wire test for standart type  
960C glow wire test for HF type  
Stainless steel screws for cover  
Cable entries via 6 PG 16, PG 21 knock outs  
Perfect sealing with inside pass

**ABS DAĞITIM BUATLARI OPAK KAPAKLI - ABS JUNCTION BOXES OPAQUE**

**IP65**

KOD - CODE	EBAT - SIZE (MM)	KUTU BOX (PCS)	M <sup>3</sup>	KG
F21.1001	85x85x40 mm	240	0,087	11,80
F21.1002	85x85x50 mm	240	0,092	13,50
F21.1003	110x110x74 mm	130	0,135	20,60
F21.1004	210x120x74 mm	48	0,115	14,80
F21.1005	280x210x74 mm	34	0,150	15,25
F21.1006	80x120x55 mm	96	0,070	14,10
F21.1007	120x150x80 mm	30	0,060	7,60
F21.1008	150x150x80 mm	30	0,072	8,60
F21.1009	190x150x80 mm	30	0,089	10,00
F21.1010	200x200x80 mm	24	0,100	10,25

**DERİN ABS DAĞITIM BUATLARI OPAK KAPAKLI - JUNCTION BOX DEEP SERIE OPAQUE**

**IP65**

KOD - CODE	EBAT - SIZE MM	KUTU BOX (PCS)	M <sup>3</sup>	KG
F21.1011	80x120x120 mm	39	0,058	8,100
F21.1012	110x110x120 mm	80	0,135	16,100
F21.1013	120x150x140 mm	18	0,058	5,870
F21.1014	150x150x140 mm	18	0,093	6,810
F21.1015	190x150x140 mm	18	0,088	8,275
F21.1016	210x120x160 mm	24	0,119	9,970
F21.1017	200x200x160 mm	12	0,094	7,400
F21.1018	280x210x160 mm	12	0,146	13,000





## ABS DAĞITIM BUATLARI ŞEFFAF KAPAKLI - ABS JUNCTION BOX TRANSPARENT

IP65

KOD - CODE	EBAT - SIZE MM	M <sup>3</sup>	KG	RENK - COLOR	KUTU - BOX
F22.1001	80x120x55 mm	0,088 m <sup>3</sup>	9,950 Kg.	Gri - Grey	96
F22.1002	110x110x74 mm	0,135 m <sup>3</sup>	20,600 Kg.	Gri - Grey	96
F22.1003	120x150x80 mm	0,060 m <sup>3</sup>	7,600 Kg.	Gri - Grey	30
F22.1004	150x150x80 mm	0,071 m <sup>3</sup>	9,000 Kg.	Gri - Grey	30
F22.1005	190x150x80 mm	0,088 m <sup>3</sup>	9,950 Kg.	Gri - Grey	30
F22.1006	210x120x74 mm	0,115 m <sup>3</sup>	14,80 Kg.	Gri - Grey	48
F22.1007	200x200x80 mm	0,100 m <sup>3</sup>	10,230 Kg.	Gri - Grey	24
F22.1008	260x150x80 mm	0,115 m <sup>3</sup>	19,90 Kg.	Gri - Grey	40
F22.1009	280x210x74 mm	0,146 m <sup>3</sup>	14,100 Kg.	Gri - Grey	24
F22.1010	380x280x90 mm	0,140 m <sup>3</sup>	13,000 Kg.	Gri - Grey	14



## DERİN ABS DAĞITIM BUATLARI ŞEFFAF KAPAKLI - DEEP ABS JUNCTION BOX TRANSPARENT

IP65

KOD - CODE	EBAT - SIZE MM	M <sup>3</sup>	KG	RENK - COLOR	KUTU - BOX
F22.1011	80x120x120 mm	0,058 m <sup>3</sup>	8,100 Kg.	Gri - Grey	39
F22.1012	110x110x120 mm	0,135 m <sup>3</sup>	16,100 Kg.	Gri - Grey	80
F22.1013	120x150x140 mm	0,058 m <sup>3</sup>	5,870 Kg.	Gri - Grey	18
F22.1014	150x150x140 mm	0,093 m <sup>3</sup>	6,810 Kg.	Gri - Grey	18
F22.1015	190x150x140 mm	0,088 m <sup>3</sup>	8,275 Kg.	Gri - Grey	18
F22.1016	210x120x160 mm	0,119 m <sup>3</sup>	9,970 Kg.	Gri - Grey	24
F22.1017	200x200x160 mm	0,094 m <sup>3</sup>	7,400 Kg.	Gri - Grey	12
F22.1018	150x260x120 mm	0,140 m <sup>3</sup>	13,000 Kg.	Gri - Grey	27
F22.1019	280x210x160 mm	0,146 m <sup>3</sup>	9,560 Kg.	Gri - Grey	12
F22.1020	380x280x130 mm	0,140 m <sup>3</sup>	11,200 Kg.	Gri - Grey	10

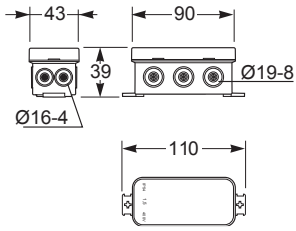

External dimensions	
Height	43
Width	90
Depth	39

Entries	
Top	3 x Ø 8-19
Bottom	3 x Ø 8-19
Side	2 x (2 x Ø 4-16)

Ürün Kodu - Product Code 3050

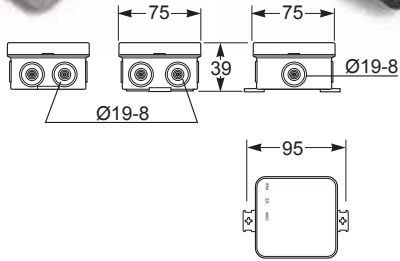
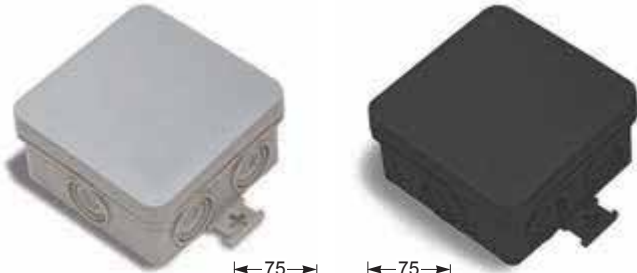

External dimensions	
Height	75
Width	75
Depth	39

Entries	
Top	2 x Ø 8-19
Bottom	1 x Ø 8-19
Side	2 x (2 x Ø 8-19)

Ürün Kodu - Product Code 3050

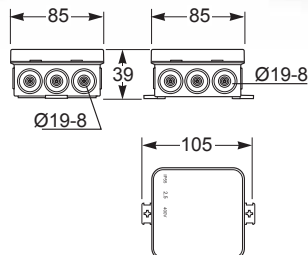

External dimensions	
Height	85
Width	85
Depth	39

Entries	
Top	3 x Ø 8-19
Bottom	3 x Ø 8-19
Side	2 x (3 x Ø 8-19)

Ürün Kodu - Product Code 3050





**MENHOL - MANHOLE**

<b>CODE</b>	F.23.2020	<b>BOX</b>	20
-------------	-----------	------------	----

---

**SIZE**

---

200x200x200 mm

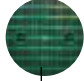

FLX.9150  
200x200x200 Cover Frame  
Sold Separately

FLX.9145  
Sold Separately

0,018 m<sup>3</sup> - 21,30 Kg.



**MENHOL - MANHOLE**

<b>CODE</b>	F.23.3030	<b>BOX</b>	12
-------------	-----------	------------	----

---



**SIZE**

---

300x300x300 mm



FLX.9151  
300x300x300 Cover Frame  
Sold Separately

FLX.9109  
Sold Separately

34,20 Kg. - 0,034 m<sup>3</sup>



**MENHOL - MANHOLE**

<b>CODE</b>	F.23.4040	<b>BOX</b>	4
-------------	-----------	------------	---

---



**SIZE**

---

400x400x400 mm



FLX.9152  
400x400x400 Cover Frame  
Sold Separately

FLX.9119  
Sold Separately

23,50 Kg. - 0,270 m<sup>3</sup>



**MENHOL - MANHOLE**

<b>CODE</b>	F.23.5555	<b>BOX</b>	2
-------------	-----------	------------	---

---

**SIZE**

---

550x550x500 mm



FLX.9153  
550x550x500 Cover Frame  
Sold Separately



FLX.9135  
Sold Separately

19,10 Kg. - 0,320 m<sup>3</sup>

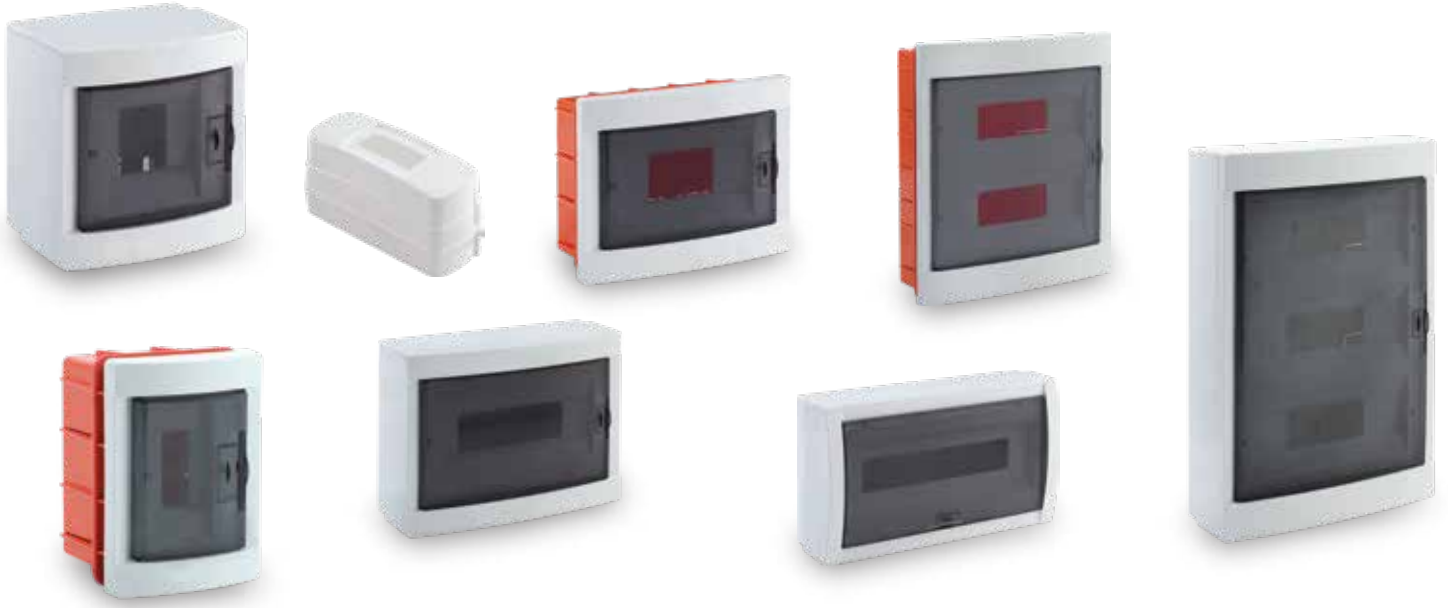

**SİGORTA KUTULARI - DISTRIBUTION BOARDS**

KOD - CODE	EBAT - SIZE MM	DESCRIPTION	KUTU - BOX
F25.1002	140 X 98 X 143	2 Plus Distribution Board S.M.	60
F25.1004	140 X 97,5 X 150	4 Plus Distribution Board S.M.	45
F25.1006	184 X 99,5 X 140	6 Plus Distribution Board S.M.	30
F25.1008	231 X 100 X 176	8 Plus Distribution Board S.M.	20
F25.1012	295 X 100 X 221	12 Plus Distribution Board S.M.	20
F25.1018	390 X 103 X 220	18 Plus Distribution Board S.M.	10
F25.1024	295 X 100 X 337	24 Plus Distribution Board S.M.	10
F25.1036	295 X 100 X 453	36 Plus Distribution Board S.M.	10
F25.1-2	139 X 65 X 54	1-2 Plus Distribution Board S.M.	20/240
F26.1002	100 X 98 X 142	2 Plus Distribution Board FM.	60
F26.1004	140 X 98 X 150	4 Plus Distribution Board FM.	45
F26.1006	176 X 100 X 135	6 Plus Distribution Board FM.	30
F26.1008	220 X 100 X 169	8 Plus Distribution Board FM.	20
F26.1012	284 X 100 X 215	12 Plus Distribution Board FM.	20
F26.1018	365 X 103 X 212	18 Plus Distribution Board FM.	10
F26.1024	284 X 100 X 330	24 Plus Distribution Board FM.	10
F26.1036	284 X 100 X 446	36 Plus Distribution Board FM.	10



**IP 65 SİGORTA KUTULARI ACQUA SERİSİ**  
DISTRIBUTION BOARD IP65 ACQUA SERIE

<b>KOD - CODE</b>	3902-T	<b>KUTU - BOX</b>	30
<b>MODÜL - MODULE</b>	2/4	<b>ÖLÇÜ</b> DIMENSION	171 X 100 X 100



**IP 65 SİGORTA KUTULARI ACQUA SERİSİ**  
DISTRIBUTION BOARD IP65 ACQUA SERIE

<b>KOD - CODE</b>	3904-T	<b>KUTU - BOX</b>	17
<b>MODÜL - MODULE</b>	4	<b>ÖLÇÜ</b> DIMENSION	215 X 145 X 110



**IP 65 SİGORTA KUTULARI ACQUA SERİSİ**  
DISTRIBUTION BOARD IP65 ACQUA SERIE

<b>KOD - CODE</b>	3908-T	<b>KUTU - BOX</b>	9
<b>MODÜL - MODULE</b>	8	<b>ÖLÇÜ</b> DIMENSION	215 X 235 X 110



**IP 65 SİGORTA KUTULARI ACQUA SERİSİ**  
DISTRIBUTION BOARD IP65 ACQUA SERIE

<b>KOD - CODE</b>	3912-T	<b>KUTU - BOX</b>	7
<b>MODÜL - MODULE</b>	12	<b>ÖLÇÜ</b> DIMENSION	215 X 310 X 110



**IP 65 SİGORTA KUTULARI ACQUA SERİSİ**  
DISTRIBUTION BOARD IP65 ACQUA SERIE

<b>KOD - CODE</b>	3926-T	<b>KUTU - BOX</b>	5
<b>MODÜL - MODULE</b>	26	<b>ÖLÇÜ</b> DIMENSION	410 X 310 X 150



IP 65 SİGORTA KUTULARI ACQUA SERİSİ  
DISTRIBUTION BOARD IP65 ACQUA SERIE

KOD - CODE	3942-T	KUTU - BOX	4
MODÜL - MODULE	42	ÖLÇÜ DIMENSION	465 X 325 X 150



IP 65 SİGORTA KUTULARI ACQUA SERİSİ  
DISTRIBUTION BOARD IP65 ACQUA SERIE

KOD - CODE	39018		
MODÜL - MODULE	18	ÖLÇÜ DIMENSION	290 x 430 x 160



IP 65 SİGORTA KUTULARI ACQUA SERİSİ  
DISTRIBUTION BOARD IP65 ACQUA SERIE

KOD - CODE	39036		
MODÜL - MODULE	36	ÖLÇÜ DIMENSION	464 x 430 x 160



IP 65 SİGORTA KUTULARI ACQUA SERİSİ  
DISTRIBUTION BOARD IP65 ACQUA SERIE

KOD - CODE	39054		
MODÜL - MODULE	54	ÖLÇÜ DIMENSION	640 x 430 x 160



IP 65 SİGORTA KUTULARI ACQUA SERİSİ  
DISTRIBUTION BOARD IP65 ACQUA SERIE

KOD - CODE	39072		
MODÜL - MODULE	72	ÖLÇÜ DIMENSION	878 x 430 x 160



## TEKLİ KOMBİNASYON KUTUSU - SINGLE SOCKET BOX

CODE	F5001	BOX	24
------	-------	-----	----

ÖLÇÜ - SIZE

RENK - COLOR

214x128x120 mm

Gri - Grey



1X16A  
Board Socket  
FLX5005



3X25A  
Board Socket  
FLX5007



4X16A  
Board Socket  
FLX5020



4X32A  
Board Socket  
FLX5021



5X16A  
Board Socket  
FLX5030



5X32A  
Board Socket  
FLX5031

10,00 Kg. - 0,105 m<sup>3</sup>



## TEKLİ KOMBİNASYON KUTUSU - SINGLE SOCKET BOX

CODE	F5002	BOX	24
------	-------	-----	----

ÖLÇÜ - SIZE

RENK - COLOR

260x150x120 mm

Gri - Grey



1X16A  
Board Socket  
FLX5005



3X25A  
Board Socket  
FLX5007



4X16A  
Board Socket  
FLX5020



4X32A  
Board Socket  
FLX5021



5X16A  
Board Socket  
FLX5030



5X32A  
Board Socket  
FLX5031

15,50 Kg. - 0,105 m<sup>3</sup>



## İKİLİ KOMBİNASYON KUTUSU - DOUBLE SOCKET BOX

CODE	F5003	BOX	12
------	-------	-----	----

ÖLÇÜ - SIZE

RENK - COLOR

288x218x124 mm

Gri - Grey



1X16A  
Board Socket  
FLX5005



3X25A  
Board Socket  
FLX5007



4X16A  
Board Socket  
FLX5020



4X32A  
Board Socket  
FLX5021



5X16A  
Board Socket  
FLX5030



5X32A  
Board Socket  
FLX5031

10,50 Kg. - 0,10 m<sup>3</sup>



## DÖRTLÜ KOMBİNASYON KUTUSU - QUART SOCKET BOX

CODE	F5004	BOX	10
------	-------	-----	----

ÖLÇÜ - SIZE

RENK - COLOR

380x280x130 mm

Gri - Grey



1X16A  
Board Socket  
FLX5005



3X25A  
Board Socket  
FLX5007



4X16A  
Board Socket  
FLX5020



4X32A  
Board Socket  
FLX5021



5X16A  
Board Socket  
FLX5030



5X32A  
Board Socket  
FLX5031

15,60 Kg. - 0,105 m<sup>3</sup>



DEKORATİF ASPIRATÖR - DECORATIVE VENTILATOR

CODE F6100 | BOX 24

SIZE 8,37 Kg. - 0,055 m<sup>3</sup>

100 mm



Operation Voltage  
12W - 230 V AC



DEKORATİF ASPIRATÖR - DECORATIVE VENTILATOR

CODE F6120 | BOX 24

SIZE 10,70 Kg. - 0,055 m<sup>3</sup>

120 mm



Operation Voltage  
12W - 230 V AC



DEKORATİF ASPIRATÖR - DECORATIVE VENTILATOR

CODE F6150 | BOX 24

SIZE 10,70 Kg. - 0,055 m<sup>3</sup>

150 mm



Operation Voltage  
18W - 230 V AC



DEKORATİF ASPIRATÖR - DECORATIVE VENTILATOR

CODE F6200 | BOX 8

SIZE 14,00 Kg. - 0,074 m<sup>3</sup>

200 mm



Operation Voltage  
40W - 220-240 V AC





# POLYESTER PANOLAR

POLYESTER DISTRIBUTION BOARD





ÜRÜN - PRODUCT	ÖLÇÜ - SIZE	KOD - CODE	KUTU - BOX
DISTRIBUTION BOARD POLYESTER	190x290x120 mm	FLX.7001	8
DISTRIBUTION BOARD POLYESTER	200x300x120 mm	FLX.7002	8
DISTRIBUTION BOARD POLYESTER	210x320x130 mm	FLX.7003	8
DISTRIBUTION BOARD POLYESTER	220x330x170 mm	FLX.7004	8
DISTRIBUTION BOARD POLYESTER	250x300x170 mm	FLX.7005	6
DISTRIBUTION BOARD POLYESTER	300x400x170 mm	FLX.7006	4
DISTRIBUTION BOARD POLYESTER	320x660x200 mm	FLX.7007	1
DISTRIBUTION BOARD POLYESTER	350x500x170 mm	FLX.7008	2
DISTRIBUTION BOARD POLYESTER	400x600x200 mm	FLX.7009	1
DISTRIBUTION BOARD POLYESTER	500x700x200 mm	FLX.7010	1
DISTRIBUTION BOARD POLYESTER	600x800x220 mm	FLX.7011	1
SINGLE PHASE COUNTER BOARD	210x320x130 mm	FLX.7012	8
ECO MONOPHASE COUNTER BOARD	200x320x100 mm	FLX.7013	8
DUAL SINGLE PHASE COUNTER BOARD	300x400x170 mm	FLX.7014	4
TRIPLE SINGLE PHASE COUNTER BOARD	350x500x170 mm	FLX.7015	2
QUADRUPLE SINGLE COUNTER BOARD	400x600x200 mm	FLX.7016	1
COUNTER PANEL THREE - PHASE COUNTER	300x400x170 mm	FLX.7017	4
PANEL DOUBLE THREE - PHASE	400x600x200 mm	FLX.7018	1
COUNTER PANEL TYPE 3 ELECTRICITY	800x1770x320 mm	FLX.7019	1
DISTRIBUTION PANEL TYPE 1 ELECTRICITY	600x1770x320 mm	FLX.7020	1
DISTRIBUTION PANEL JUNCTION BOX 3x160A	365x250x130 mm	FLX.7021	4



## KABLO KANALI

---

## CABLE TRUNKING

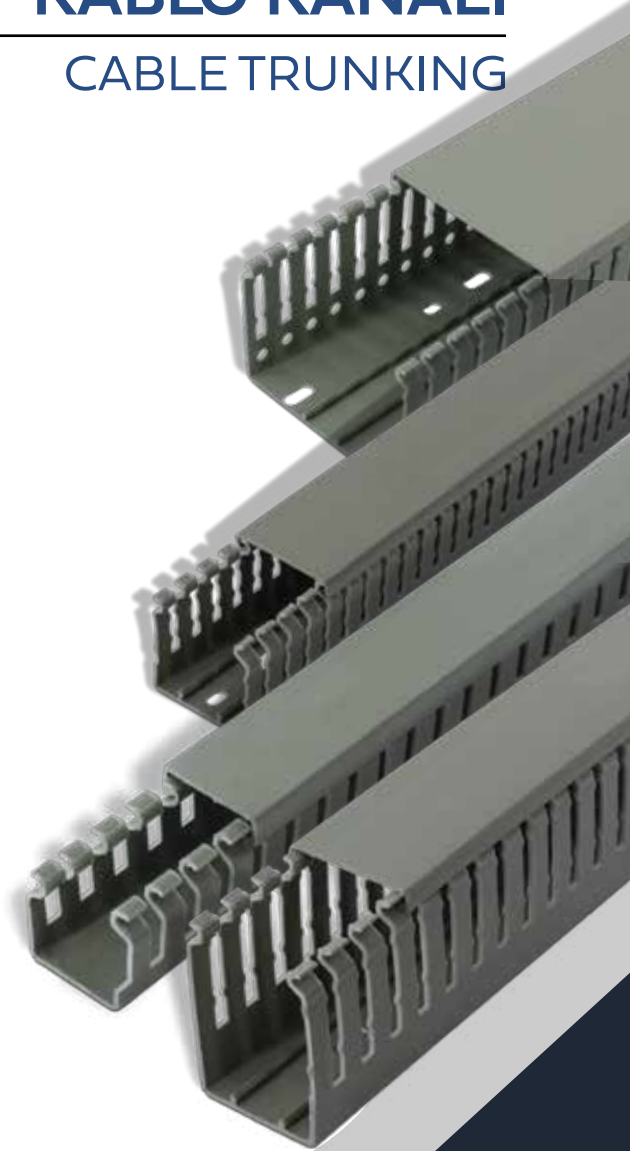



ÜRÜN - PRODUCT	KOD - CODE	ÖLÇÜ - SIZE	PAKET - PACKAGE (M)
CABLE TRUNKING	F271212	12x12 mm	378
CABLE TRUNKING	F271510	15x10 mm	340
CABLE TRUNKING	F271616	16x16 mm	266
CABLE TRUNKING	F272010	20x10 mm	240
CABLE TRUNKING	F272013	20x13 mm	300
CABLE TRUNKING	F272516	25x16 mm	168
CABLE TRUNKING	F272525	25x25 mm	130
CABLE TRUNKING	F273020	30x20 mm	120
CABLE TRUNKING	F274016	40x16 mm	98
CABLE TRUNKING	F274025	40x25 mm	80
CABLE TRUNKING	F274040	40x40 mm	72
CABLE TRUNKING	F275050	50x50 mm	40
CABLE TRUNKING	F276040	60x40 mm	48
CABLE TRUNKING	F276060	60x60 mm	40
CABLE TRUNKING	F277550	75x50 mm	32
CABLE TRUNKING	F278040	80x40 mm	36
CABLE TRUNKING	F278060	80x60 mm	32
CABLE TRUNKING	F2710040	100x40 mm	28
CABLE TRUNKING	F2710060	100x60 mm	24
CABLE TRUNKING	F2712060	120x60 mm	20



## YAPIŞKAN BANTLI PVC KABLO KANALLARI

PVC CABLE TRUNKING WITH ADHESIVE TAPE

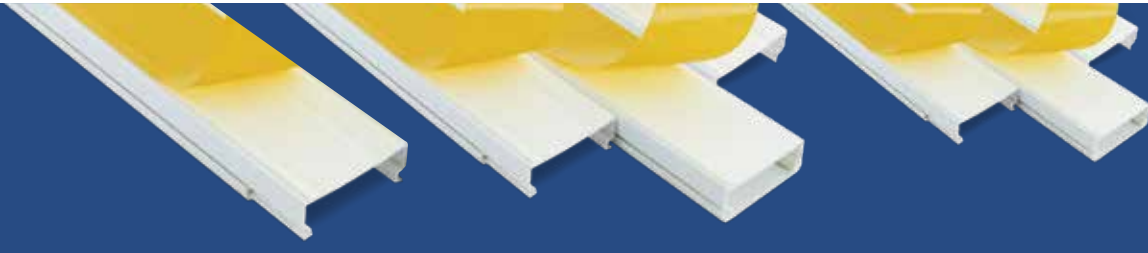

ÜRÜN - PRODUCT	KOD - CODE	ÖLÇÜ - SIZE	PAKET - PACKAGE (M)
CABLE TRUNKING WITH ADHESIVE TAPE	F28.1212	12x12 mm	378
CABLE TRUNKING WITH ADHESIVE TAPE	F28.1510	15x10 mm	340
CABLE TRUNKING WITH ADHESIVE TAPE	F28.1616	16x16 mm	266
CABLE TRUNKING WITH ADHESIVE TAPE	F28.2010	20x10 mm	240
CABLE TRUNKING WITH ADHESIVE TAPE	F28.2013	20x13 mm	300
CABLE TRUNKING WITH ADHESIVE TAPE	F28.2516	25x16 mm	168
CABLE TRUNKING WITH ADHESIVE TAPE	F28.2525	25x25 mm	130
CABLE TRUNKING WITH ADHESIVE TAPE	F273020	30x20 mm	120
CABLE TRUNKING WITH ADHESIVE TAPE	F28.4016	40x16 mm	98
CABLE TRUNKING WITH ADHESIVE TAPE	F28.4025	40x25 mm	80
CABLE TRUNKING WITH ADHESIVE TAPE	F28.4040	40x40 mm	72
CABLE TRUNKING WITH ADHESIVE TAPE	F28.5050	50x50 mm	40
CABLE TRUNKING WITH ADHESIVE TAPE	F28.6040	60x40 mm	48
CABLE TRUNKING WITH ADHESIVE TAPE	F28.6060	60x60 mm	40
CABLE TRUNKING WITH ADHESIVE TAPE	F28.7550	75x50 mm	32
CABLE TRUNKING WITH ADHESIVE TAPE	F28.8040	80x40 mm	36
CABLE TRUNKING WITH ADHESIVE TAPE	F28.8060	80x60 mm	32
CABLE TRUNKING WITH ADHESIVE TAPE	F28.10040	100x40 mm	28
CABLE TRUNKING WITH ADHESIVE TAPE	F28.10060	100x60 mm	24
CABLE TRUNKING WITH ADHESIVE TAPE	F28.12060	120x60 mm	20

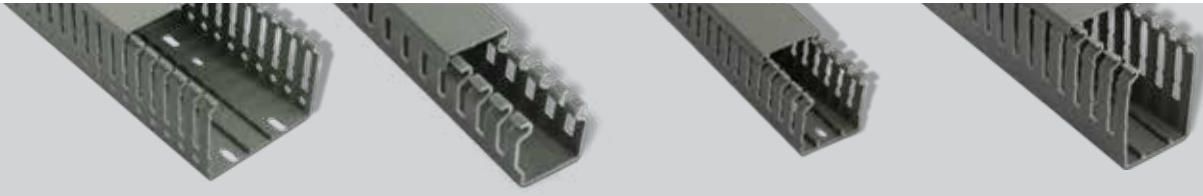

KOD - CODE	ÜRÜN - PRODUCT	ÖLÇÜ - SIZE	METRE - METER
		(MM)	
F29.2525	SLOTTED TYPE CABLE TRUNKING	25x25	90
F29.2540	SLOTTED TYPE CABLE TRUNKING	25x40	80
F29.2580	SLOTTED TYPE CABLE TRUNKING	25x80	54
F29.4040	SLOTTED TYPE CABLE TRUNKING	40x40	72
F29.4060	SLOTTED TYPE CABLE TRUNKING	40x60	48
F29.4080	SLOTTED TYPE CABLE TRUNKING	40x80	36
F29.6040	SLOTTED TYPE CABLE TRUNKING	60x40	48
F29.6060	SLOTTED TYPE CABLE TRUNKING	60x60	32
F29.8040	SLOTTED TYPE CABLE TRUNKING	80x40	36
F29.8060	SLOTTED TYPE CABLE TRUNKING	80x60	24
F29.10060	SLOTTED TYPE CABLE TRUNKING	100x60	18

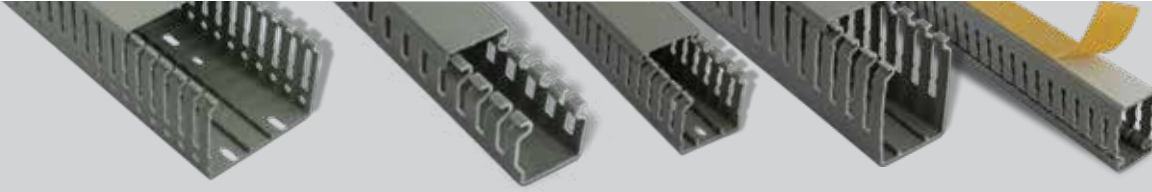

KOD - CODE	ÜRÜN - PRODUCT	ÖLÇÜ - SIZE	METRE - METER
		(MM)	
F30.2525	SLOTTED TYPE CABLE TRUNKING WITH ADHESIVE TAPE	25x25	90
F30.2540	SLOTTED TYPE CABLE TRUNKING WITH ADHESIVE TAPE	25x40	80
F30.2580	SLOTTED TYPE CABLE TRUNKING WITH ADHESIVE TAPE	25x80	54
F30.4040	SLOTTED TYPE CABLE TRUNKING WITH ADHESIVE TAPE	40x40	72
F30.4060	SLOTTED TYPE CABLE TRUNKING WITH ADHESIVE TAPE	40x60	48
F30.4080	SLOTTED TYPE CABLE TRUNKING WITH ADHESIVE TAPE	40x80	36
F30.6040	SLOTTED TYPE CABLE TRUNKING WITH ADHESIVE TAPE	60x40	48
F30.6060	SLOTTED TYPE CABLE TRUNKING WITH ADHESIVE TAPE	60x60	32

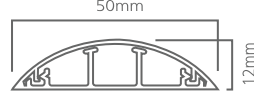
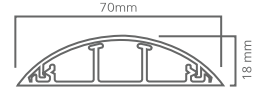
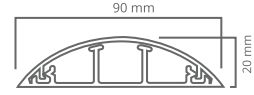
**BALIK SIRTİ KABLO KANALI - OVERFLOOR CABLE TRUNKING****KOD - CODE** F31.5012 | **KUTU - BOX** 50 Mt**ÖLÇÜ - SIZE** 50x12 mm**BALIK SIRTİ KABLO KANALI - OVERFLOOR CABLE TRUNKING****KOD - CODE** F31.7020 | **KUTU - BOX** 24 Mt**ÖLÇÜ - SIZE** 70x20 mm**BALIK SIRTİ KABLO KANALI - OVERFLOOR CABLE TRUNKING****KOD - CODE** F31.9020 | **KUTU - BOX** 24 Mt**ÖLÇÜ - SIZE** 90x20 mm

X: ● X: ○ X: ● X: ●

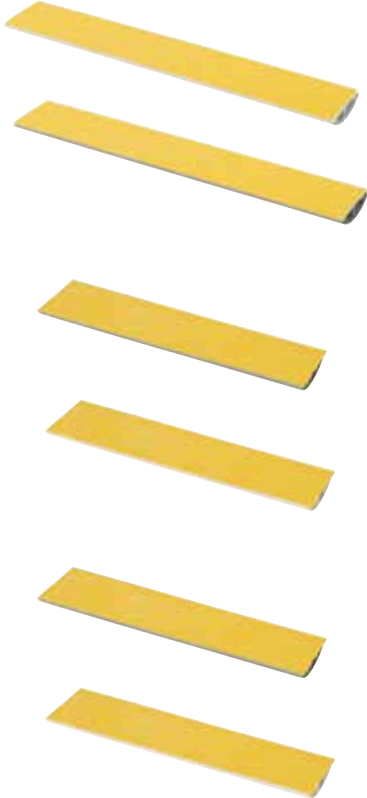
**BALIK SIRTİ PVC KABLO KANALI BANTLI**

OVERFLOOR CABLE TRUNKING WITH ADHESIVE TAPE

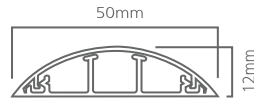
**KOD - CODE** F32.5012 | **KUTU - BOX** 50 Mt**ÖLÇÜ - SIZE** 50x12 mm**BALIK SIRTİ PVC KABLO KANALI BANTLI**

OVERFLOOR CABLE TRUNKING WITH ADHESIVE TAPE

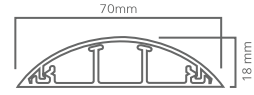
**KOD - CODE** F32.7020 | **KUTU - BOX** 24 Mt**ÖLÇÜ - SIZE** 70x20 mm**BALIK SIRTİ PVC KABLO KANALI BANTLI**

OVERFLOOR CABLE TRUNKING WITH ADHESIVE TAPE

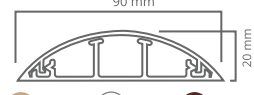
**KOD - CODE** F32.9020 | **KUTU - BOX** 24 Mt**ÖLÇÜ - SIZE** 90x20 mm

X: ● X: ○ X: ● X: ●



# PLASTİK BORU VE AKSESUARLARI

PLASTIC CONDUITS & ACCESSORIES







## TEKNİK ÖZELLİKLER

<b>Sıkıştırma Dayanımı</b> - Compression Resistance	320N/60Sn
<b>Darbe Dayanımı</b> - Impact Resistance	1Kg/100mm
<b>Çalışma Sıcaklığı</b> - Operating temperature	-25 +65 °C
<b>Malzeme</b> - Raw Material	PVC UL94, V0 M1
<b>Kalınlık</b> - Thickness(mm)	1,8 mm

<b>UV dayanımı</b> - UV resistant
<b>Kolay kurulum, boyanabilir.</b> - Easy install, paintable
<b>Elektrik iletmez</b> - Non-conductive
<b>Alev yamaz</b> - Nonflammable
<b>Aşınma dayanımı</b> - Corrosion resistant
<b>Asit ve yağlara karşı dayanımlı</b> - Resistant to acids, oils and greases

ÜRÜN PRODUCT	KOD CODE	ÖLÇÜ SIZE	DIŞ ÇAPI OUTSIDE DIAMETER (D) (MM)	İÇ ÇAPI INSIDE DIAMETER (d) (MM)	BOBİN UZUNLUĞU PACKING (MM)	RENK COLOR
RIGID PVC CONDUIT	FLX.16D	Ø 16	16-0,3	13,7	102	○ ● ●
RIGID PVC CONDUIT	FLX.20D	Ø 20	20-0,3	17,6	102	○ ● ●
RIGID PVC CONDUIT	FLX.25D	Ø 25	25-0,4	22,2	51	○ ● ●
RIGID PVC CONDUIT	FLX.32D	Ø 32	32-0,4	28,7	51	○ ● ●
RIGID PVC CONDUIT	FLX.40D	Ø 40	40-0,4	36,5	51	○ ● ●
RIGID PVC CONDUIT	FLX.50D	Ø 50	50-0,5	46,4	30	○ ● ●

Boru 3mt boy halinde üretilir. - Pipe is produced in 3 mt length.



ÜRÜN PRODUCT	KOD CODE	ÖLÇÜ SIZE	DIŞ ÇAPI OUTSIDE DIAMETER (D) (MM)	İÇ ÇAPI INSIDE DIAMETER (d) (MM)	BOBİN UZUNLUĞU PACKING (MM)	RENK COLOR
RIGID PVC CONDUIT WITH BELLED END	FLX.16D	Ø 16	16-0,3	13,7	102	○ ● ●
RIGID PVC CONDUIT WITH BELLED END	FLX.20D	Ø 20	20-0,3	17,6	102	○ ● ●
RIGID PVC CONDUIT WITH BELLED END	FLX.25D	Ø 25	25-0,4	22,2	51	○ ● ●
RIGID PVC CONDUIT WITH BELLED END	FLX.32D	Ø 32	32-0,4	28,7	51	○ ● ●
RIGID PVC CONDUIT WITH BELLED END	FLX.40D	Ø 40	40-0,4	36,5	51	○ ● ●
RIGID PVC CONDUIT WITH BELLED END	FLX.50D	Ø 50	50-0,5	46,4	30	○ ● ●

Boru 3mt boy halinde üretilir. - Pipe is produced in 3 mt length.



PP Esnek Boru Mufu - PP Flexible Conduit Coupling



KOD - CODE	ÜRÜN - PRODUCT	PAKET - PACKAGE
FLX.9001	Q 16 mm	100
FLX.9002	Q 20 mm	100
FLX.9003	Q 25 mm	100
FLX.9004	Q 32 mm	100

PVC Manşon-PVC Coupling



KOD - CODE	ÜRÜN - PRODUCT	PAKET - PACKAGE
FLX.9005	Q 20 mm	300
FLX.9006	Q 25 mm	150
FLX.9007	Q 32 mm	75

Düz Boru Ek Mufu - Release Coupling (PE / PVC )



KOD - CODE	ÜRÜN - PRODUCT	PAKET - PACKAGE
FLX.9008	Q 16 mm	100
FLX.9009	Q 20 mm	100
FLX.9010	Q 25 mm	100
FLX.9011	Q 32 mm	100

PP Kapaklı Kroşe - PP Clip



KOD - CODE	ÜRÜN - PRODUCT	PAKET - PACKAGE
FLX.9012	Q 16 mm	100
FLX.9013	Q 20 mm	100
FLX.9014	Q 25 mm	100
FLX.9015	Q 32 mm	100

PP Kapaklı Kroşe - PP Clip



KOD - CODE	ÜRÜN - PRODUCT	PAKET - PACKAGE
FLX.9016	Q 16 mm	100
FLX.9017	Q 20 mm	100
FLX.9018	Q 25 mm	100
FLX.9019	Q 32 mm	100

**PVC/PP DİRSEK-PVC/PP ELBOW SLIPTYPE**



KOD - CODE	ÜRÜN - PRODUCT	PAKET - PACKAGE
FLX.9020	Q 16 mm	100
FLX.9021	Q 20 mm	100
FLX.9022	Q 25 mm	50
FLX.9023	Q 32 mm	25

**PVC/PP 90 °L DİRSEK -PVC/PP 90 ° L ELBOW**



KOD - CODE	ÜRÜN - PRODUCT	PAKET - PACKAGE
FLX.9024	Q 16 mm	100
FLX.9025	Q 20 mm	100
FLX.9026	Q 25 mm	100
FLX.9027	Q 32 mm	100

**PP Kapaklı Spiral Boru Rakoru - PP Spiral Conduit Gland**



KOD - CODE	ÜRÜN - PRODUCT	PAKET - PACKAGE
FLX.9028	Q 16 mm	100
FLX.9029	Q 20 mm	100
FLX.9030	Q 25 mm	100
FLX.9031	Q 32 mm	100

**PVC Düz Boru Buat Rakoru-PVC Female Adapter with Thread and Male Bush**



KOD - CODE	ÜRÜN - PRODUCT	PAKET - PACKAGE
FLX.9032	Q 16 mm	100
FLX.9033	Q 20 mm	100
FLX.9034	Q 25 mm	100
FLX.9035	Q 32 mm	100

**DÜBELLİ KROŞE - U CONDUIT SUPPORT WITH PLUG**



KOD - CODE	ÜRÜN - PRODUCT	PAKET - PACKAGE
FLX.9036	DKS 3/13	1.000
FLX.9037	DKS 8/28	500

BORU BÜKME YAYI - CONDUIT BENDING SPRING



KOD - CODE	ÜRÜN - PRODUCT	PAKET - PACKAGE
FLX.9038	Q 16 mm	1
FLX.9039	Q 20 mm	1
FLX.9040	Q 25 mm	1
FLX.9041	Q 32 mm	1

AÇILIR T ELEMANI - TEES



KOD - CODE	ÜRÜN - PRODUCT	PAKET - PACKAGE
FLX.9042	Q 16 mm	100
FLX.9043	Q 20 mm	100
FLX.9044	Q 25 mm	100
FLX.9045	Q 32 mm	100

KENDİNDEN DÜBELLİ KROŞE - DOWEL PIN CLIP



KOD - CODE	ÜRÜN - PRODUCT	PAKET - PACKAGE
FLX.9046	Q 16 mm	100
FLX.9047	Q 20 mm	100
FLX.9048	Q 25 mm	100
FLX.9049	Q 32 mm	100

YERE TESPİT KROŞE - ANCHARED GROUND FIXING CROCHET



KOD - CODE	ÜRÜN - PRODUCT	PAKET - PACKAGE
FLX.9050	Q 16 mm	100
FLX.9051	Q 20 mm	100
FLX.9052	Q 25 mm	100
FLX.9053	Q 32 mm	100



KOD CODE	ANMA ÇAPI NOMINAL DIAMETER (MM)	ÜRÜN PRODUCT	PAKET PACKAGE
FLXRJB-20-1	Ø 20	DÜZ BORU BUATI / 1 ÇIKIŞLI 1 way Terminal	40
FLXRJB-20-2	Ø 20	DÜZ BORU BUATI / 2 ÇIKIŞLI 2 way Through	40
FLXRJB-20-3	Ø 20	DÜZ BORU BUATI / 3 ÇIKIŞLI 3 way Tee	40
FLXRJB-20-4	Ø 20	DÜZ BORU BUATI / 4 ÇIKIŞLI 4 way Cross	40
FLXRJB-25-1	Ø 25	DÜZ BORU BUATI / 1 ÇIKIŞLI 1 way Terminal	30
FLXRJB-25-2	Ø 25	DÜZ BORU BUATI / 2 ÇIKIŞLI 2 way Through	30
FLXRJB-25-3	Ø 25	DÜZ BORU BUATI / 3 ÇIKIŞLI 3 way Tee	30
FLXRJB-26-4	Ø 25	DÜZ BORU BUATI / 4 ÇIKIŞLI 4 way Cross	30



**Test Gerilimi  
(AC)**  
2 kV- 2.5 kV  
Test Voltage (AC)  
2 kV - 2.5 kV



**Aleve dayanıklılık  
Flame retardant**  
I EC 60332-1



**Kurşunsuz  
Lead free**



**Bükülgen  
Flexible**



**Açık alan  
In free air**



**Serim sıcaklığı  
minimum 5°C**  
Installation  
temperature  
min 5°C



**Boru içinde  
In conduit**



**İç tesisat  
Internal wiring**

### KULLANIM ALANLARI

Mekanik zorlamaların fazla olmadığı yerlerde sıva altı ve sıva üstünde kuru duvar ve asma tavan içerisinde.

### USAGE AREAS

In places where mechanical stresses are not much, under/on the plaster, on dry wall and suspended ceiling.

## POLYAMID PA6 OLUKLU SİRAL BORU



### POLYAMIDE PA6 CORRUGATED PLASTIC CONDUIT

#### ÖZELLİKLER FEATURES

YARIKLI VE YARIKSIZ TİP, PA6 HAMMADDE, HALOJENSİZ, KENDİNDEN SÖNÜMLÜ, ALEV GECİKTİRİCİ  
SLIT AND NON-SLIT TYPE, PA6 MATERIAL, HALOGEN FREE, SELF-EXTINGUISHING, UL 94 V2 FLAME RETARDANCY

KOD - Siyah CODE - Black	KOD - Gri CODE - Grey	İÇ ÇAP ID (MM)	DIŞ ÇAP OD (MM)	ANMA ÖLÇÜSÜ NW CONDUIT SIZE (EUROPEAN) (MM)	ÖLÇÜ NOM SIZE (MM)	BÜKÜLME YARIÇAPI MIN BENDING RADIUS (MM)	PAKET PACKED (MT)
FLX-7-S	FLX-7-G	6,7	10	6,5	10	15	100
FLX-8,5-S	FLX-8,5-G	8,7	11,7	8,5	11	15	100
FLX-10-S	FLX-10-G	10	13,2	10	13	20	100
FLX-12-S	FLX-12-G	12,6	15,8	12	16	30	100
FLX-14-S	FLX-14-G	14,2	18,5	14	18	40	50
FLX-17-S	FLX-17-G	16,8	21,4	17	21	45	50
FLX-19-S	FLX-19-G	19,5	24	19	25	50	50
FLX-22-S	FLX-22-G	22	25,4	22	27	50	50
FLX-23-S	FLX-23-G	23,5	28,7	23	28	55	50
FLX-26-S	FLX-26-G	26,1	31,3	26	32	60	25
FLX-29-S	FLX-29-G	28,9	34,5	29	34	65	25
FLX-36-S	FLX-36-G	36,3	42,5	36	42	80	25
FLX-48-S	FLX-48-G	47,6	54,4	48	54	90	25

SICAKLIK ARALIĞI - TEMPERATURE RANGE

-40°C~+120°C

ESNEKLİK - FLEXIBILITY

Yüksek Esneklik - High Flexible

SERTİFİKA - CERTIFICATE

CE

YANMAZLIK SINIFI - FLAMMABILITY CLASS

UL94V2

KORUMA SINIFI - PROTECTION CLASS

IP66 / IP67 / IP68

RENK - COLOUR



GREY ( RAL 7031 )



BLACK ( RAL 9011 )

PROFİL - PROFILE



## POLYAMID PA6 OLUKLU SİRAL BORU- YARIKLI



### POLYAMIDE PA6 CORRUGATED PLASTIC CONDUIT SLIT TYPE

#### ÖZELLİKLER FEATURES

YARIKLI VE YARIKSIZ TİP, PA6 HAMMADDE, HALOJENSİZ, KENDİNDEN SÖNÜMLÜ, ALEV GECİKTİRİCİ  
SLIT AND NON-SLIT TYPE, PA6 MATERIAL, HALOGEN FREE, SELF-EXTINGUISHING, UL 94 V2 FLAME RETARDANCY

KOD - Siyah CODE - Black	KOD - Gri CODE - Grey	İÇ ÇAP ID (MM)	DIŞ ÇAP OD (MM)	ANMA ÖLÇÜSÜ NW CONDUIT SIZE (EUROPEAN) (MM)	ÖLÇÜ NOM SIZE (MM)	BÜKÜLME YARIÇAPI MIN BENDING RADIUS (MM)	PAKET PACKED (MT)
FLX-7-SY	FLX-7-GY	6,7	10	6,5	10	15	100
FLX-8,5-SY	FLX-8,5-GY	8,7	11,7	8,5	11	15	100
FLX-10-SY	FLX-10-GY	10	13,2	10	13	20	100
FLX-12-SY	FLX-12-GY	12,6	15,8	12	16	30	100
FLX-14-SY	FLX-14-GY	14,2	18,5	14	18	40	50
FLX-17-SY	FLX-17-GY	16,8	21,4	17	21	45	50
FLX-19-SY	FLX-19-GY	19,5	24	19	25	50	50
FLX-22-SY	FLX-22-GY	22	25,4	22	27	50	50
FLX-23-SY	FLX-23-GY	23,5	28,7	23	28	55	50
FLX-26-SY	FLX-26-GY	26,1	31,3	26	32	60	25
FLX-29-SY	FLX-29-GY	28,9	34,5	29	34	65	25
FLX-36-SY	FLX-36-GY	36,3	42,5	36	42	80	25
FLX-48-SY	FLX-48-GY	47,6	54,4	48	54	90	25

**SICAKLIK ARALIĞI - TEMPERATURE RANGE**

-40°C~+120°C

**ESNEKLİK - FLEXIBILITY**

Yüksek Esneklik - High Flexible

**SERTİFİKA - CERTIFICATE**

CE

**YANMAZLIK SINIFI - FLAMMABILITY CLASS**

UL94V2

**KORUMA SINIFI - PROTECTION CLASS**

IP66 / IP67 / IP68

**RENK - COLOUR**



GREY ( RAL 7031 )



BLACK ( RAL 9011 )

**PROFİL - PROFILE**



**POLYAMİD DÜZ RAKOR - POLYAMIDE STRAIGHT CONNECTOR**



- CE ve ROHS sertifikalıdır.
- Polyamid (PA6) hammaddeli olup, halogen free özelliklidir.
- Uygun conta rakoru (O-Ring) ile kullanıldığında koruma derecesi IP-67'ye yükselir.
- Metrik diş tiplerinde, kilitleme somunu da mevcuttur.
- Certified by CE and ROHS.
- Made of Polyamide (PA6), halogen-free.
- Protection level up to IP-67 when used with a suitable gasket (O-ring).
- Lock nut available for metric thread types.

(GRİ - SİYAH)  
(GRAY-BLACK)

CE **RoHS** ✓

PG KOD PG CODE	PG TİP ÖLÇÜ PG SIZE	METRİK KOD METRIC CODE	METRİK TİP ÖLÇÜ METRIC SIZE
FLX.35.1001	Pg 7	FLX.35.2001	---
FLX.35.1002	Pg 9	FLX.35.2002	---
FLX.35.1003	Pg 11	FLX.35.2003	M16 x 1,5
FLX.35.1004	Pg 13,5	FLX.35.2004	---
FLX.35.1005	Pg 16	FLX.35.2005	M20 x 1,5
FLX.35.1006	Pg 21	FLX.35.2006	M25 x 1,5
FLX.35.1007	Pg 29	FLX.35.2007	M32 x 1,5
FLX.35.1008	Pg 36	FLX.35.2008	---
FLX.35.1009	Pg 48	FLX.35.2009	---

**POLYAMİD DİRSEK RAKOR 90° - POLYAMIDE ELBOW CONNECTOR 90°**



- CE ve ROHS sertifikalıdır.
- Polyamid (PA6) hammaddeli olup, halogen free özelliklidir.
- Uygun conta rakoru (O-Ring) ile kullanıldığında koruma derecesi IP-67'ye yükselir.
- Tavsiye edilen montaj sıcaklığı: -40°C ile +105°C arasındır.
- Certified by CE and ROHS.
- Made of Polyamide (PA6), halogen-free.
- Protection level up to IP-67 when used with a suitable gasket (O-ring).
- Recommended mounting temperatures: from -40°C to +105°C.

(GRİ - SİYAH)  
(GRAY-BLACK)

CE **RoHS** ✓

PG KOD PG CODE	PG TİP ÖLÇÜ PG SIZE
FLX.36.1001	Pg 7
FLX.36.1002	Pg 9
FLX.36.1003	Pg 11
FLX.36.1004	Pg 13,5
FLX.36.1005	Pg 16
FLX.36.1006	Pg 21
FLX.36.1007	Pg 29
FLX.36.1008	Pg 36
FLX.36.1009	Pg 48



**POLYAMİD GEÇMELİ RAKOR - POLYAMIDE CONNECTOR COMPRESSION TYPE**



(GRİ - SİYAH)  
(GRAY-BLACK)

CE RoHS✓

- CE ve ROHS sertifikalıdır.
- Polyamid (PA6) hammaddeli olup, halogen free özelliğidir.
- Metrik dış tiplerinde, kilitleme somununda mevcuttur.
- Tavsiye edilen montaj sıcaklığı: -40°C ile +120°C arasındır
- Certified by CE and ROHS.
- Made of Polyamide (PA6), halogen-free.
- Lock nut available for metric thread types.
- Recommended mounting temperatures: from -40°C to +120°C.

PG KOD PG CODE	PG TİP ÖLÇÜ PG SIZE	METRİK KOD METRIC CODE	METRİK TİP ÖLÇÜ METRIC SIZE
FLX.371001	Pg 7	FLX.372001	M12 x 1,5
FLX.371002	Pg 9	FLX.372002	M16 x 1,5
FLX.371003	Pg 11	FLX.372003	M16 x 1,5
FLX.371004	Pg 13,5	FLX.372004	M20 x 1,5
FLX.371005	Pg 16	FLX.372005	M20 x 1,5
FLX.371006	Pg 21	FLX.372006	M25 x 1,5
FLX.371007	Pg 29	FLX.372007	M32 x 1,5
FLX.371008	Pg 36	FLX.372008	M40 x 1,5
FLX.371009	Pg 48	FLX.372009	M63 x 1,5

**POLYAMİD GEÇMELİ DİRSEK RAKOR 90° - POLYAMIDE COMP. TYPE ELBOW CONNECTOR 90°**



(GRİ - SİYAH)  
(GRAY-BLACK)

CE RoHS✓

- CE ve ROHS sertifikalıdır.
- Polyamid (PA6) hammaddeli olup, halogen free özelliğidir.
- Metrik dış tiplerinde, kilitleme somununda mevcuttur.
- Tavsiye edilen montaj sıcaklığı: -40°C ile +105°C arasındadır.
- Certified by CE and ROHS.
- Made of Polyamide (PA6), halogen-free.
- Lock nut available for metric thread types.
- Recommended mounting temperatures: from -40°C to +105°C.

PG KOD PG CODE	PG TİP ÖLÇÜ PG SIZE
FLX.381001	Pg 7
FLX.381002	Pg 9
FLX.381003	Pg 11
FLX.381004	Pg 13,5
FLX.381005	Pg 16
FLX.381006	Pg 21
FLX.381007	Pg 29
FLX.381008	Pg 36
FLX.381009	Pg 48

**POLYAMİD KAPAKLI KROŞE - POLYAMIDE CAPPED STRAP**



- CE sertifikalıdır.
- Polyamid (PA6) hammaddeli olup, halogen free özelliğindedir.
- Kapağı sayesinde her türlü yüzeyde spiral borular uzun süre monteli kalabilir.
- Gövde ile kapak birbirlerine naylon bağ ile bağlanır.
- Certified by CE.
- Made of Polyamide (PA6), halogen-free.
- The cap provides long-term steady fixing of flexible conduits to any kind of surface.
- The cap is attached to the body by means of a nylon tie.



(GRİ - SİYAH)  
(GRAY-BLACK)



GRİ KOD GRAY CODE	SİYAH KOD BLACK CODE
FLX.39.1001	FLX.39.2001
FLX.39.1002	FLX.39.2002
FLX.39.1003	FLX.39.2003
FLX.39.1004	FLX.39.2004
FLX.39.1005	FLX.39.2005
FLX.39.1006	FLX.39.2006
FLX.39.1007	FLX.39.2007
FLX.39.1008	FLX.39.2008
FLX.39.1009	FLX.39.2009

**POLYAMİD KİLİTLEME SOMUNU - POLYAMIDE LOCK NUT**



(GRİ - SİYAH)  
(GRAY-BLACK)



- CE ve VDE sertifikalıdır.
- Polyamid (PA6) hammaddeli olup, halogen free özelliğindedir.
- Rakorların, pano ve ekipman bağlantılarında fixlenmesi amacıyla kullanılır.
- Certified by CE and VDE.
- Made of Polyamide (PA6), halogen-free.
- Used to fix connectors, boards and equipment connections.

PG KOD PG CODE	PG TİP ÖLÇÜ PG SIZE	METRİK KOD METRIC CODE	METRİK TİP ÖLÇÜ METRIC SIZE
FLX.40.1001	Pg 7	FLX.40.2001	M12 x 1,5
FLX.40.1002	Pg 9	FLX.40.2002	M16 x 1,5
FLX.40.1003	Pg 11	FLX.40.2003	-
FLX.40.1004	Pg 13,5	FLX.40.2004	M20 x 1,5
FLX.40.1005	Pg 16	FLX.40.2005	M25 x 1,5
FLX.40.1006	Pg 21	FLX.40.2006	M32 x 1,5
FLX.40.1007	Pg 29	FLX.40.2007	M40 x 1,5
FLX.40.1008	Pg 36	FLX.40.2008	M50 x 1,5
FLX.40.1009	Pg 48	FLX.40.2009	M63 x 1,5

**POLYAMİD KÖR TAPA - POLYAMIDE BLIND PLUG**



(GRİ - SİYAH)  
(GRAY-BLACK)



- TSE sertifikalıdır.
- Polyamid (PA6) hammaddeli olup, halogen free özelliğindedir.
- Özellikle pano ve dağıtım buatlarında, boşluk doldurucu olarak kullanılmaya uygundur.
- Certified by TSE.
- Made of Polyamide (PA6), halogen-free.
- Especially suitable for filling in unfilled openings in panel boards and distributor boxes.

PG KOD PG CODE	PG TİP ÖLÇÜ PG SIZE	METRİK KOD METRIC CODE	METRİK TİP ÖLÇÜ METRIC SIZE
FLX.41.1001	Pg 7	FLX.41.2001	M12 x 1,5
FLX.41.1002	Pg 9	FLX.41.2002	---
FLX.41.1003	Pg 11	FLX.41.2003	M16 x 1,5
FLX.41.1004	Pg 13,5	FLX.41.2004	M20 x 1,5
FLX.41.1005	Pg 16	FLX.41.2005	---
FLX.41.1006	Pg 21	FLX.41.2006	M25 x 1,5
FLX.41.1007	Pg 29	FLX.41.2007	M32 x 1,5
FLX.41.1008	Pg 36	FLX.41.2008	M40 x 1,5
FLX.41.1009	Pg 42	FLX.41.2009	M50 x 1,5
FLX.41.1010	Pg 48	FLX.41.2010	M63 x 1,5

**POLYAMİD "Y" - "T" DAĞITICILAR - POLYAMIDE DISTRIBUTORS "Y" & "T" TYPES**



-40°C / +110°C

RoHS✓

- ROHS sertifikalıdır.
- Polyamid (PA6) hammaddeli olup, halogen free özelliğindedir.
- Kendi kendine sönmeye özelliği vardır.
- Yağ, asit, benzin türü kimyevi maddelere karşı dirençlidir.
- Özellikle makine imalatında ve otomotiv sanayiinde kablo dağıtım elemanı olarak kullanılmaya uygundur.
- Certified by ROHS.
- Made of Polyamide (PA6), halogen-free.
- Self-extinguishing.
- Resistant to oil, acids, petrol chemical substances.
- Especially suitable for use as a cable distributing element in machine production and automotive industry.

"Y" DAĞITICI KOD "Y" TYPE CODE	SİRİRAL ÖLÇÜ FLEXIBLE CONDUIT SIZE	"T" DAĞITICI KOD "T" TYPE CODE	SİRİRAL ÖLÇÜ FLEXIBLE CONDUIT SIZE
FLX.42.1001	07-07-07	FLX.42.2001	07-07-07
FLX.42.1002	09-09-07	FLX.42.2002	09-09-07
FLX.42.1003	09-09-09	FLX.42.2003	09-09-09
FLX.42.1004	11-11-07	FLX.42.2004	11-11-09
FLX.42.1005	11-11-09	FLX.42.2005	11-11-11
FLX.42.1006	16-11-09	FLX.42.2006	16-11-11
FLX.42.1007	16-16-09	FLX.42.2007	16-11-16
FLX.42.1008	16-16-11	FLX.42.2008	16-16-11
FLX.42.1009	21-21-11	FLX.42.2009	21-16-16
FLX.42.1010	21-21-16	FLX.42.2010	21-21-21

## PVC DİŞLİ SİRİL BORU



### PVC REINFORCED CORRUGATED PLASTIC CONDUIT

#### ÖZELLİKLER - FEATURES

Oluklu, PVC  
Corrugated, PVC

KOD CODE	ÖLÇÜ NOM. SIZE	İÇ ÇAP ID (MM)	DIŞ ÇAP OD (MM)	PAKET PACKED (MT)
FLX.8008	8	8	12	30
FLX.8010	10	10	14,5	30
FLX.8012	12	12	16,3	30
FLX.8014	14	14	18,6	30
FLX.8016	16	16	20,5	30
FLX.8020	20	20	24,7	30
FLX.8022	22	22	27	30
FLX.8025	25	25	30,3	30
FLX.8028	28	28	33,2	30
FLX.8030	30	30	36	30
FLX.8032	32	32	37,5	30
FLX.8035	35	35	40,5	30
FLX.8038	38	38	44,1	30
FLX.8040	40	40	46,2	30
FLX.8045	45	45	51,8	30
FLX.8050	50	50	57	30

**MATERYAL - MATERIAL**  
PVC

**STANDART - STANDARD**  
EN 61386

**SIKIŞTIRMA MUKAVEMETİ - COMPRESSION STRENGTH**  
450 N

**ÇEKME (ÇEKME) MUKAVEMETİ - PULL-OFF (TENSILE) STRENGTH**  
250 N

**SERTİFİKA - CERTIFICATE**  
CE, ROHS

**SICAKLIK ARALIĞI - TEMPERATURE RANGE**  
-20°C~+70°C

**ESNEKLİK - FLEXIBILITY**  
Yüksek Esneklik - High Flexible

**YANMAZLIK SINIFI - FLAMMABILITY CLASS**  
UL94 HB

**KORUMA SINIFI - PROTECTION CLASS**  
IP66 / IP67 / IP68

**RENK - COLOUR**



GREY (RAL 7031)



BLACK (RAL 9011)

**PROFİL - PROFILE**



## 350N HAFİF SERİ PLASTİK SİRAL BORU

350N LIGHT SERIES PLASTIC SPIRAL PIPE



## 350N HALOGEN FREE PLASTİK SİRAL BORU

350N HALOGEN FREE PLASTIC SPIRAL PIPE



RENKLER  
COLORS



RENKLER  
COLORS



KOD CODE	EBAT U.S.T. SIZE	İÇ ÇAP ID (MM)	DIŞ ÇAP OD (MM)	PAKET PACKED (MT)
Fl6.1014	14	14	18	100
Fl6.1016	16	16	19,6	100
Fl6.1018	18	18	21,8	50
Fl6.1020	20	20	23,8	50
Fl6.1025	25	25	28,4	50
Fl6.1032	32	32	35,6	50

KOD CODE	EBAT U.S.T. SIZE	İÇ ÇAP ID (MM)	DIŞ ÇAP OD (MM)	PAKET PACKED (MT)
Fl6.2014	14	14	18,1	100
Fl6.2016	16	16	19,8	100
Fl6.2018	18	18	22,1	50
Fl6.2020	20	20	24,2	50
Fl6.2025	25	25	28,9	50
Fl6.2032	32	32	36	50

**2331-320N HAFİF SERİ KILAVUZ TELLİ SİRAL BORULAR**  
LIGHT SERIES GUIDE WIRE SPIRAL PIPES 2331-320N

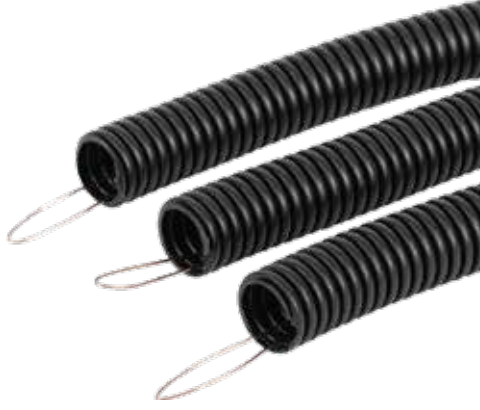

<b>2</b>	Sıkıştırma Dayanımı	Compression Resistance	320N
<b>3</b>	Darbe Dayanımı	Impact Resistance	2 kg.
<b>3</b>	Min. Çalışma Sıcaklığı	Min. Operation Temp.	-15 0C
<b>1</b>	Max. Çalışma Sıcaklığı	Max. Operation Temp	+60 0C

**Kullanım Alanları**

HAFİF SERİ SİRAL BORU siyan renkte üretilmektedir.  
Kılavuz telli spiral borular esneme özelliği olduğundan dönüş noktalarında dirsek ve benzeri parçaların kullanılmasına gerek kalmaz. Böylece işçilik ve zamandan tasarruf sağlar. İç anma çapları belirtilen spiral borular iç çap Ø14 - Ø32 mm. arası nominal çaplarda üretim yapılmaktadır.

KOD CODE	EBAT SIZE	İÇ ÇAP ID (MM)	DIŞ ÇAP OD (MM)	PAKET PACKED (MT)
FLX-DSPRHS14-07	14	14	18,1	100
FLX-DSPRHS16-07	16	16	19,8	100
FLX-DSPRHS18-07	18	18	22,1	50
FLX-DSPRHS20-07	20	20	24,2	50
FLX-DSPRHS25-07	25	25	28,9	50
FLX-DSPRHS32-07	32	32	36	50

**3331-750N ORTA SERİ KILAVUZ TELLİ SİRAL BORULAR**  
MEDIUM SERIES GUIDE WIRE SPIRAL PIPES 3331-750N

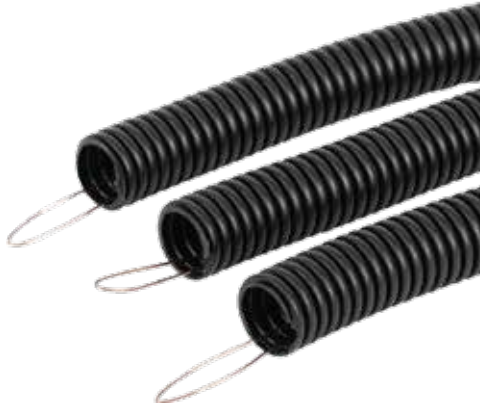

<b>2</b>	Sıkıştırma Dayanımı	Compression Resistance	750N
<b>3</b>	Darbe Dayanımı	Impact Resistance	2 kg.
<b>3</b>	Min. Çalışma Sıcaklığı	Min. Operation Temp.	-15 0C
<b>1</b>	Max. Çalışma Sıcaklığı	Max. Operation Temp	+60 0C

**Kullanım Alanları**

ORTA SERİ SİRAL BORU siyah renkte üretilmektedir.  
Kılavuz telli spiral borular esneme özelliği olduğundan dönüş noktalarında dirsek ve benzeri parçaların kullanılmasına gerek kalmaz. Böylece işçilik ve zamandan tasarruf sağlar. İç anma çapları belirtilen spiral borular iç çap Ø14 - Ø32 mm. arası nominal çaplarda üretim yapılmaktadır.

KOD CODE	EBAT SIZE	İÇ ÇAP ID (MM)	DIŞ ÇAP OD (MM)	PAKET PACKED (MT)
FLX-DSPROS14-08	14	14	18	100
FLX-DSPROS16-08	16	16	19,6	100
FLX-DSPROS18-08	18	18	21,8	50
FLX-DSPROS20-08	20	20	23,8	50
FLX-DSPROS25-08	25	25	28,4	50
FLX-DSPROS32-08	32	32	35,6	50

## 320N HAFİF SERİ POLİETİLEN KANGAL BORULAR

320N LIGHT SERIES POLYETHYLENE COIL PIPES



## 320N HAFİF SERİ HALOJEN FREE KANGAL BORULAR

320N LIGHT SERIES HALOGEN FREE COIL PIPES



### RENKLER

COLORS

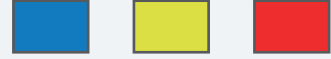

KOD CODE	EBAT Us.T. SIZE	İÇ ÇAP ID (MM)	DIŞ ÇAP OD (MM)	PAKET PACKED (MT)
F77014	14	11,4	14	100
F77016	16	13,5	16	100
F77018	18	15,5	18	100
F77020	20	17	20	100
F77025	25	21,4	25	100
F77032	32	27	32	100
F77040	40	34	40	100
F77050	50	43,6	50	100
F77063	63	56	63	50

KOD CODE	EBAT Us.T. SIZE	İÇ ÇAP ID (MM)	DIŞ ÇAP OD (MM)	PAKET PACKED (MT)
F72014	14	11	14	100
F72016	16	13	16	250
F72018	18	15	18	200
F72020	20	16,6	20	150
F72025	25	20,8	25	100
F72032	32	26,4	32	100
F72040	40	34	40	100
F72050	50	43,6	50	100
F72063	63	56	63	50

## 750N ORTA SERİ HALOJEN FREE KANGAL BORULAR

750N MEDIUM SERIES HALOGEN FREE COIL PIPES



## 750N ORTA SERİ HALOJEN FREE KANGAL BORULAR

750N MEDIUM SERIES HALOGEN FREE COIL PIPES



### RENKLER

COLORS



KOD CODE	EBAT Us.T. SIZE	İÇ ÇAP ID (MM)	DIŞ ÇAP OD (MM)	PAKET PACKED (MT)
F81014	14	10,2	14	100
F81016	16	12	16	250
F81018	18	14	18	200
F81020	20	15,6	20	150
F81025	25	20	25	100
F81032	32	25	32	100
F81040	40	32	40	100
F81050	50	41	50	100
F81063	63	54	63	50

### RENKLER

COLORS



KOD CODE	EBAT Us.T. SIZE	İÇ ÇAP ID (MM)	DIŞ ÇAP OD (MM)	PAKET PACKED (MT)
F8.2014	14	10,2	14	100
F8.2016	16	12	16	250
F8.2018	18	14	18	200
F8.2020	20	15,6	20	150
F8.2025	25	20	25	100
F8.2032	32	25	32	100
F8.2040	40	32	40	100
F8.2050	50	41	50	100
F8.2063	63	54	63	50

TÜNEL KALIP, DUVAR VE TAVAN KASA BUATLARI (HALOJEN FREE) - TUNNEL MOLD, WALL AND CEILING CASE BOXES (HALOGEN FREE)

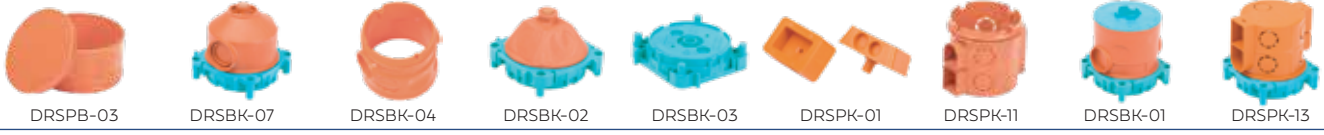

DRSPB-03

DRSBK-07

DRSBK-04

DRSBK-02

DRSBK-03

DRSPK-01

DRSPK-11

DRSBK-01

DRSPK-13

**Kullanım Alanları**

Her türlü elektrik tesisatında, mekanik zorlamanın olduğu yerlerde, bina ve prefabrik yapılarda, sıvaaltı, beton içerisinde, alçıpan duvar ve asma tavan içerisinde, tünel kalıp uygulamalarında kullanılabilir.

KOD - CODE	ÜRÜN - PRODUCT	PAKET - PACKAGE	AMBALAJ - PACKAGING
FLX-DRSPB-03	Tünel Beton Buat Türüncü	100	1.000
FLX-DRSBK-01	Buat Kasası Komple	100	500
FLX-DRSBK-02	Tavan Askı Kasası	100	1.000
FLX-DRSBK-03	Kalıba Tespit Elemanı	100	1.000
FLX-DRSBK-04	Buat Gövde 60mm Türüncü	100	1.000
FLX-DRSBK-05	Buat Arka Kapak	100	1.000
FLX-DRSBK-07	Tavan Askı Kasası Derin Gövde	100	1.000
FLX-DRSPK-13	Tespitli Geçmeli Derin Tünel Kasası (Deliksiz)	100	1.000
FLX-DRSPK-11	Geçmeli Derin Kasa Türüncü	100	1.000

TUĞLA, DUVAR KASA BUATLARI (HALOJEN FREE) - TUNNEL MOLD, WALL AND CEILING CASE BOXES (HALOGEN FREE)



DRSPB-75

DRSPP-75K

DRSPK-09Y

DRSLKS-01

DRSPK-01

DRSPK-13Y

DRSPK-06Y

DRSPK-06YK

**Kullanım Alanları**

Her türlü elektrik tesisatında, mekanik zorlamanın olduğu yerlere, bina ve prefabrik yapılara, sıvaaltı, beton içerisinde, alçıpan duvar ve asma tavan içerisinde, alçıpan duvar ve asma tavan içerisinde, tünel kalıp uygulamalarında kullanılabilir.

KOD - CODE	ÜRÜN - PRODUCT	PAKET - PACKAGE	AMBALAJ - PACKAGING
FLX-DRSPK-13Y	Tespitli Geçmeli Derin Tünel Kasası (Deliksiz)	100	1.000
FLX-DRSPK-06Y	Çift Girişli Yeni Tip Geçmeli Kasa Türüncü	100	500
FLX-DRSPK-06YK	Çift Girişli Yeni Tip Geçmeli Kasa Kapaklı Türüncü	100	1.000
FLX-DRSPK-01	Plastik Takoz 16-20mm Türüncü	100	1.000
FLX-DRSPK-09Y	Geçmeli Tip Alçıpan Kasa Türüncü	100	1.000
FLX-DRSPB-75	Norm Buat Türüncü (Kapaklı)	100	1.000
FLX-DRSPP-75K	Norm Buat Türüncü (Kapaklı)	100	1.000
FLX-DRSLKS-01	Bombeli Lüks Buat Kapağı	100	1.000

TUĞLA, DUVAR KASA BUATLARI (HALOJEN FREE) - TUNNEL MOLD, WALL AND CEILING CASE BOXES (HALOGEN FREE)



DRSPK-09YS

DRSPK-01S

DRSPK-06YS

DRSPB-05KS

DRSPB-05S

**Kullanım Alanları**

Her türlü elektrik tesisatında, mekanik zorlamanın olduğu yerlere, bina ve prefabrik yapılarda, sıvaaltı, beton içerisinde, alçıpan duvar ve asma tavan içerisinde, tünel kalıp uygulamalarında kullanılabilir.

KOD - CODE	ÜRÜN - PRODUCT	PAKET - PACKAGE	AMBALAJ - PACKAGING
FLX-DRSPK-06YS	Çift Girişli Yeni Tip Geçmeli Kasa Siyah	100	1.000
FLX-DRSPK-06YKS	Çift Girişli Yeni Tip Geçmeli Kasa Kapaklı Siyah	100	500
FLX-DRSPK-09YS	Geçmeli Tip Alçıpan Kasa Siyah	100	1.000
FLX-DRSPK-01S	Plastik Takoz 16-20mm Siyah	100	1.000
FLX-DRSPB-05S	Norm Buat Siyah	100	1.000
FLX-DRSPB-05KS	Norm Buat Kapaklı Siyah	100	1.000
FLX-DRSPK-03S	Norm Kasa Siyah	100	1.000





# MAKARALAR

## CABLE REELS



KORUMA SINIFI  
PROTECTION CLASS

IP20

METAL MAKARA - METAL CABLE REEL GERMAN TYPE



KOD CODE	KABLO KESİTİ CABLE TYPE	KABLO MİKTARI CABLE AMOUNT	AMBALAJ MİKTARI PACKAING QUANTITY
FLX-M.31500	-	-	2 Adet / Pieces
FLX-M.31520	3x1,5 mm <sup>2</sup>	20 Mt.	2 Adet / Pieces
FLX-M.31535	3x1,5 mm <sup>2</sup>	35 Mt.	2 Adet / Pieces
FLX-M.31550	3x1,5 mm <sup>2</sup>	50 Mt.	2 Adet / Pieces
FLX-M.32520	3x2,5 mm <sup>2</sup>	20 Mt.	2 Adet / Pieces
FLX-M.32530	3x2,5 mm <sup>2</sup>	30 Mt.	2 Adet / Pieces
FLX-M.32540	3x2,5 mm <sup>2</sup>	40 Mt.	2 Adet / Pieces
FLX-M.32550	3x2,5 mm <sup>2</sup>	50 Mt.	2 Adet / Pieces

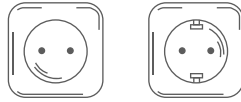

RENK - COLOR



GROUNDED

KORUMA SINIFI  
PROTECTION CLASS

IP20

PLASTİK MAKARA FRANSIZ TİPİ  
PLASTIC CABLE REEL FRENCH TYPE



KOD CODE	KABLO KESİTİ CABLE TYPE	KABLO MİKTARI CABLE AMOUNT	AMBALAJ MİKTARI PACKAING QUANTITY
FLX-F31500	-	-	2 Adet / Pieces
FLX-F31520	3x1,5 mm <sup>2</sup>	20 Mt.	2 Adet / Pieces
FLX-F31535	3x1,5 mm <sup>2</sup>	35 Mt.	2 Adet / Pieces
FLX-F31550	3x1,5 mm <sup>2</sup>	50 Mt.	2 Adet / Pieces
FLX-F32520	3x2,5 mm <sup>2</sup>	20 Mt.	2 Adet / Pieces
FLX-F32530	3x2,5 mm <sup>2</sup>	30 Mt.	2 Adet / Pieces
FLX-F32540	3x2,5 mm <sup>2</sup>	40 Mt.	2 Adet / Pieces
FLX-F32550	3x2,5 mm <sup>2</sup>	50 Mt.	2 Adet / Pieces



RENK - COLOR



KORUMA SINIFI  
PROTECTION CLASS

IP20

PLASTİK MAKARA İNGİLİZ TİPİ  
PLASTIC CABLE REEL UNIVERSAL TYPE



KOD CODE	KABLO KESİTİ CABLE TYPE	KABLO MİKTARI CABLE AMOUNT	AMBALAJ MİKTARI PACKAING QUANTITY
FLX-B.31500	-	-	2 Adet / Pieces
FLX-B.31520	3x1,5 mm <sup>2</sup>	20 Mt.	2 Adet / Pieces
FLX-B.31535	3x1,5 mm <sup>2</sup>	35 Mt.	2 Adet / Pieces
FLX-B.31550	3x1,5 mm <sup>2</sup>	50 Mt.	2 Adet / Pieces
FLX-B.32520	3x2,5 mm <sup>2</sup>	20 Mt.	2 Adet / Pieces
FLX-B.32530	3x2,5 mm <sup>2</sup>	30 Mt.	2 Adet / Pieces
FLX-B.32540	3x2,5 mm <sup>2</sup>	40 Mt.	2 Adet / Pieces
FLX-B.32550	3x2,5 mm <sup>2</sup>	50 Mt.	2 Adet / Pieces



RENK - COLOR



## METAL MAKARA - METAL CABLE REEL GERMAN TYPE



KOD CODE	KABLO KESİTİ CABLE TYPE	KABLO MİKTARI CABLE AMOUNT	AMBALAJ MİKTARI PACKAING QUANTITY
FLX-MM.31500	-	-	2 Adet / Pieces
FLX-MM.31520	3x1,5 mm <sup>2</sup>	20 Mt.	2 Adet / Pieces
FLX-MM.31535	3x1,5 mm <sup>2</sup>	35 Mt.	2 Adet / Pieces
FLX-MM.31550	3x1,5 mm <sup>2</sup>	50 Mt.	2 Adet / Pieces
FLX-MM.32520	3x2,5 mm <sup>2</sup>	20 Mt.	2 Adet / Pieces
FLX-MM.32530	3x2,5 mm <sup>2</sup>	30 Mt.	2 Adet / Pieces
FLX-MM.32540	3x2,5 mm <sup>2</sup>	40 Mt.	2 Adet / Pieces
FLX-MM.32550	3x2,5 mm <sup>2</sup>	50 Mt.	2 Adet / Pieces

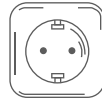

RENK - COLOR



Also produced with IP44 Protection Class Option.

## METAL MAKARA - METAL CABLE REEL UNIVERSAL TYPE



KOD CODE	KABLO KESİTİ CABLE TYPE	KABLO MİKTARI CABLE AMOUNT	AMBALAJ MİKTARI PACKAING QUANTITY
FLX-MB.31500	-	-	2 Adet / Pieces
FLX-MB.31520	3x1,5 mm <sup>2</sup>	20 Mt.	2 Adet / Pieces
FLX-MB.31535	3x1,5 mm <sup>2</sup>	35 Mt.	2 Adet / Pieces
FLX-MB.31550	3x1,5 mm <sup>2</sup>	50 Mt.	2 Adet / Pieces
FLX-MB.32520	3x2,5 mm <sup>2</sup>	20 Mt.	2 Adet / Pieces
FLX-MB.32530	3x2,5 mm <sup>2</sup>	30 Mt.	2 Adet / Pieces
FLX-MB.32540	3x2,5 mm <sup>2</sup>	40 Mt.	2 Adet / Pieces
FLX-MB.32550	3x2,5 mm <sup>2</sup>	50 Mt.	2 Adet / Pieces



RENK - COLOR



## METAL MAKARA FRANSIZ TİPİ METAL CABLE REEL FRENCH TYPE



KOD CODE	KABLO KESİTİ CABLE TYPE	KABLO MİKTARI CABLE AMOUNT	AMBALAJ MİKTARI PACKAING QUANTITY
FLX-MF31500	-	-	2 Adet / Pieces
FLX-MF31520	3x1,5 mm <sup>2</sup>	20 Mt.	2 Adet / Pieces
FLX-MF31535	3x1,5 mm <sup>2</sup>	35 Mt.	2 Adet / Pieces
FLX-MF31550	3x1,5 mm <sup>2</sup>	50 Mt.	2 Adet / Pieces
FLX-MF32520	3x2,5 mm <sup>2</sup>	20 Mt.	2 Adet / Pieces
FLX-MF32530	3x2,5 mm <sup>2</sup>	30 Mt.	2 Adet / Pieces
FLX-MF32540	3x2,5 mm <sup>2</sup>	40 Mt.	2 Adet / Pieces
FLX-MF32550	3x2,5 mm <sup>2</sup>	50 Mt.	2 Adet / Pieces



RENK - COLOR





KORUMA SINIFI  
PROTECTION CLASS

**IP20**

**MİNİ KABLO MAKARASI - MINI CABLE REELS**

KOD CODE	KABLO KESİTİ CABLE TYPE	KABLO MİKTARI CABLE AMOUNT	AMBALAJ MİKTARI PACKAING QUANTITY
FLX-M.31000	-	-	1X20 Adet / Pieces
FLX-M.31003	3x1 mm <sup>2</sup>	3 Mt.	1X20 Adet / Pieces
FLX-M.31005	3x1 mm <sup>2</sup>	5 Mt.	1X20 Adet / Pieces
FLX-M.31503	3x1,5 mm <sup>2</sup>	3 Mt.	1X20 Adet / Pieces
FLX-M.31505	3x1,5 mm <sup>2</sup>	5 Mt.	1X20 Adet / Pieces

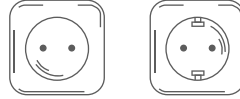

**RENK - COLOR**



KORUMA SINIFI  
PROTECTION CLASS

**IP20**

**MİNİ KABLO MAKARASI İNGİLİZ TİPİ**  
MINI CABLE REELS UNIVERSAL TYPE

KOD CODE	KABLO KESİTİ CABLE TYPE	KABLO MİKTARI CABLE AMOUNT	AMBALAJ MİKTARI PACKAING QUANTITY
FLX-B.31000	-	-	1X20 Adet / Pieces
FLX-B.31003	3x1 mm <sup>2</sup>	3 Mt.	1X20 Adet / Pieces
FLX-B.31005	3x1 mm <sup>2</sup>	5 Mt.	1X20 Adet / Pieces
FLX-B.31503	3x1,5 mm <sup>2</sup>	3 Mt.	1X20 Adet / Pieces
FLX-B.31505	3x1,5 mm <sup>2</sup>	5 Mt.	1X20 Adet / Pieces



**RENK - COLOR**



KORUMA SINIFI  
PROTECTION CLASS

**IP20**

**MİNİ KABLO MAKARASI FRANSTZ TİPİ**  
MINI CABLE REELS FRENCH TYPE

KOD CODE	KABLO KESİTİ CABLE TYPE	KABLO MİKTARI CABLE AMOUNT	AMBALAJ MİKTARI PACKAING QUANTITY
FLX-F31000	-	-	1X20 Adet / Pieces
FLX-F31003	3x1 mm <sup>2</sup>	3 Mt.	1X20 Adet / Pieces
FLX-F31005	3x1 mm <sup>2</sup>	5 Mt.	1X20 Adet / Pieces
FLX-F31503	3x1,5 mm <sup>2</sup>	3 Mt.	1X20 Adet / Pieces
FLX-F31505	3x1,5 mm <sup>2</sup>	5 Mt.	1X20 Adet / Pieces



**RENK - COLOR**





# KAUÇUK FİŞ PRİZLER

RUBBER PLUGS AND SOCKETS





**MONOFAZE 1/16 KAUÇUK DÜZ FİŞ - RUBBER PLUG STRONG**

**KOD - CODE** FLX.KFP001 | **KUTU - BOX** 240

1x16A

**RENK - COLOR**



Siyah - Black



**MONOFAZE 1/16 KAUÇUK SEYYAR PRİZ**  
RUBBER SOCKET MOBILE

**KOD - CODE** FLX.KFP002 | **KUTU - BOX** 120

1x16A

**RENK - COLOR**

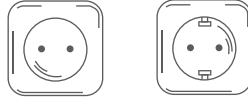

Siyah - Black



**MONOFAZE 1/16 KAUÇUK DUVAR PRİZ**  
GROUNDED RUBBER SOCKET(WALL)

**KOD - CODE** FLX.KFP003 | **KUTU - BOX** 120

1x16A

**RENK - COLOR**



Siyah - Black



**MONOFAZE 1/16 KAUÇUK İKİLİ GRUP PRİZ**  
GROUNDED RUBBER 2 GANG SOCKET

**KOD - CODE** FLX.KFP004 | **KUTU - BOX** 72

1x16A

**RENK - COLOR**

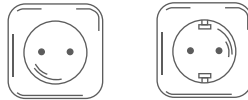

Siyah - Black



**MONOFAZE 1/16 KAUÇUK ÜÇLÜ GRUP PRİZ**  
GROUNDED RUBBER 3 GANG SOCKET

**KOD - CODE** FLX.KFP005 | **KUTU - BOX** 48

1x16A

**RENK - COLOR**



Siyah - Black



### UYGUNLUK SERTİFİKASI

#### ATTESTATION OF COMPLIANCE

<b>Belge No</b> Certificate Nr.	: S20-04
<b>Firmanın adı</b> Name and Address of the Company	: FLEKS ELEKTRİK MALZEMELERİ İTH.VE İHR.SAN.TİC.LTD.ŞTİ
<b>Adres</b> Address	: OSMANGAZI MAH.SEVİL SOK NO : 9 / 2 ESEN YURT/İSTANBUL - TÜRKİYE
<b>Ürün Adı</b> Product Name	: PVC İZOLELİ GALVANİZLİ ÇELİK SİRAL BORU ISOLATED GALVANISED STEEL FLEXIBEL CONDUIT
<b>Marka/Model/Tip</b> Mark/Model/Type	: F.02.1009 F.02.1011 F.02.1014 F.02.1016 F.02.1018 F.02.1021 F.02.1026 F.02.1029 F.02.1032 F.02.1035 F.02.1037 F.02.1040 F.02.1042 F.02.1045 F.02.1050 F.02.1063 F.02.1075 F.02.1100
<b>Referans Standart(lar)</b> Reference Standard(s)	: EN 61386-1, EN 50086-1
<b>Onay Dayanağı</b> Base of Attestation	: Teknik dokümantasyon, L-2018-012 no' lu Test raporu File of technical documentation, Test Report, Ref. No L-2018-012

The technical file and test report of the above product have been checked and found in compliance with 2014/35/EU, on October 2<sup>nd</sup> 2016 electrically designed for specific voltage limits regulation on equipment by European Union Technical Committee. It confirms that the listed equipment (not annex IV equipment) complies with the principal protection requirement of the directives.

Other relevant Directives have to be observed. With reference technical file of the product is considered to conform to the Internal Production Control of the above-mentioned EC Directive. This certificate does not abrogate the compulsory obligation of the manufacturer to issue the declaration of conformity and Compliance with the essential safety requirements

Teknik Dosya ve test raporları incelenerek, belirtilen ürünün Avrupa Birliği Teknik Komisyonu tarafından 2 Ekim 2006 tarihinde yayınlanan 2014/35/AB Belirli Gerilim Sınırları İçin Tasarlanan Elektrikli Ekipman ile İlgili Yönetmelik uygunluğu saptanmıştır. Listelenen teçhizatın (EK IV hariç) direktiflerin temel koruma şartlarına uygun olduğunu belirtir.

Diğer ilgili direktiflere uyumludur. Referans teknik dosya ile ürünün yukarıda belirtilen AT Direktifi iç üretim kontrollerine uygunluğu kabul edilir. Bu sertifika üreticinin uygunluk beyanı düzenleme ve Temel Gereklere uyum zorunluluğunu ortadan kaldırmaz.

<b>Sertifika Düzenleme Tarihi</b> Issue Date	: 28.12.2023
<b>Belge Geçerlilik Tarihi</b> Validity of the certificate	: 28.12.2024



Murat ŞAHİN  
Genel Müdür V.  
General Manager P.

STANDARD SERTİFİKASYON MUAYENE LABORATUVAR VE EĞİTİM HİZMETLERİ A.Ş.  
Güzelyurt Mahallesi 5775 Sokak No:34/A Yunusseme/ MANİSA  
TEL: +90 236 302 01 44; FAX: +90 236 302 01 43  
E-mail: standard@standarturk.com  
Web : www.standarturk.com



### UYGUNLUK SERTİFİKASI

#### ATTESTATION OF COMPLIANCE

<b>Belge No</b> Certificate Nr.	: S18-12
<b>Firmanın adı</b> Name and Address of the Company	: FLEKS ELEKTRİK MALZ.İTH.İHR. SAN.TİC. LTD. ŞTİ.
<b>Adres</b> Address	: OSMANGAZI MAH.SEVİL SOK NO : 9 / 2 ESEN YURT/İSTANBUL - TÜRKİYE
<b>Ürün Adı</b> Product Name	: GALVANİZLİ ÇELİK SİRAL BORU GALVANISED STEEL FLEXIBEL CONDUIT
<b>Marka/Model/Tip</b> Mark/Model/Type	: F.01.1009 F.01.1011 F.01.1014 F.01.1016 F.01.1018 F.01.1021 F.01.1026 F.01.1029 F.01.1032 F.01.1035 F.01.1037 F.01.1040 F.01.1042 F.01.1045 F.01.1050 F.01.1063 F.01.1075 F.01.1100
<b>Referans Standart(lar)</b> Reference Standard(s)	: EN 61386-1, EN 50086-1
<b>Onay Dayanağı</b> Base of Attestation	: Teknik dokümantasyon, L-2018-014 no' lu Test raporu File of technical documentation, Test Report, Ref. No L-2018-014

The technical file and test report of the above product have been checked and found in compliance with 2014/35/EU, on October 2<sup>nd</sup> 2016 electrically designed for specific voltage limits regulation on equipment by European Union Technical Committee. It confirms that the listed equipment (not annex IV equipment) complies with the principal protection requirement of the directives.

Other relevant Directives have to be observed. With reference technical file of the product is considered to conform to the Internal Production Control of the above-mentioned EC Directive. This certificate does not abrogate the compulsory obligation of the manufacturer to issue the declaration of conformity and Compliance with the essential safety requirements

Teknik Dosya ve test raporları incelenerek, belirtilen ürünün Avrupa Birliği Teknik Komisyonu tarafından 2 Ekim 2006 tarihinde yayınlanan 2014/35/AB Belirli Gerilim Sınırları İçin Tasarlanan Elektrikli Ekipman ile İlgili Yönetmelik uygunluğu saptanmıştır. Listelenen teçhizatın (EK IV hariç) direktiflerin temel koruma şartlarına uygun olduğunu belirtir.

Diğer ilgili direktiflere uyumludur. Referans teknik dosya ile ürünün yukarıda belirtilen AT Direktifi iç üretim kontrollerine uygunluğu kabul edilir. Bu sertifika üreticinin uygunluk beyanı düzenleme ve Temel Gereklere uyum zorunluluğunu ortadan kaldırmaz.

<b>Sertifika Düzenleme Tarihi</b> Issue Date	: 28.12.2023
<b>Belge Geçerlilik Tarihi</b> Validity of the certificate	: 28.12.2024



Murat ŞAHİN  
Genel Müdür V.  
General Manager P.

STANDARD SERTİFİKASYON MUAYENE LABORATUVAR VE EĞİTİM HİZMETLERİ A.Ş.  
Güzelyurt Mahallesi 5775 Sokak No:34/A Yunusseme/ MANİSA  
TEL: +90 236 302 01 44; FAX: +90 236 302 01 43  
E-mail: standard@standarturk.com  
Web : www.standarturk.com



### UYGUNLUK SERTİFİKASI

#### ATTESTATION OF COMPLIANCE

<b>Belge No</b> Certificate Nr.	: S18-14
<b>Firmanın adı</b> Name and Address of the Company	: FLEKS ELEKTRİK MALZ.İTH.İHR. SAN.TİC. LTD. ŞTİ.
<b>Adres</b> Address	: OSMANGAZI MAH.SEVİL SOK NO : 9 / 2 ESEN YURT/İSTANBUL - TÜRKİYE
<b>Ürün Adı</b> Product Name	: ÇELİK SİRAL BORU HALOGEN FREE INSULATED GALVANISED STEEL FLEXIBEL CONDUIT
<b>Marka/Model/Tip</b> Mark/Model/Type	: F.04.1009 F.04.1011 F.04.1014 F.04.1016 F.04.1018 F.04.1021 F.04.1026 F.04.1029 F.04.1032 F.04.1035 F.04.1037 F.04.1040 F.04.1042 F.04.1045 F.04.1050 F.04.1063 F.04.1075 F.04.1100
<b>Referans Standart(lar)</b> Reference Standard(s)	: EN 61386-1, EN 50086-1
<b>Onay Dayanağı</b> Base of Attestation	: Teknik dokümantasyon, L-2018-016 no' lu Test raporu File of technical documentation, Test Report, Ref. No L-2018-016

The technical file and test report of the above product have been checked and found in compliance with 2014/35/EU, on October 2<sup>nd</sup> 2016 electrically designed for specific voltage limits regulation on equipment by European Union Technical Committee. It confirms that the listed equipment (not annex IV equipment) complies with the principal protection requirement of the directives.

Other relevant Directives have to be observed. With reference technical file of the product is considered to conform to the Internal Production Control of the above-mentioned EC Directive. This certificate does not abrogate the compulsory obligation of the manufacturer to issue the declaration of conformity and Compliance with the essential safety requirements

Teknik Dosya ve test raporları incelenerek, belirtilen ürünün Avrupa Birliği Teknik Komisyonu tarafından 2 Ekim 2006 tarihinde yayınlanan 2014/35/AB Belirli Gerilim Sınırları İçin Tasarlanan Elektrikli Ekipman ile İlgili Yönetmelik uygunluğu saptanmıştır. Listelenen teçhizatın (EK IV hariç) direktiflerin temel koruma şartlarına uygun olduğunu belirtir.

Diğer ilgili direktiflere uyumludur. Referans teknik dosya ile ürünün yukarıda belirtilen AT Direktifi iç üretim kontrollerine uygunluğu kabul edilir. Bu sertifika üreticinin uygunluk beyanı düzenleme ve Temel Gereklere uyum zorunluluğunu ortadan kaldırmaz.

<b>Sertifika Düzenleme Tarihi</b> Issue Date	: 28.12.2023
<b>Belge Geçerlilik Tarihi</b> Validity of the certificate	: 28.12.2024



Murat ŞAHİN  
Genel Müdür V.  
General Manager P.

STANDARD SERTİFİKASYON MUAYENE LABORATUVAR VE EĞİTİM HİZMETLERİ A.Ş.  
Güzelyurt Mahallesi 5775 Sokak No:34/A Yunusseme/ MANİSA  
TEL: +90 236 302 01 44; FAX: +90 236 302 01 43  
E-mail: standard@standarturk.com / Web : www.standarturk.com









## FLEKS ELEKTRİK MALZEMELERİ İTHALAT VE İHRACAT SAN. TİC. LTD. ŞTİ.

📍 Osmangazi Mahallesi, Sevil Sokak, No:9/2  
Esenyurt / İstanbul, TR

☎ +0212 596 00 97

✉ info@fleks.com.tr

🌐 www.fleks.com.tr

